

C.S. File No. 3/23 I. S. Weaver- T 29 S R 4 W Sec. 20, 21, 16, 17, 9- D.L.C. 39

Sec. and D.L.C. lines- W. H. Wood Sur.- W. S. Crear Chain- Corners Rec. pg. 123-  
pg. 229 Vol. 3 Loose Leaf Nov. 1925

Survey for

Chain C.S. cream  
a.c. Redifer

P R Harper  
P R Harper  
G.M. Dyer  
W.H. McClain  
W.O. Safford

(1)  
all present

Nov 3-4-5-6/25

at the corner to 16-17-20-21 top 29 SR 4x  
I find 2 trees standing + stump of 3rd that  
approximate very closely the bearing + distances given  
in the field notes being some doubt in my mind  
I go to the West corner on north line  
of Hans Harve D.L.C. 39 and run South  
3 ch on West Boy said claim to see since  
Thence I run West 5.75 ch and intersect  
the point where above established Temp.  
corner Mr McClain states that this is  
the point where corner used to be. After  
checking the other measurements given to  
this corner in field notes of D.L.C. 39  
and finding them checking closely I locate  
the corner at this point set an Iron Pin

1" x 3/4" and mark following B.T.A  
N 12° 10' E 38 L A R F 8" - S 14 - C.S. B.T.  
S 67° 30' E 33 L " " " 10 - S 21 - C.S. B.T.  
S 76° 15' W 93 L " " " 18 - S 20 - C.S. B.T.  
N 72° W 1.18 L " " " 12 - S 17 - C.S. B.T.

C.S. File No 3/23

Reestablished on to 16-17-20-21

B.T.A. set

Thence from the Cor to 16-17-20-21  
as established I run N 0° 30' E on random line

20.00 set T.P. (Correct N 1.42 W + 11 E)  
42.84 + 0.27 East to reestablished

1/4 Cor to 16+17 - Here S 40° E 33 L find small  
properly marked + S 25 E 5 L find traces of stump  
Set 4x4x2' L" corner post scrub 1/4 16-17 C.S.  
and Mark a R Fir 15" S 43° 30' E 50 L - 1/2 3.16 - C.S.

I continue N 0° 30' E from the 1/4 cor

20.00 T.P. correct south 3.25  
west 1.25  
33.49 and W 2.27 to N.W. cor

See 16 as reestablished. here find the  
bearing trees verify location of corner  
but are all rotten or down so Mark new trees

- a Fir 17" N 48° 30' W 28 L scrub S.E. BT, C.S.
- " " 12" S 9° 00' W 34 L " S. 17 BT C.S.
- " " 10" S 44° E 43 L " S. 16 BT C.S.
- " " 9" N 19° E 40 L " S. 9 BT C.S.

I retrace this line from cor to 16-17-20-21

By Solar N 0° 50' E 21.42 set I.P. 1/16 cor  
" 42.84 to 1/4 cor  
N 3° 24' W 16.75 set I.P. 1/16 cor  
" 33.49 to N.W. cor See 16

OS 3/23

Reestablish 1/4 cor  
See 16+17

N.W. Cor Sec 16



D.L.C. 39 Hans Haver

At the N.W. corner to this claim

I find the B.T.s and corner tree in place

The corner tree being partially burned I  
drive an iron pin in stump for corner

The bearing tree S 40 W 27 L is perfectly marked

" " " S 10 E 34 L had no visible

marks so I renewed it by cutting it

Ch. 39

B.T. C.S.

Thence I run south from cor

3.00 ch. from where I run N 89° 32' W 3.32 ch

to corner to 16-17-21-22

10.00 ch to N.W. interior corner of claim

At the N.W. interior corner I find stump of

old BT S 88 W 74 L also all tied to sec cor to

16-17-20-21 checking I reestablish the cor.

by driving a 18" x 2" iron pipe set over B.T.s as  
land has been cleared

1 Thence N 89° 36' W 5.25 (intersect sec line 20-21

S 1° 17' W 7.10 from cor to 16-17-20-21)

30.11 to N.W. cor as reestablished

at N.W. cor (in sec 20) I find both B.T.s

but are dead and in perishing condition

I set 3x3 oak stakes south D.L.C. 39 C.S. and

S 16 W 20 L 17" - 18" - 19" D.L.C. 39 B.T.

S 61 E 19 L " 18" - 19" D.L.C. 39 B.T.

CJ 3/23

N.W. cor in sec 20

N.W. interior cor in sec 21

N.W. cor in sec 20

For the Hearer Survey

Line between J S Hearer + W H McClain

Donation Claim Hams Hearer also Secs 16 + 7

M. J. Dyer W H M H A

W. D. Swoffard Homestead

~~Sarah J. Falter to P. P. Weom~~

Sarah J. Falter to P. P. Weom

Beginning at a point 16  $\frac{33}{100}$  chains east of section corner between sections 14+15, T29, R.5, thence east 22  $\frac{68}{100}$  chains, thence south 8  $\frac{32}{100}$ , thence west 21  $\frac{92}{100}$  chains, thence north  $5\frac{1}{4}^{\circ}$  west 8  $\frac{35}{100}$  chains to point of beginning.

A.M. Daily to P. P. Weom.

Beginning at a point 16.33 ch. east of  $\frac{1}{4}$  section corner between sections 14+15 T29, R5, thence east 22.68 ch, thence north 5 ch, thence west 23.14 ch, thence south  $5\frac{1}{4}^{\circ}$  east 5.02 ch to point of beginning.

Set 1" Iron Pipe  
36" Pine N 45E 143L  
6" Lamin S 85E 28L  
10" " N 56 1/2 W 141L  
36" Fir strip original  
S 47 1/2 W 32 1/2 L

N betw 22-23 - 80 set part - 14-15-22-23

Red fir	24"	S 45W	32 lbs
Pine	24	N 35W	66 "
Oak	8	S 60E	109 "
"	6	N 5E	95 "

North betw 14+15

40 part from which B Oak 7" N 10° W 25 lbs  
" " 15 W 55° E 77 "

80 part on 14-11-14-15

B Oak	8"	S 15 E	130 lbs
"	15	N 45° E	209 "
"	8	S 80 W	450 "
"	8	N 20 W	440 "

Dead Difference

Vol. 76-537

77-450

29-5

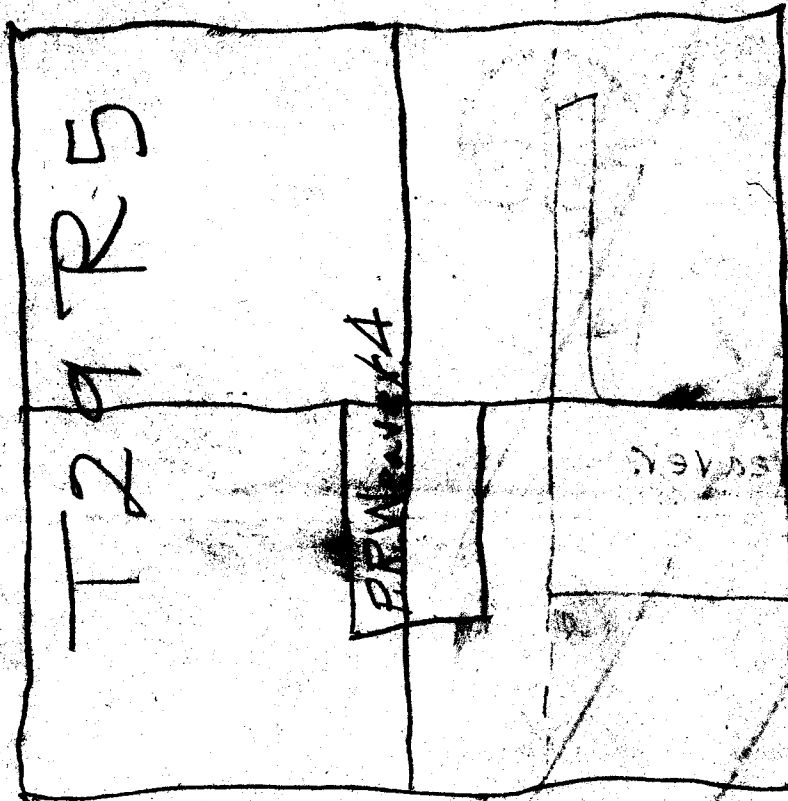

T29 S R 5 N. line Betwees. 16 and 21

East on Random line betwees. 16 and 21  
80.10 Intersect 42 lbs south of cor.

---

8941' N on true line Betwees 16 and 21  
40.05 Set 1/4 sec post. from which  
Pine 4" dia Bears S. 45° E 75 lbs.  
" 24 " " N 40° W. 254 "

---

80.10 sec cor. 16-15-21-22

Pine 8" dia bears. N 55° W 160 lbs.  
" 10" " " S 0° W 76 "  
B Oak 10" " " S 45° E 325 "  
Red Fir 30" " " N 18° E 280

---

Sec. Cor 16-17-20-21

Pine 36" dia bears, N 45° E. 84 lbs  
" 36 " " S 78° W 360 "  
" 20 " " N 12° W 214  
Laurel 14 " " S 8° E 285

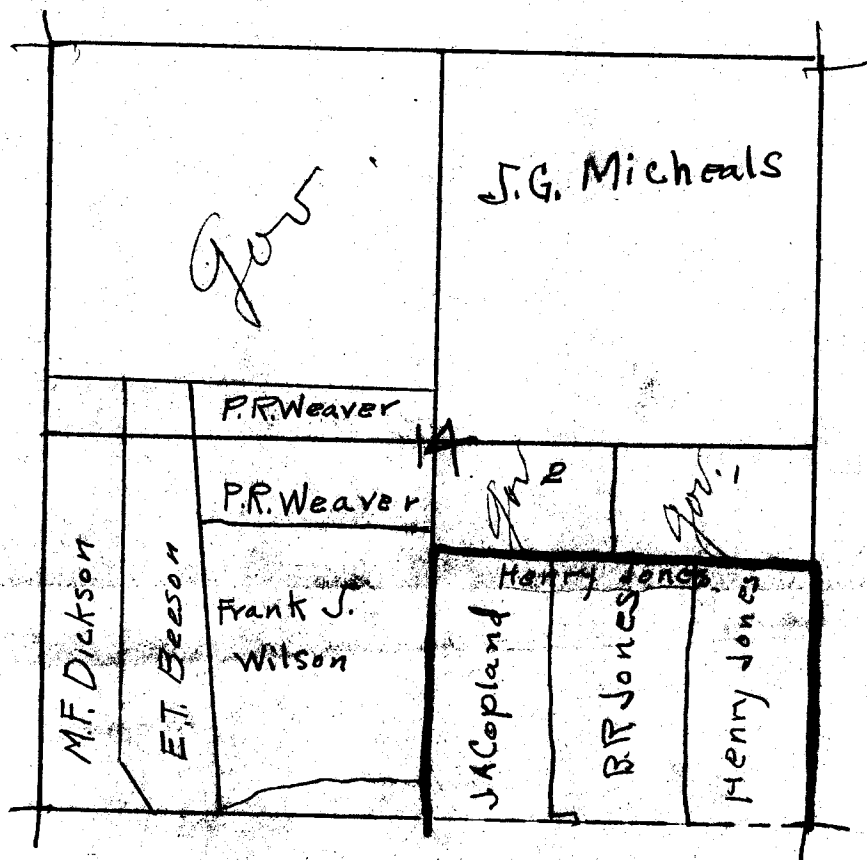

Oct. 25, 1925

Mr. P. R. Weaver  
Myrtle Creek, Oregon

Dear Sir-

In regard to your survey of a tract of land in the center of Section 14, I or my deputy will be at Myrtle Creek on the 29th of this month to do a survey up Myrtle Creek and will get to your place some day during the latter part of the week.

Sincerely yours

H. L. Epstein  
County Surveyor