

Lat  $43^{\circ} 13' 30''$

2-28

See out  $\frac{1}{2}$

10. A.M.

Rec

$$\begin{array}{r}
 11^{\circ} 45.7 \\
 \underline{5.2} \\
 11^{\circ} 40.5
 \end{array}$$

Sin  $11^{\circ} 50' 19'' = 9.312093$

$43^{\circ} 13' 30'' = 0.137470$   
 $28^{\circ} 41' 15'' = 0.086100$   
 $9.606470$   
 $= 32078$

Tan =  $9.973074$   
 "  $9.738146$   
 $9.711220$

~~$116^{\circ} 04' 30''$   
 $33^{\circ} 23' 30''$   
 $583^{\circ} 23' 30''$~~  
 True Plan

~~$5160$   
 $32078$   
 $10300$~~  
 COA =  $533^{\circ} 46' E$

Sin  $11^{\circ} 50' 19'' = 1.312093$

CO  $43^{\circ} 13' 30'' = 0.137470$   
 $28^{\circ} 48' 15'' = 0.086091$   
 $9.507654$   
 $= 32185$

Tan  $9.973074$   
 "  $9.745336$   
 $9.716300$

~~$116^{\circ} 01' 30''$   
 $32^{\circ} 37' 30''$   
 $583^{\circ} 23' 30''$~~  
 True Plan

~~$57038$   
 $32185$   
 $10300$~~  
 COA =  $532^{\circ} 37' 30'' E$

Set hub in Road West  
Car Road Bear N 6° 10' E

83° 49' W - 600' 56° W S 6° 11' W  
3'

1036 R 315' 57 1/2 W S 7° 47' W

A Tie 35 West  
To hub fence line

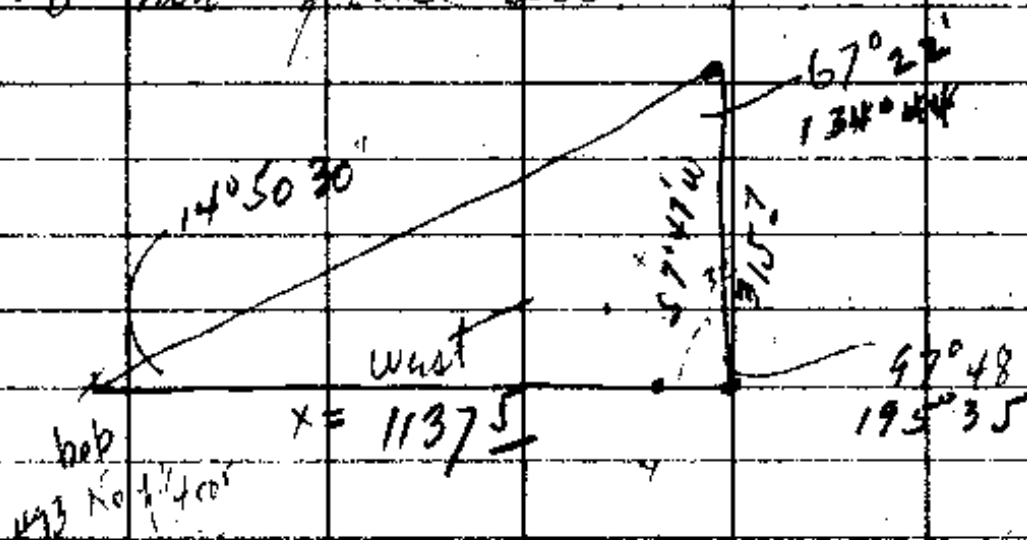

side  
No. 200 acres E.D.K. Cooper  
Bureau

Melrose

Road runs 2115 ft N 1/6° 10' E from  
corner

Tie for Angles

50° 11' W

~~Set of site P~~

2° 45' W

83° 55' R

N 10° 50' W

70 hula

H.A

V.A

50° 50' 6"

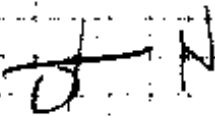

116° 39'

28° 54'

avg = 116° 44' 30" = 28° 41' 15"

58° 30' W

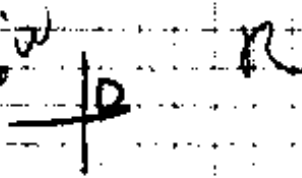

116° 50'

28° 52'

7° 10' W



115° 53' Left

28° 40'

116° 01'

avg = 28° 38' 15"

58° 54' W

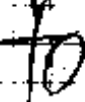

116° 09'

29° 20'

SUN S 34° E BRUNN

10 A.M. Friday 24<sup>th</sup>

Set Q site R

~~Handwritten mark~~

4036' L  
~~5022' L~~

N 83° 37' W

1/4 cor. as set

N 88° W N 88° 15' W

91° 48' L 16" v

287° = 275°

South 50° 01' E

0°

2°

$\frac{1159}{116}$

6" v

128° = 127°

7°

219° = 217°

736°

8°

211°

208°

6 40

217°

216°

1161.7

258°

Set JK Marked

8" W.O

S 38° 45' E

55° 1/2

TH

90° 01' R 5" v

232°

West

West

231°

0°

1" v

255°

= 255°

4" v

173°

173°

50°

50°

5 1/4

300

298°

4 3/4

300

299°

57°

53°

Cor. on Fence west side Co. Road

Start ~~at~~ 3' East from Top Cor.

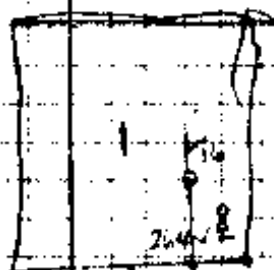

K		5 <sup>4</sup> / <sub>10</sub>	300°		N 167° 36' E
12° 35'	111 57' R	-	184°	S 1° E	S 0° 37' E
L	old hub				
	2° 34' R	3°	239 <sup>7</sup> / <sub>1</sub>	S 1 1/2° W	S 1° 37' W
117					
	3° 35' W	4 3/4	300° 95° 75° 150°	S 2° E	S 1° 38' E
1/16 corr.	3 P. Set				
	88° 26' R	15°	169 <sup>1</sup> / <sub>1</sub>	S 87° W	S 86° 28' W
M					
	2° 36' L	18 <sup>25</sup> / <sub>1</sub>	113°	S 84° W	S 84° 02' W
O					
	0° 28' R	4 3/4	111 <sup>9</sup> / <sub>1</sub>		S 84° 30' W
P					
	1° 02' R	5°	138 <sup>9</sup> / <sub>1</sub>	S 85° W	S 85° 32' W
Q					
	2° 06' W	4 1/2	104 <sup>5</sup> / <sub>1</sub>	S 83° W	Solar S 83° 23' W
R					
	11° 31' R	16 1/2	171 <sup>6</sup> / <sub>1</sub>	N 85 1/2° W	N 85° 06' W
S					
	0° 06' R	9 1/2	170°		N 85° W
T					
	1° 23' R	11 1/4	230 <sup>4</sup> / <sub>1</sub>	N 84° W	N 83° 37' W
U					

54  
129  
171

~~54~~

N 72° 40' E

H.

D° 12' R

2 3/4°

914 8  
719 8

N 89° E

N 88° 52' E

Gr. West by James Road

Ties. 162° 50' R

106 2

S 71° W

S 71° 42' W

Cor. Fence. Co Road (K Road) bears S 50° W

Tie

80

S 25° E

Cor. Fence. Ho Road ±

35° 0' W

751 6

N 53° 29' E

N 53° 52' E

H

Tie

600

S 30° W

Cor. Fence

15° 50' R

588 6

N 69° 2' E

N 69° 42' E

J.

Tie 18° 48' 37" S W cor <sup>no fence</sup> Co. Road R.W.

→ check

18° 48' R

1 1/2°

600

N 88° E

N 88° 30' E

J is cor on R.W.

↓ 20° 54' W

5°

700  
83 1/2

N 67° 06' E

K. In hub, my previous survey for

School (on No Side Road) 1/16 cor.

50

700

83 1/2

Tie South

390

Cor. R.W.

1054 A.M. Oct 23

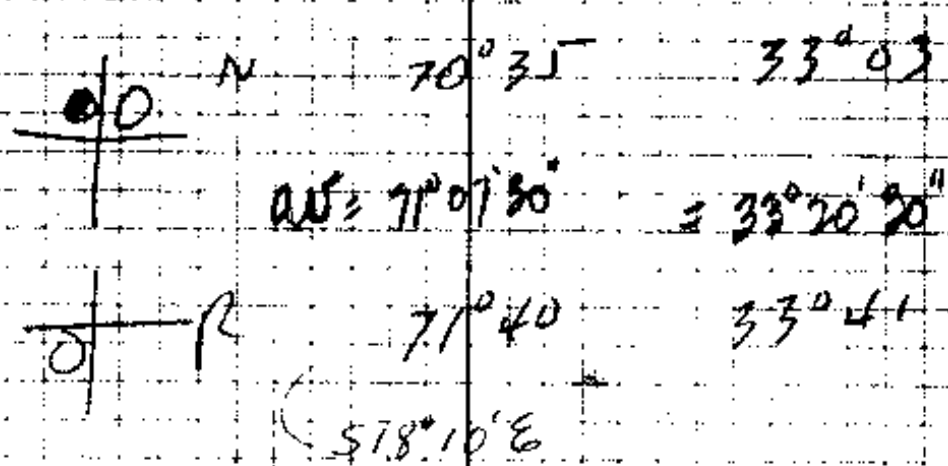
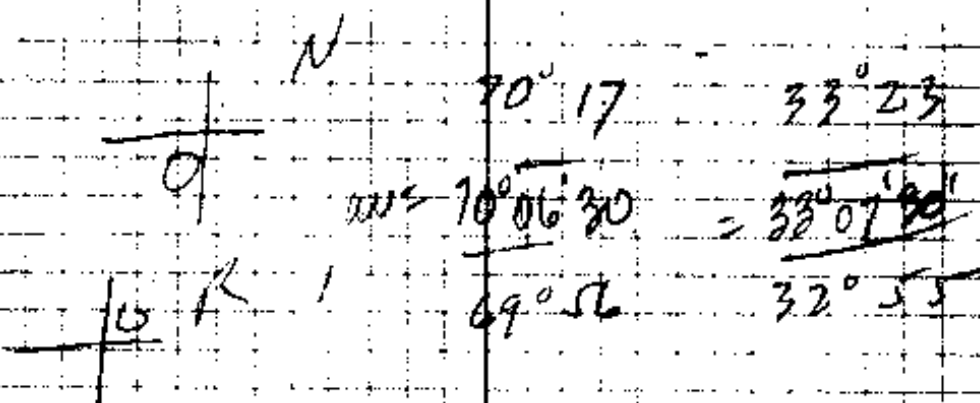

pole East from Pt. to Sun

Dec = 11° 30' 15"	9.299800		
lat 43° 13' 30"	0.137470	Tan	9.973074
Coly cos = 3° 07' 30"	0.977023	Tan	9.811690
	9.514293		9.787664
	= 92681		61329
		S 19° 55' E	32681
		N 89° 58' 30" E	0.94010
11° 30'	9.299800		9.973074
	0.137470		
33° 20' 30'	0.978101		9.818172
	9.515371		9.791246
	32764		
		S 18° 55' E	61837
		N 89° 57' 30" E	32764
			94601

B					N 78° 53' E
	8' 24" W	4' W	171°	N 70° E	N 70° 29' E
C		4' W	300°		
			474°		
C					
Tie	14° 35' R		44°	N 85° E	N 85° 04' E
For	sandstone 8 x 12 x 18" for				
	L cor. Ch. 42				
	Set from old wood + old B.T.s				
	rotted out. Marked.				
	36" W. O	33°	N 15° W		
C					70° 29' E
	69° 21' W		600°	N	N 1° 08' E
D					
	0'		882°		N 1° 08' E
By Road					
Tie			6°	Ely	East.
	To white hub previous corner set fence line				
initial,	0		19°		
E.					
	87° 32' R		422°	N 88° 2' E	N 88° 40' E
Tie	60° 30' R		440°		S 31° E
	C.O.P. Fence				
	7° R		75°		S 81° 30' E
	Fence				

SW So. y Sec 31

36° Top Ridge

40° " 15" B.O. N 84° W 13  
13" B.O. S 12° E 16

53 Prairie

76° Top Spur

81.9° Top Cor.

Resurvey

29-30-31-32

Rest.

1/4 mile survey

1/16 cor. So. y 29-30-31-32 set  
set alone 42" x 48" x 6 20 ch. 20 ch. 20 ch. 20 ch.

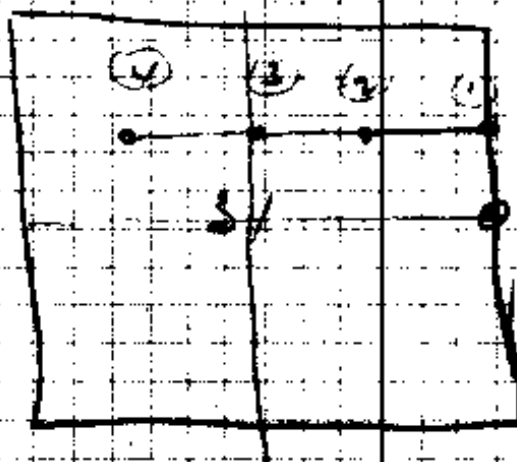

3 post  
8' Laurel 11/16" x 6  
24 ch.

set of one

as to

4 Bar

SLR 18730  
NOV 10 2 1/2



2741

2763

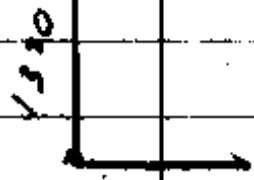

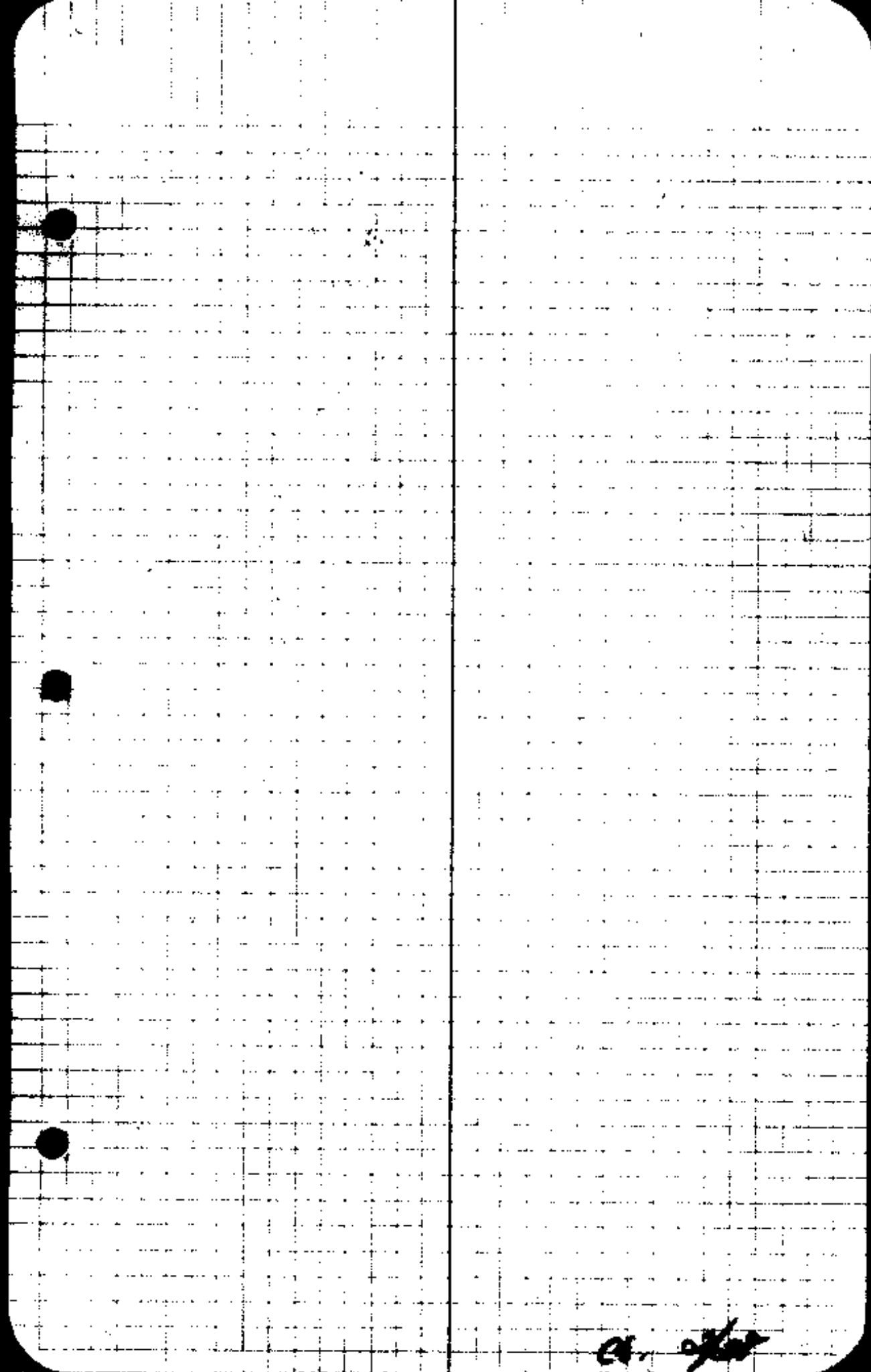

21. 9/22

Cooper T 27S R 7W  
Lat 43° 13' 30"

7 on W of Sec 6 27S R 6W  
D<sup>1</sup> Leave Cr

Set up P for 6 & 7

- 6" oak S 63° E 22
- 12" oak S 55 1/2° W 87
- 11" B.O. N 11° W 95
- 14 " N 14° 30' E 135

40° 1/4 13" W.O. S 52 1/2° W 35  
 12 " S 51° E 84  
 or 57°

73° 28" B.O. 77 1/2° Enter frame  
 82 5/10 Top cor.

More west of 7

- 17 5/10 Top spur
- 40° 1/4 10" B.O. S 38° E 29
- 12" " S 54 1/2° W 30
- 62 5/10 Top and west slope here
- 78 25/10 foot steep here
- 79 7/10 stream to channel & E
- 80 0 cor in stream,

Cor 11-12-13-14

12" oak  $\nearrow 120^\circ E$  87  
30" B.O.  $\nearrow 85^\circ W$  1015  
15" W.O.  $\searrow 70^\circ E$  289  
9" "  $\searrow 21^\circ W$  212

Opposite bet 12 & 13

30"  $\searrow$  from stream 3220 stream C D  
3320 from stream  
3998  $\searrow$  25" W.O.  $\searrow 70^\circ E$  154  
9" "  $\nearrow 80^\circ W$  181  
7996  $\searrow$  W.O.

77 bet 11 & 12

3"  $\searrow$  into field  
25 + 3500 stream NE  
40"  $\searrow$  12" W.O.  $\searrow 25^\circ W$  103  
6" "  $\nearrow 52^\circ W$  257  
5825 road. 950 top hill  
80. cor 1-2-11-12 dep stones bench  
E.W.  $\searrow$  from house  $\nearrow 78^\circ E$   
-  $\searrow$  from house  $\nearrow 15^\circ E$

74 bet 11 & 14 3989

7" W.O.  $\searrow 30^\circ E$  46  
40" "  $\nearrow 58^\circ E$  85

74 bet 11 20" B.O.  $\searrow 85^\circ W$  992  
12" B.O.  $\nearrow 71^\circ W$  1043

Cooper Survey

Start 1/4 cor Bet 11+12.

Found One C.B.T. OK. - 1 stump

Drove L. Pipe Marked.

18" W.O N 84° W 60'

6" W.O S 29 1/2° W 50'

21° 15'

th

N 0° 01' E

493°

set oak hub

son

90' h

227°

west

589° 59' W

A-

239 1/2

1213'

Set STK in fence line

start A.

head

55° 29' R

A

900°

N 34 1/2° W

N 34° 32' W

29° 25' L

200°

N 64° W

N 63° 57' W

320°

MW cor road Old fence corner

set A. 113° 25' R

=

200°

N 79° E

N 78° 53' E

300  
291

CS FILE FOLDER

CONTAINS

MORE

INFORMATION