

Richard Peterson

165
16
190
63

Dec 19 T 23 R 9

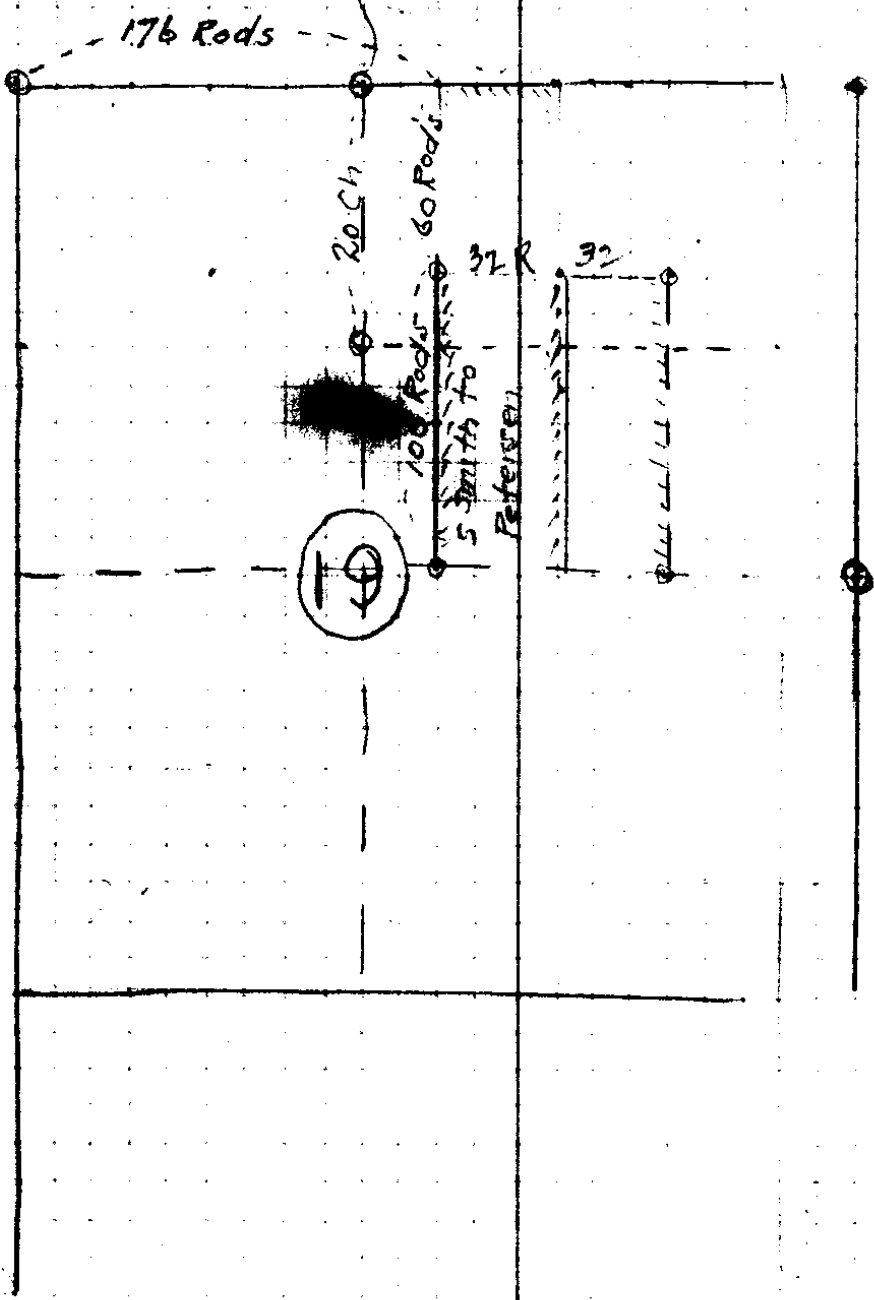

Survey for Dick Petersen.

Began at 1/4 Cor. N Side Sec 19
 Found 18th Fir marked for Cor
 Scribble Marks Visible

F.S. South Var 21° 45' E

0	R 2° 20'			-15° 30'	
	17° 19'	S 2° 20' W	S 2° 04' W	50.9	493
# 1	L 8° 40'			-22° 30'	
	12° 45'	S 7° 00' E	S 6° 36' E	183.8	169.8
# 2	R 6° 21'			-18° 20'	
		South	S 0° 14' E	52.2	495
# 3	0° 00'			-18° 30'	
	2° 30'	"	S 0° 14' E	36.3	344
# 4	R 1° 15'			-18° 00'	
	2° 25'	S 1° 20' W	S 1° 01' W	219.0	208.2
# 5	R 1° 11'			-19° 00'	
	4° 08'	S 2° 45' W	S 2° 13' W	286.1	270.4
# 6	L 2° 06'			-9° 30'	
	0° 12'	S 0° 30' W	S 0° 09' W	148.9	146.8
# 7	L 0° 22'				
	180° 02'	S 0° 15' W	S 0° 12' E		62.8
# 8	L 90° 01'				
	180° 00'	East	N 89° 05' E	202.5	
# 10'	R 90° 00'			61.5	
		South	S 0° 13' E	171.5	170.4

(Cor)
#10

#11 0° 00'

South.

1246

#12 15° 30'
L 7° 45'

S 7° 20' E S 7° 45' E

95°

#13 Root R 15° 30'

S 7° 45' W S 7° 45' W

95° 3

#14 17 38
L 8° 49'

S 0° 30' E S 1° 01' E

90°

#15 R 2° 08'

S 1° 00' W S 1° 04' W

90°

#16 L 1° 04'

South.

159°

#17 = 1/2 0° 00'

300°

300°

+4015
300°

299°

225°

225°

DW Cor. R.H. Peterson tract
Det Iron bar 1 1/4" □ also Cedar post
3x3x20"
Thence East. blazed line about 500 ft

Time 2:15 PM Tuesday Aug 21/23

Solar at #8 FS #7 $(551^{\circ}50W, 128^{\circ}22')$ Index + 0.01
 Alt $48^{\circ}06'$
 $552^{\circ}10W$ " $47^{\circ}00'$
 $126^{\circ}05$

Dec Greenwich Noon Aug 21 -- $12^{\circ}22' 46''$

Dec Aug 21 2:15 PM. $(12^{\circ}14' 00'')$

Lat = $43^{\circ}33'$

Alt = $48^{\circ}07'$

Sin $12^{\circ}14' = .2114$

Tan $43^{\circ}33' = .9506$

" $48^{\circ}07' = 1.1152$

19012
 47530
 9506
 9506
 9506
 1060 10912
 4369

.6232 = $551^{\circ}27W$
 $128^{\circ}22'$
 $179^{\circ}49'$
 $179^{\circ}60'$
 $N 0^{\circ}11W$

Cos $43^{\circ}33' = .7248$

" $48^{\circ}07' = .6676$

43488
 50736
 43488
 43488
 48387648

$4839 / 2114000 \quad 4369$
 19356
 17840
 14517
 33230
 29034

ZL 153

Tan $43^{\circ}33' = .9506$

" $47^{\circ}01' = 1.073$

28518
 66542
 9506

$553^{\circ}49W$
 $126^{\circ}05'$
 $179^{\circ}46'$
 $N 0^{\circ}11W$
 10149938
 4279
 5921

Cos = $.7248$

" $.6818$

59984
 7248

5798
 40488
 49416864

41960
 4280
 214400
 19768
 13720
 9844
 38360
 39536

Returned to Hub No 10 BS on 9
 near NW Cor. R. Petersen

#10	^{1°06'} L 0°33'			+9°45'	814	803
¹⁶⁰⁰ #A1.	2°12' R 1°06'	N 89°30'E				
¹⁶⁰⁶ #A2.	L 0°33'		S 89°15'E	+21°15'	863	803
²⁴⁴⁸ A3	0°00'			+21°46'	906	842
³⁸³⁶ A4.	0°00'	East.		+15°15'	1438	1388
⁴⁴³⁹ A5	0°00'			+1°45'	603	603
⁵⁰⁶⁶ A6	0°00'	East.		-18°00'	659	622
⁵⁷⁷⁸ A7	83°19' R 41°24'			-28°45'	1040	912
^{E 728'} A8.	L 61°10'		S 48°00'E	-21°50'	1745	1619
^{E 1056} A9. = NE Cor.			S 48°19'E			
					3478	
Dist at A8 BS7	0°47' R 0°24'		S 48°19'E			
			S 46°30'E	-2°15'	1092	1091
			S 47°55'E			

Get Iron Rod 1" O x 30" for Cor

5978 ✓

Wrong
E 130° S 116°

E 328° N 116° ✓

5731 E 81°

05/14

Cos
6648

Sin
7470

3335

9427

.6702

.7422

B1	$62^{\circ}53$ R $26^{\circ}26$	$S21^{\circ}45E$	$S21^{\circ}29E$	$\overline{280^{\circ}}$ 213.9	4939
B2	R $21^{\circ}29$	$S0^{\circ}20W$		300° 129.1	429.1
B3				+ $5^{\circ}20$ 265 - $39^{\circ}30$ 65.9 16.2	263.9 508 16.2
B4				+ $12^{\circ}20$ 120 + $7^{\circ}15$ 125	117.3 124.0
B5		East		$\overline{66^{\circ}}$	
D & Coy					

Check Line Det at B3 B5

⊙ B3	R $72^{\circ}29$	$S72^{\circ}20W$	$S72^{\circ}29W$	$\overline{297^{\circ}}$	
⊙	R $6^{\circ}45'$	$S79^{\circ}30$	$S79^{\circ}14W$	298.9	
⊙		$N76^{\circ}20W$	$N76^{\circ}20W$	299.3	
⊙	L $1^{\circ}40$	$N78^{\circ}W$	$N78^{\circ}W$	115.0	

34596 E 1809

{ Det. Hub. on line 66 ft East
{ Primer 10 ft East

In Lane E Side Petersens

Top of Cliff

Det Cedar Stake.

B4

5882 W 2835

5559 W 2940

7706 2910

7238 W 1125

Stubs on East side of place to be moved
East 94 ft from what we know here. Aug 25 1923
718 and 8 E Car to be moved South 84 ft also

as 1/2

