

Douglas County Surveyor's Record of
Government Corners Renewed

T. 32 S. T. S. R. 3 W. R. W. W. M.

KOKE-CHAPMAN CO., EUGENE, ORE. 21881

1/4 Corner to Sections 20 and 29.

85

Found - 15x8x5" Stone, firmly set, mkd: "1/4" on north face.

Orig. 18" now 24" D. Fir, S. 57°W. 19.1 ft., shows scar.

No trace of N.E. BT, logged unit.

Set - Brass Cap at Cor. Mkd: County Surveyor's Office, 1969
T 32 S R 3 W
1/4 S 20
S 29

New BT: 7" Yew N. 3° W. 39.7 ft. mkd: "1/4 S20 CS BT".

Reblzd. & Rescrbd: 24" D. Fir S. 57°W. 19.1 ft. mkd: "1/4 S29 CS BT".

1/4 Corner to Sections 3 and 4.

86

Found - 1" Iron Pipe at 1/4 Corner, See Ren. #12.

6", now 7" Yew, S. 44°W. 54.8 ft., scribe visible.

No trace of S.E. Bearing Tree.

Set - Brass Cap at Cor. Mkd: County Surveyor's Office, 1969
T 32 S R 3 W
1/4 S 4 | S 3

New BT: 4" D. Fir S. 15°E. 19.6 ft. mkd: "1/4 S 3 CS BT".

Fence Corner (fence running S. & W.) bears N. 71°E. 16.0 ft.

Section Corner to Sections 13 and 14 only.

87

Found - Orig. Corner & Markham's Ren. #17A which is a 1" Drill Steel by original corner stone.

Markham's rescribed tree stumps are now decaying and falling apart.

Orig. 14" D. Fir, now 12" stump, N. 18°W. 19.0 ft., shows scribd.

30" Hemlock, now stump, N. 7.8 ft., shows scribing.

13" W. Fir, now stump, South approx. 60 ft., shows scribing.

Because of the poor condition of this corner, we set Brass Cap.

Set - Brass Cap at Cor. Mkd: County Surveyor's Office, 1969
T 32 S R 3 W
S 14 | S 13
S 23

New BT: 5" Hemlock N. 83°W. 55.0 ft., mkd: "S14 CS BT".

New Bearing Objects:

Note: This cor. lies N. 50 ft. & S. 150 ft. of a logging road in logging unit.

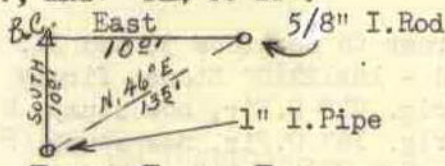

1/4 Corner to Sections 21 and 28.

88

Found - 14x8x6" Stone, firmly set mkd: "1/4" on north face.

14", now 28" D. Fir, N. 62°E. 27.1 ft., shows good scar.

14", now 21" D. Fir, S. 84°E. 60.1 ft., shows BT scar low on tree, upper part of tree, cat face.

Set - Brass Cap at Cor. Mkd: County Surveyor's Office, 1969
T 32 S R 3 W
S 21
S 28

New BT: 10" Pine S. 71°W. 9.8 ft. mkd: "1/4 S28 CS BT".

1/4 Corner to Sections 28 and 29.

89

Found - 7" Chinquapin Corner Tree, dead but standing, scribing visible.

6" D. Fir, now down, S. 75°E. 12.5 ft., scribe visible.

14", now 16" Pine, N. 53°W. 3.9 ft. (Rec. 5.9), shows good scar. Tree has dead top.

Set - Brass Cap at Cor. Mkd: County Surveyor's Office, 1969
T 32 S R 3 W
(Pushed Dead Cor. Tree over) 1/4 S 29 | S 28

New BT's: 17" D. Fir S. 87°E. 22.7 ft. mkd: "1/4 S28 CS BT".

20" Pine N. 4°W. 6.0 ft. mkd: "1/4 S29 CS BT".

1/4 Corner to Sections 17 and 18.

90

Found - 16x12x4" Stone, firmly set, mkd: "1/4" on west face.

48" Pine, now stump, S. 75°W. 40.9 ft.

12", now 21" D. Fir, N. 79°E. 26.4 ft., prev. opened, scribe visible.

Set - Brass Cap at Cor. Mkd: County Surveyor's Office, 1969
T 32 S R 3 W
1/4 S 18 | S 17

New BT: 6" Y. Pine N. 25°W. 39.1 ft. mkd: "1/4 S18 CS BT".

John M. Powell
Frank Jones & W. Penley
July, 1969 C. S. File No. 54/91