

Douglas County Surveyor's Record of
Government Corners Renewed

30 T. S. 9 R. W. W. M.

COKE-CHAPMAN CO., EUGENE, ORE. 21881

James W. Byron, Deputy
M. Godfrey
S. Bilow
July 18, 1958
C. S. File No. 49/100

1/4 Section Corner to Sections 11 & 14. 12
Found - Fir Stump, now 44" diam., N.24°E. 36.3 ft., showing good
BT. scar.
Incense Cedar, now 30" diam., S.58°E. 77.2 ft. (instead of
79.2 ft.) Chopped out lower blaze & found good scribing "BT".
Set Brass Cap at Corner Mkd: ~~S11~~ ^{#66}
1/4 S11 T30S R9W County Surveyor's Office, 1958.
Blaze & Scribe New BT's:
20" D. Fir S.42°E. 18.7 ft. mkd; "1/4 S14 CS BT."
6 1/2" W. Fir N.17 1/2°E. 13.7 ft. mkd; "1/4 S11 CS BT."

1/4 Section Corner to Sec. 2, T30S R9W. and Sec. 35, T29S R9W. 13
Found - Orig. 30", now 40", Fir N.67°E. 10.6 ft., shows good
bark scribing "S". Also shows good scar at base.
No trace of Orig. S. W. BT. found.
Set Brass Cap at Corner Mkd: 1/4 S35 T29S R9W County Surveyor's
S 2 T30S R9W Office, 1959.
New BT's: 8" W. Fir bears N.31°E. 16.9 ft. scribed 1/4 S35 CS BT.
15" R. Fir bears S.15°W. 37.8 ft. scribed 1/4 S 2 CS BT.

Fd. OK. 1/12/74 B. Shaner M49-51

Section Corner To Secs. 1 & 2, T30S R9W & Secs. 35 & 36, T29S R9W. 14
Found - Boyer's BT's., now Stumps, show scribing.
Set Corner from 12" Fir Stump N.42°W. 2.0 ft.
Set Brass Cap at Corner Mkd: S35 | S36 T29S R9W County Surveyor's
S 2 | S 1 T30S R9W Office, 1959
Note - Brass Cap Set in Concrete.
New BT: 23" Cedar bears S.66°E. 125.0 ft. scribed S 1 T30S R9W CS BT.

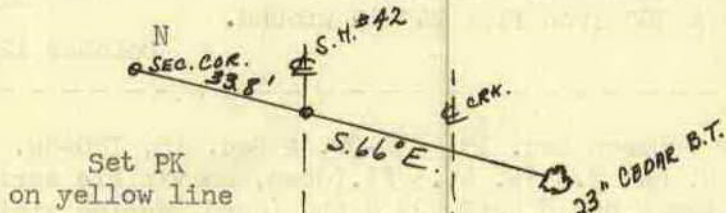

Fd. OK. 1/12/74
M49-51B. Shaner

Section Corner to Secs. 2 & 3, T30S R9W, and Secs. 34 & 35, T29S R9W. 15
Found - Orig. 6", now 12" Cedar, record S.54°E. 33.7 ft. I find
to be S.48°E. 22.7 ft., shows good scribing "39W S2".
Orig. 15", now 34" W. Fir S.51°W. 4.6 ft. I open & find
good scribing "BT". No trace of other BT's found.
Find scribed Stake at Corner.
Set Brass Cap alongside scribed Stake Mkd: S34 | S35 T29S R9W
County Surveyor's Office, 1959 S 3 | S 2 T30S R9W
New BT's: 16" W. Fir bears N.11°E. 24.3 ft. scribed S35 T29S R9W CS BT.
11" Cedar bears N.40°W. 29.3 ft. scribed S34 T29S R9W CS BT.

1/4 Section Corner to Sec. 34, T29S R9W, & Sec. 3, T30S R9W. 16
Found - Orig. 24", now 30" Fir Snag S.25°W. 26.4 ft. I open & find
good scribing "BT".
No trace of Original N. E. BT.
Set Brass Cap at Corner Mkd: County Surveyor's Office, 1959
1/4 S34 T29S R9W
S 3 T30S R9W
New BT's: 6" R. Fir bears N.28°E. 18.0 ft. scribed 1/4 S34 CS BT.
8" R. Fir bears S.10°W. 14.0 ft. scribed 1/4 S 3 CS BT.

1/4 Section Corner common to Sections 10 and 11. 17
Found - 36" Fir Stump with scribing N.42°E. 72.0 ft.
Set - 1" x 30" Iron Pipe
6" W. Fir S. 8°E. 13.4 ft.
14" D. Fir N.15 1/2°W. 86.5 ft.
RE-RENEWED, SEE CORNER NO. #130

James W. Byron, Deputy
Milo Godfrey
Clete E. Putnam
October 20, 1959
C. S. File No. 49/100

Howard W. Johnstone
For Rsbgr. Lumber
Jan. 4, 1961
C. S. File
No. 51/163