

Douglas County Surveyor's Record of
Government Corners Renewed

T 30 S. T. S. R 4 W. R. W. W. M.

KOKE-CHAPMAN CO., EUGENE, ORE. 21881

James W. Byron, Deputy Co. Surveyor
Dale McFarland & John Powell
December 27, 1961
C. S. File No. 49/67

Renewed Corner $\frac{S31}{S6} / \frac{S32}{S6}$ T29S R4W 164
T30S R4W

Found - All BT's. recorded by Barnhart, 1947. All now stumps.
We open N.W. BT. & find good scribing "9".

We do not find $1\frac{1}{4}$ " I. P. Set at Corner.

Set - Brass Cap at Cor. Mkd: County Surveyor's $\frac{S31/S32}{S6}$ T29S R4W
Office, 1961 T30S

Note - New Fence Corner Thus:

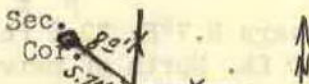

FD. BC. No BTs
7/179 G. BAUGHMAN
M7B-30

This area clear cut. One new BT. to S.W. only.

24" Laurel bears S. 58° W. 129.4 ft. scribed S 6 T30S R4W CS BT.

East West Logging Road 150 ft. North of Corner.

N. W. Corner to D. L. C. No. 39.

REN. # 111. 165

Found - Both BT's. as recorded by Markham, 1954, each shows scribing.
S. W. BT., now high cut Stump.

Iron Rod set for corner not found.

Set - Brass Cap at Cor. Mkd: County Surveyor's Office, 1961

New BT: 14" R. Fir bears S. 43° E. 77.7 ft. scribed N.W. CL 39 CS BT.

RE-RENEWED, SEE CORNER NO. #283
FIELD NOTES SAH
6/13/62 7/1/62 Z.R.

Wit. Cor. to $\frac{1}{4}$ Cor. Section 4 and 9.

166

510 ft. North of $\frac{1}{4}$ Cor. Sections 4 and 9, T30S R4W from which:

39" B. Oak bears N116 $\frac{1}{2}$ ° W. 139.8 ft. scribed W.C. $\frac{1}{4}$ S 4 CS BT.

32" B. Oak bears N. 65° E. 291.3 ft. scribed W.C. $\frac{1}{4}$ S 4 CS BT.

W.C. Mkd: Brass Cap 510' South to
 $\frac{1}{4}$ $\frac{S4}{S9}$ T30S R4W County Surveyor's
Office, 1962

Holes dug for new Prune Trees

Fd. $1\frac{1}{4}$ " I. P. 12"
above. We drive to
12" below.

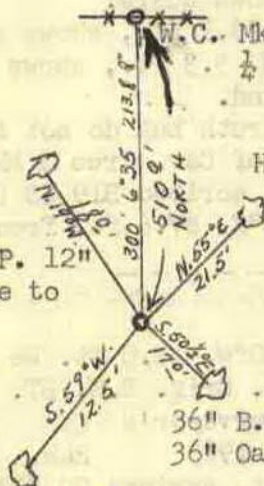

$\frac{1}{4}$ Corner $\frac{S4}{S9}$

36" B. Oak N. 9° W. 489.5 ft. scribed $\frac{1}{4}$ S CS.
36" Oak S. 85° W. 668.7 ft.

N. E. Corner D. L. C. No. 43.

167

Found - $\frac{1}{2}$ " I. R. at corner & at edge of black top, 1" under
surface. Fir BT. shows good bark scribing.

Maple BT. shows good scar. Both check record.

Oak BT. not found.

USBM Mkd: U499 bears S. 60° W. 33.8 ft.
1949

Township Corner R4W $\frac{S36}{S1} / \frac{S31}{S6}$ R3W T29S 168
T30S

Found - 4" x 4" x 6' scribed Cedar Post at Corner. - Ren. #42

14" B. Oak S. 84° W. 40.3 ft., shows rotted face.

12", now 16" R. Fir N. 53° E. 19.7 ft., shows good scar.

Other Bearing Trees not found.

Set - Brass Cap at Cor. Mkd: County Surveyor's Office 1962 $\frac{S36}{R4W} / \frac{S31}{S6}$ T29S
T30S

New BT's: 10" R. Fir bears N. 71° W. 38.0 ft. scribed S36 T29S R4W CS BT.

7" Cedar bears S. 55° W. 31.9 ft. scribed S1 CS BT.

No trees near to S. E.

Fence Corner Thus

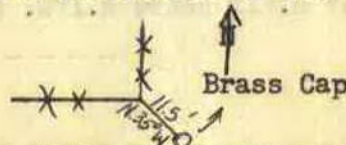

James W. Byron, Deputy
Dale McFarland & John Powell
February 1962
C. S. File No. 49/67

James W. Byron
Mike Darby &
Wm. Stoffel
November 1, 1962
C.S. File No. 52/126