

Douglas County Surveyor's Record of
Government Corners Renewed

T. 28 S. T. S. R. 7 W. R. W. W. M.

KOKE-CHAPMAN CO., EUGENE, ORE. 21881

1/4 Cor. to Sec. 35, T28-7W. & Sec. 2, T29-7W.

Found - Boyer's scribed stake at corner, down, & both BT's., thus:
12", now 12" R. Fir shows good scars N. 35° E. 2.5 ft.
15", now 19" R. Fir, shows good scar S. 45° E. 12.0 ft.

Set - Brass Cap at Cor. Mkd: County Surveyor's 1/4 S35 T28S R7W
Office, 1961 S 2 T29S

SEE # 22
INT 29-7

180

James W. Byron, Deputy
Milo E. Godfrey & C. Putnam
May & June 1961
C. S. File No. 49/50

1/4 Sec. Cor. to Sec. 1, T29-7W. & Sec. 36, T28-7W.

Found - Both BT's. recorded by Eppstein: 18", now 20" Fir Stump N E.
21 ft., shows good bark scribing "BT".
16", now 18" Fir Stump S. 47° W. 15.0 ft., shows old axe work.
Cut too low, no scribing found.

Set - Brass Cap at Cor. Mkd: County Surveyor's 1/4 S36 T28S R7W
Office, 1961 S 1 T29S

No trees near for Bearing Trees.

To Angle in Fence Corner located thus:

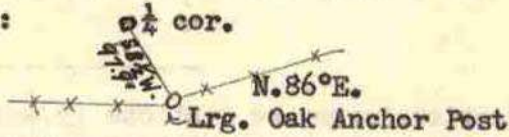

181

1/4 Corner to Sections 6 and 7.

See other Ren. by Boyer, Ren. #106.

Found - All old Bearing Trees down.
1" Pipe, previously set. - Added Steel Fence Post.
New BT's: 24" Fir N. 19° 30' W. 33.5 ft. Mkd: 1/4 S 6 1581 BT.
9" Fir S. 74° E. 18.4 ft. Mkd: 1/4 S 7 1581 BT.

1/16th Corner SE 1/16 to Sections 6 and 7.

Set - 1" I. Pipe, from which:
8" Fir N. 22° 30' E. 37 ft., scribed 1/16 S6 T28S R7W 1581 BT.

182

For W. V. Monger
By Arthur Boyer
Wit: Northcraft
Aug. 1965
C. S. File No. 51/317

Section Corner to Sections 8 - 9 - 16 - 17.

Found - GLO Brass Cap mkd. properly in 1924.
Orig. 7" B. Oak, now down, S. 63° E. 39.6 ft.
Orig. 15", now 36" Laurel, N. 65° E. 72.6 ft. (Bear. D. B. N. 63° E.)
Org. 18", now 32" Laurel N. 35° W. 57.4 ft.
Orig. 18" B. Oak, now down, S. 60° W. 5.3 ft.
23" D. Fir S. 44° E. 16.5 ft., shows good scar.
24" D. Fir S. 82° W. 27.4 ft., shows good scar.
20" D. Fir N. 39° W. 20.2 ft., shows good scar.
9" D. Fir N. 51° E. 21.4 ft., opened for scribe "W B9"
face rotten, ring count places scribe 1924.

New BT: 16" D. Fir N. 73° E. scribed T28S R7W S9 CSB T.

Note - This corner on old E - W. Fence Line.

7/84
FD. G. BAUCHMAN
RM 3-62

John M. Powell
&
Crew
12/2/66
C. S. File No. 52/79

Section Corner to Sections 16 - 17 - 20 - 21.

Established by double prop. measurement.
Set - 1 1/2" Gal. Iron Pipe, from which:
12" Oak scribed S16 BT bears N. 33° 08' 59" E., 9.5 ft.
12" Oak scribed S17 BT bears N. 77° 36' 41" W. 31.7 ft.
"X" chiseled in a rock face bears S. 47° 31' 01" E. 33.34 ft.
"Y" chiseled in a rock face bears S. 31° 44' 29" W. 43.8 ft.
Note - See Map File M 32 - 76 for bear. & dist. to other corners.

184

Wm. C. Stiles, Seek, Inc.
For L. & H. Lumber Co.
March 23, 1967
C. S. File No. 55/32 - M 32 - 76

1/4 Corner to Sections 16 and 21.

Established by single prop. measurement, S. 89° 33' 10" E., 2627.52 ft.
from corner to Sections 16, 17, 20, and 21. See above.

Set - 1 1/2" Galv. Iron Pipe, from which:
12" D. Fir bears N. 29° 21' 09" W., 13.0 ft. scribed 1/4 S16 BT.
14" D. Fir bears S. 34° 16' 51" W., 13.5 ft. scribed 1/4 S21 BT.

#253 185

RE-RENEWED