

Douglas County Surveyor's Record of
Government Corners Renewed

T 28 S. T.S. R 5 W. R.W.W.M.

KOKE-CHAPMAN CO., EUGENE, ORE. 21881

James W. Byron, Deputy County Surveyor
Dale McFarland
J. Powell
December 1961
C. S. File No. 49/64

South $\frac{1}{4}$ Corner Section 33, T27-5W. North Boundary T28-5W. 116
Found - Orig. 10", now 12" B.O. N.37°W. 133.3 ft., not 130.3 ft.,
shows good scribing on old face "S".
Orig. 16", now 36" B.O. N.15 $\frac{1}{4}$ °E. 180.8 ft, shows old scar.
I do not open.

Set - Brass Cap Mkd: County Surveyor's Office, 1961
CC $\frac{1}{4}$ S33 T27S R5W.
New BT's: Rescribe Orig., now 36" B.O. N.15 $\frac{1}{4}$ °E. 180.8 ft. S $\frac{1}{4}$ S33 CS BT.
12" B.Oak bears N.14°W. 39.7 ft. scribed S $\frac{1}{4}$ S33 CS BT.
CC S33 60.7 ft. West N. $\frac{1}{4}$ Cor. Sec. 4, T28-5W.

North $\frac{1}{4}$ Corner to Section 4. 117
Found - Orig. 30", now 36" Pine Snag S.34 $\frac{1}{4}$ °W. 288.4 ft., shows good
scribing " $\frac{1}{4}$ ".

Set - Brass Cap Mkd: County Surveyor's Office, 1961
North $\frac{1}{4}$ S4 T28S R5W.
New BT's: 26" Cedar bears S.60°W. 85.5 ft. scribed N $\frac{1}{4}$ S 4 CS BT.
44" Cedar bears N.24°E. 57.0 ft. scribed N $\frac{1}{4}$ S CS BT

$\frac{1}{4}$ Section Corner to Sections 35 and 36. 118
Found - Orig. 8", now 16" B.Oak N.75°W. 148.5 ft., previously opened,
shows good scribing "BT". Rock to N. E. not found.

Note - Compass needle at corner seems to be about 5° in error but
O.K. at BT. Bearings to New BT's are as read at corner.

Set - Brass Cap Mkd: County Surveyor's Office, 1961
 $\frac{1}{4}$ S35/S36 T28S R5W
New BT's: 9" R.Fir bears S.54°W. 105.7 ft. scribed $\frac{1}{4}$ S35 CS BT.
30" R.Fir bears N.23 $\frac{1}{2}$ °E. 64.0 ft. scribed $\frac{1}{4}$ S36 CS BT.
(This BT. is at fence corner.

*Fd. by:
Wm. Ruppert
Jan-Mar-83
M 93-68*

Section Corner to Sections 26 - 27 - 34 - 35. 119

Found - $\frac{3}{4}$ " I. Pipe set by Markham. N. E. & North BT's, O. K.
H. H. BT. now down. **REN #27**
Set - Brass Cap alongside I.P. Mkd: County Surveyor's #158
Office, 1961

S27	S26
S34	S35

 T28-5W
New BT: 12" R.Fir bears S.89°W. 283.5 ft. scribed S34 T28S R5W CS BT.

$\frac{1}{4}$ Corner to Sections 25 and 36. 120

Found - Orig. 20", now 44" R.Fir, shows good bark scribing "BT",
N.45°W. 37.6 ft. Orig. S.E. BT. not found.
Set - Brass Cap Mkd: County Surveyor's $\frac{1}{4}$ S25 T28S R5W Fd. ok 1/81
B. Holt
M 87-54
Office, 1961

S25
S36

New BT's: Rescribe Orig., now 44" R.Fir N.45°W. 38.4 ft. $\frac{1}{4}$ S25 CS BT (bark scrb)
18" R.Fir bears S.61°E. 37.0 ft. scribed $\frac{1}{4}$ S36 CS BT.

Corner to Sections 5 and 6. 121

Found - Iron Bolt at corner & both BT's which show good scars. **REN #12**
Set - Brass Cap at corner & alongside I.B. Mkd: County Surveyor's
Office, 1961

S6/S5

 T28S R5W Fd. ok. by
H. Pieske
June, 1982
M 90-22

Corner to Sections 31 and 32, T27S R5W, North Boundary T28-5W. 122

Found - Iron Bolt at Cor. & now 20" R.Fir N. 9°W., not N.9°E., 11.4 ft.,
shows good scar. Orig. N.W. BT., now down.
New BT: 21" R.Fir bears West 5.5 ft. scribed S31 T27S R5W CS BT.
61/32 77.2 ft.

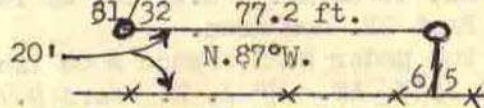

$\frac{1}{4}$ Corner to Sections 5 and 4. 123

Found - Orig. 12", now 26" W.O. S.67°E. 89.5 ft., fd. good scribe marks.
Orig. 24", now 48" Dbl. B.O. N.33°W., not N.35°W. 235.6 ft. good scar.

Note - Corner is 7 ft. South of E. W. Fence.
Set - Brass Cap Mkd: County Surveyor's Office, 1961 $\frac{1}{4}$ S5/S4 T28S R4W.
New BT's: 21" Dbl. B.O. N.5°E. 28.5 ft. scribed $\frac{1}{4}$ S4 CS BT.
16" W.O. bears N.66°W. 43.1 ft. scribed $\frac{1}{4}$ S5 CS BT.