

Douglas County Surveyor's Record of  
Government Corners Renewed

E. 26 S. T. S. R. 7 W. R.W.W.M.

Wit. Cor. to Sec. 31, T26-6W. & Sec. 36, T26-7W.  
Set - Brass Cap "Stamped" W.C.  $\frac{1}{2}$  S 36 T26S R7W  
30' west to corner S 31 T26S R6W LS 544 #118  
Scribed: 16" Oak bears S. 16° W. 16.3 ft. scribed WC  $\frac{1}{4}$  S31 BT.  
Note:  $\frac{1}{4}$  Corner set from field notes by Wm. Paulin, D.C. Road Dept.  
Set  $\frac{5}{8}$ " I.R. at  $\frac{1}{4}$  Corner. See also C.S. 58/176

**RENEWED SEE CORNER NO #118**

82

83

Sec. Corner to Secs. 30 & 31, T26-6W. and Secs. 25 & 36, T26-7W.  
Found -  $\frac{1}{2}$ " Iron Pipe, unrecorded.  
Set - Brass Cap "Stamped" S30,31 T26S R6W  
S25,36 T26S R7W LS 544  
New BT's: 6" Oak bears N. 40° W. 6.3 ft. scribed S25 T26S R7W BT.  
9" Oak bears S. 64° E. 30.7 ft. scribed S31 T26S R6W BT.  
7" Oak bears N. 2° E. 65.8 ft. scribed S30 T26S R6W BT.

Don E. Garrett  
For Willard Nickolaus  
Dec. 29, 1967  
Map File M 35 - 17

84

$\frac{1}{4}$  Corner to Section 12, T26-7W. and Sec. 7, T26-6W.  
Prorated  $\frac{1}{4}$  Corner, See Map in File.  
Found - Unrecorded  $\frac{1}{2}$ " Iron Pipe S. 79° 34' 24" E. 34.31 ft. from  $\frac{1}{4}$  Cor.  
Set - Brass Cap at Cor. Mkd: County Surveyor's R T.26S R  
Office 7  $\frac{1}{4}$  S12 | S 7 6  
1970 W  
New BT's: 12" D.Fir S. 16° 30' E. 43.8 ft. mkd: " $\frac{1}{4}$  S 7 CS BT".  
9" D.Fir N. 83° W. 11.8 ft. mkd: " $\frac{1}{4}$  S12 CS BT".  
1/15/70

J.W. Byron  
Co. Surveyor  
G.S. File  
54/97

85

Section cor. to sec. 32, 33, 5, 4. (S.Bdy. T26-7)  
Found- Orig. 36" Douglas Fir, now snag, N. 75  $\frac{3}{4}$ ° E. 11.9 ft.  
Shows scar. (burnt)  
Orig. 24" Douglas Fir, now snag, N. 64° W. 29.7 ft.  
Shows scar. (burnt)  
28" Douglas Fir, now snag, S. 68  $\frac{1}{2}$ ° W. 44.2 ft. Shows scar.  
36" Douglas Fir, now stump, E. 51.5 ft.  
1959 B.L.M. brass cap, set flush with ground, properly mkd.  
Set -  $\frac{5}{8}$ " Iron rods for bearing objects as follows:

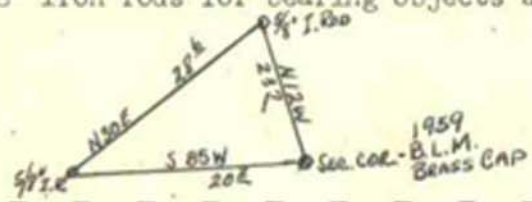

John M. Powell  
Frank Jones & W. Penley  
C.S. File No. 54/23

86

$\frac{1}{4}$  Corner to Sections 3 and 4.  
Set - Brass Cap  
Bearing Tree: 12" W.Fir N. 85° W. 37.4 ft. mkd: " $\frac{1}{4}$  S4 T26S  
R.7W. BT.  
27" W.Fir S. 87° E. 41.0 ft. mkd: " $\frac{1}{4}$  S3 T26S  
R7W B.T.  
April, 1970

Wm. S. Barnes  
For: Thomas  
Map M 39 - 63

87

$\frac{1}{4}$  Corner to Sections 23 and 24.  
Found - Orig. 10", now 26" W.Oak, down, N. 55° W. 19.8 ft., find  
"BT" scribe in sawed stump.  
No trace other Orig. Bearing Tree.  
Set - Brass Cap at Cor. Mkd: County Surveyor's T26S R7W  
Office, 1970  $\frac{1}{4}$  S 23 | S 24  
Set Brass Cap in E - W Fence Line 1.0 ft. West of fence  
corner, fences E - W & N. on N. side of graveled road.  
New BT's: 10" W.Oak S. 1° E. 54.2 ft. mkd: " $\frac{1}{4}$  S24 CS BT".  
9" W.Oak N. 46° W. 62.5 ft. mkd: " $\frac{1}{4}$  S23 CS BT".  
Set -  $\frac{5}{8}$ " Iron Rod in fence line N. 88° E. 20.05 feet.

V. "Ray"  
Tracy &  
V. Perron  
C.S. File  
No.  
54/23

10/9/70 MARCH 71