

Township 32 South Range 3 West

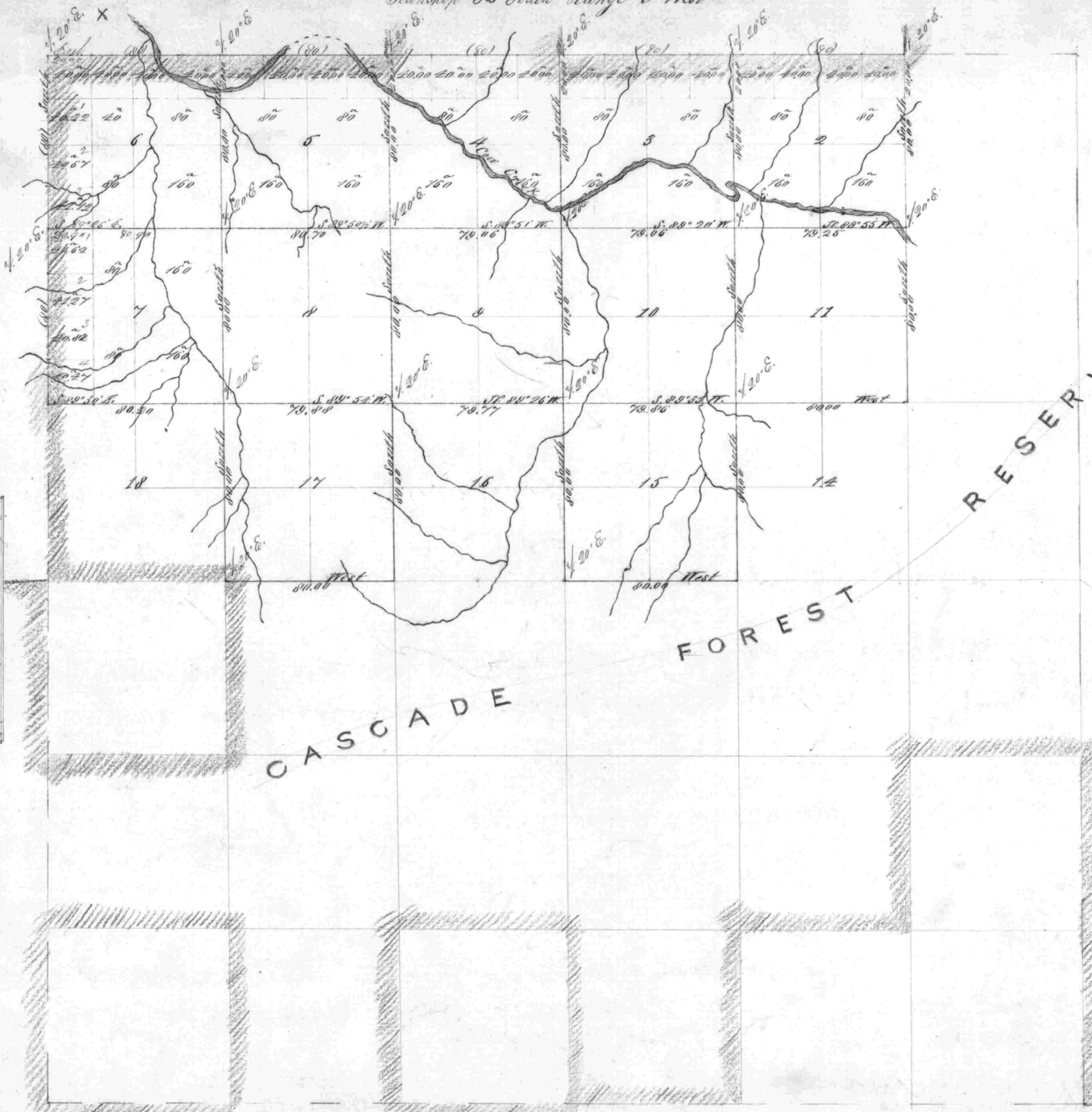

Section	Acres
2	640.00
3	640.00
4	640.00
5	642.97
6	644.18
7	640.00
8	640.00
9	640.00
10	640.00
11	640.00
12	160.00
15	640.00
16	640.00
17	640.00
18	160.00
Total 6400.00	

General Description
 The land in this Township along Cascade Creek and its tributaries is of a rich alluvial soil, the soil being light decomposed granite sand soil. The timber is very fine consisting of Sugar pine a timber much valued by lumbermen. Gold is found along the creek and nearly all its tributaries. No place now occupied for mining purposes.

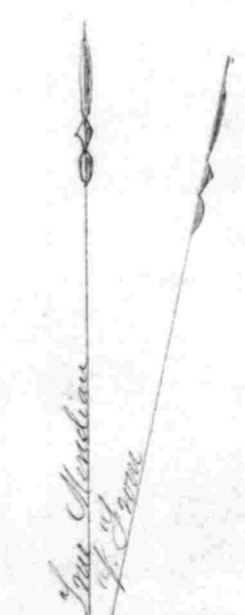

Scale 40 Chs to an inch

Lines	Contractor	No.	Contract Date	Arch. Survey	Commenced	Completed
Subdivisions	M. A. B. Jones	152	June 24, 1872	78 68	Sept. 21, 1877	Oct. 6, 1877

The above Map of Township 32 S. R. 3 W. Mill. Mer. Oregon is strictly conformable to the original field notes of the Survey thereof on file in this office which have been examined and approved.
 U. S. Surveyor Genl. Office
 Eugene City April 26th 1872
 W. A. Odell
 Sur. Genl. Oregon