

TOWNSHIP 31 SOUTH, RANGE 9 WEST, OF THE WILLAMETTE MERIDIAN, OREGON.
DEPENDENT RESURVEY

SEC. 21

SEC. 22

This plat represents a dependent resurvey of a portion of the subdivisional lines, T. 31 S., R. 9 W., Willamette Meridian, Oregon, designed to restore the corners in their true original locations according to the best available evidence.

The subdivisional lines were surveyed by William H. Byars, in 1901.

Survey executed by Lynn M. Roseberry, Cadastral Surveyor, from August 22, 1973 to August 24, 1973, under Special Instructions dated July 19, 1973, which provided for the surveys included under Group No. 822, Oregon.

UNITED STATES DEPARTMENT OF THE INTERIOR
BUREAU OF LAND MANAGEMENT
Washington, D.C. September 14, 1977

SEC. 27

This plat is strictly conformable to the approved field notes, and the survey, having been correctly executed in accordance with the requirements of law and the regulations of this Bureau, is hereby accepted.

For the Director

Acting Chief, Division of Cadastral Survey



MEAN
MAGNETIC
DECLINATION
19°00' E.

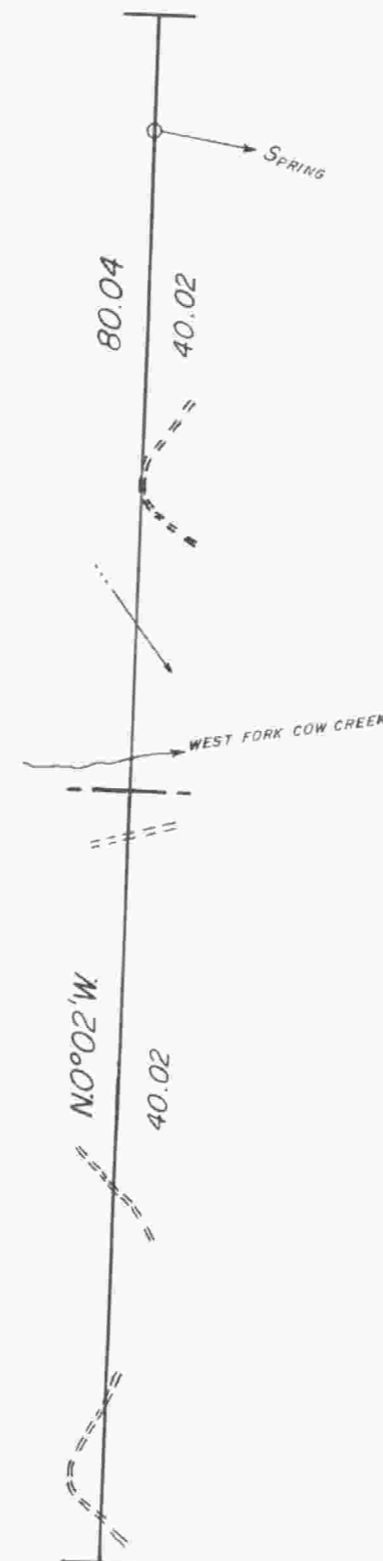

Latitude 42°50.3' N.
Longitude 123°45.6' W.

SEC. 28

SEC. 33

SEC. 34

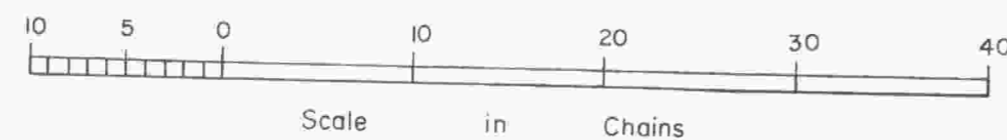

Timber in this area consists of fir, chinquapin, madrone, cedar, alder, and yew.