

TOWNSHIP 31 SOUTH, RANGE 8 WEST, OF THE WILLAMETTE MERIDIAN, OREGON.

DEPENDENT RESURVEY

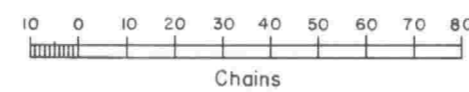
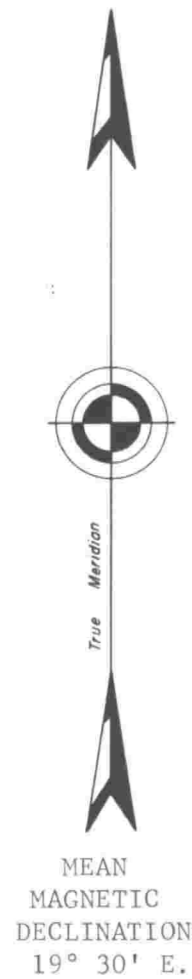
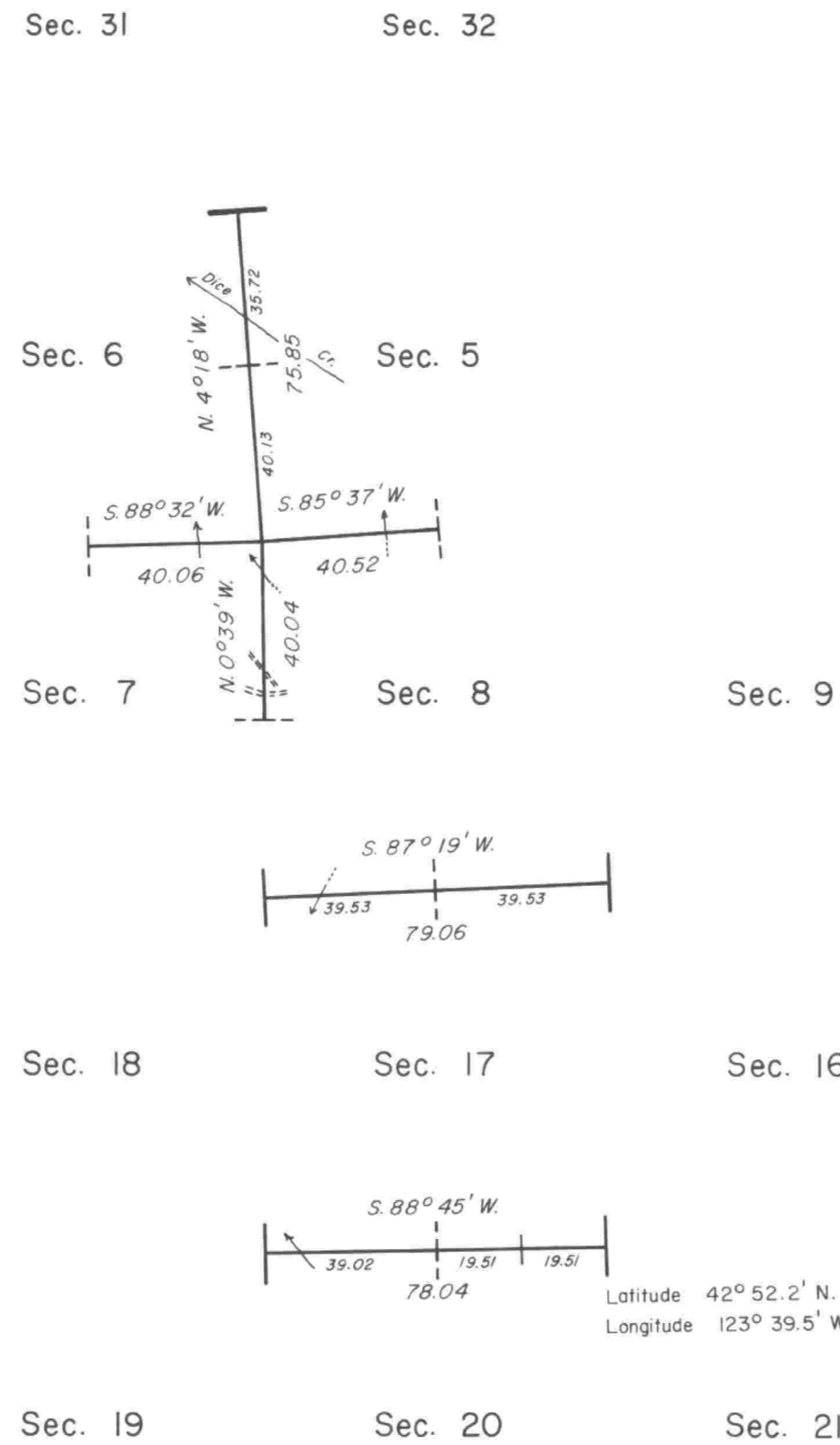

Latitude 42° 52.2' N.
Longitude 123° 39.5' W.

This plat represents a retracement and re-establishment of a portion of the subdivisional lines, T. 31 S., R. 8 W., of the Willamette Meridian, Oregon, designed to restore the corners in their true original location according to the best available evidence.

The boundaries of the township and the subdivisional lines were surveyed by William H. Byars, in 1882-83.

A portion of the north and west boundaries of the township, and a portion of the subdivisional lines were resurveyed and certain corners within the township were remonumented without survey by C. Albert White, Harold D. Corbin, and Donald R. Beck, in 1960-62.

The resurvey, was executed by Charles E. Akin, Jr., Cadastral Surveyor, from August 9, 1973 to October 2, 1973 under Special Instructions dated July 11, 1973, which provide for the surveys included under Group No. 819, Oregon.

UNITED STATES DEPARTMENT OF THE INTERIOR
BUREAU OF LAND MANAGEMENT
Washington, D.C. October 8, 1975

This plat is strictly conformable to the approved field notes, and the survey, having been correctly executed in accordance with the requirements of law and the regulations of this Bureau, is hereby accepted.

For the Director

Bernard W. Hoopes
Chief, Division of Cadastral Survey

Timber in this area consists of Douglas fir, hemlock, white fir, pine, cedar, madrone, maple, alder, yew, live oak, and chinquapin.