

TOWNSHIP 31 SOUTH, RANGE 8 WEST, OF THE WILLAMETTE MERIDIAN, OREGON.

CORRECTIVE DEPENDENT RESURVEY

Sec. 9

Sec. 10

Sec. 11

Sec. 16

Sec. 14

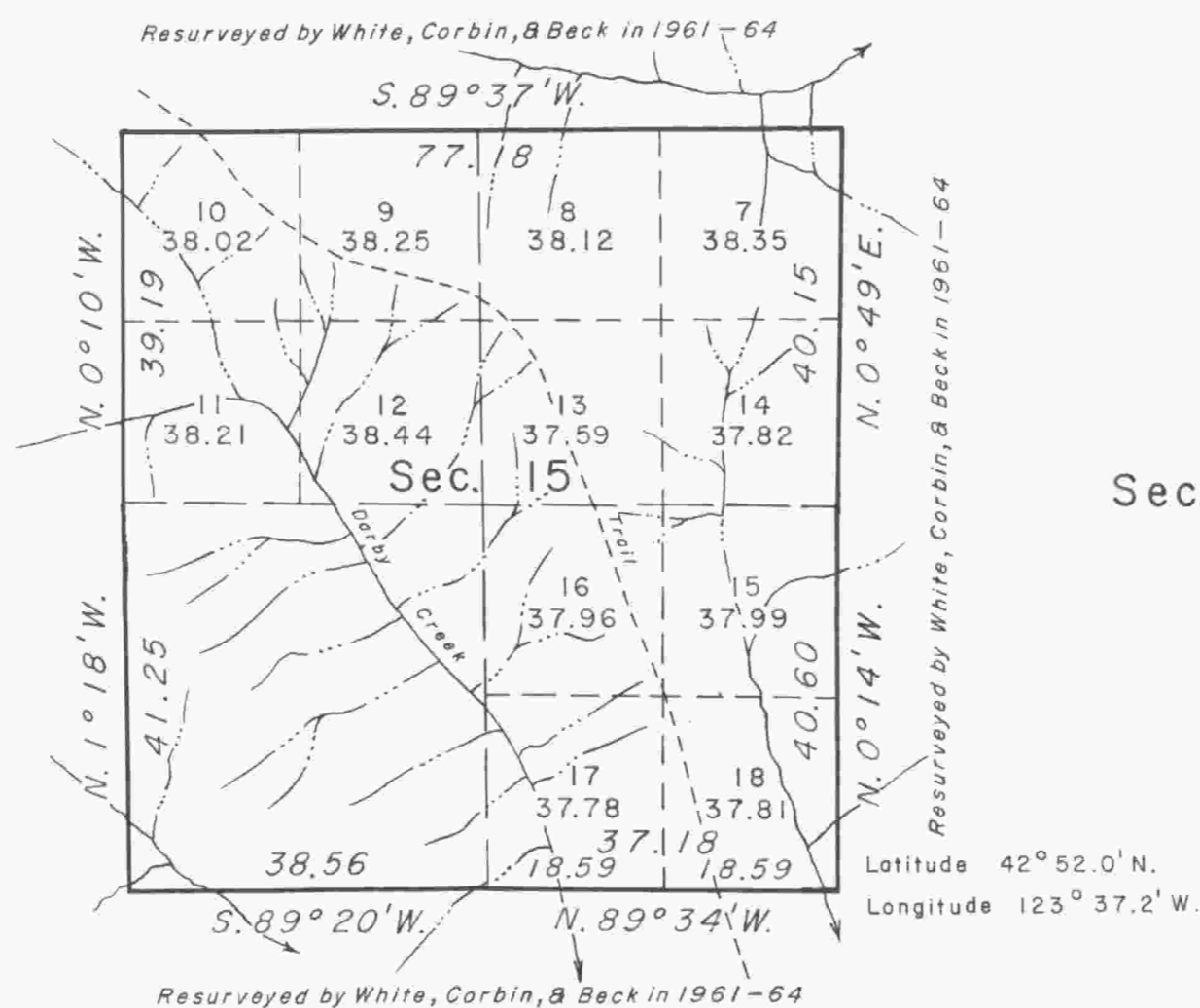

Mean
magnetic
declination
19° East

A portion of the subdivisional lines were resurveyed by C. Albert White, Harold D. Corbin, and Donald R. Beck in 1961-64.

This plat represents a corrective dependent resurvey of the line between sections 15 and 16, T. 31 S., R. 8 W., Willamette Meridian, Oregon, designed to restore the corners in their true original location according to the best available evidence.

Excepting as new or modified vacant subdivisions are shown hereon, the lottings and areas are as shown on the plat approved July 28, 1883.

The resurvey was executed by Peter A. Peterson and Harvey E. Wofford, Cadastral Surveyors, September 29, 1971, under Special Instructions dated April 11, 1961, which provide for the surveys included under Group No. 446, Oregon.

Sec. 21

Sec. 22

Sec. 23



Chains

UNITED STATES DEPARTMENT OF THE INTERIOR
BUREAU OF LAND MANAGEMENT
Washington, D.C. July 6, 1972

This plat is strictly conformable to the approved field notes, and the survey, having been correctly executed in accordance with the requirements of law and the regulations of this Bureau, is hereby accepted.

For the Director

Chief, Division of Cadastral Survey

Timber in this area consists of fir, hemlock, cedar, pine, yew, live oak, madrone, maple, and chinquapin.