

Township No. 31 South Range No. 8 West Willamette Meridian, Oregon.

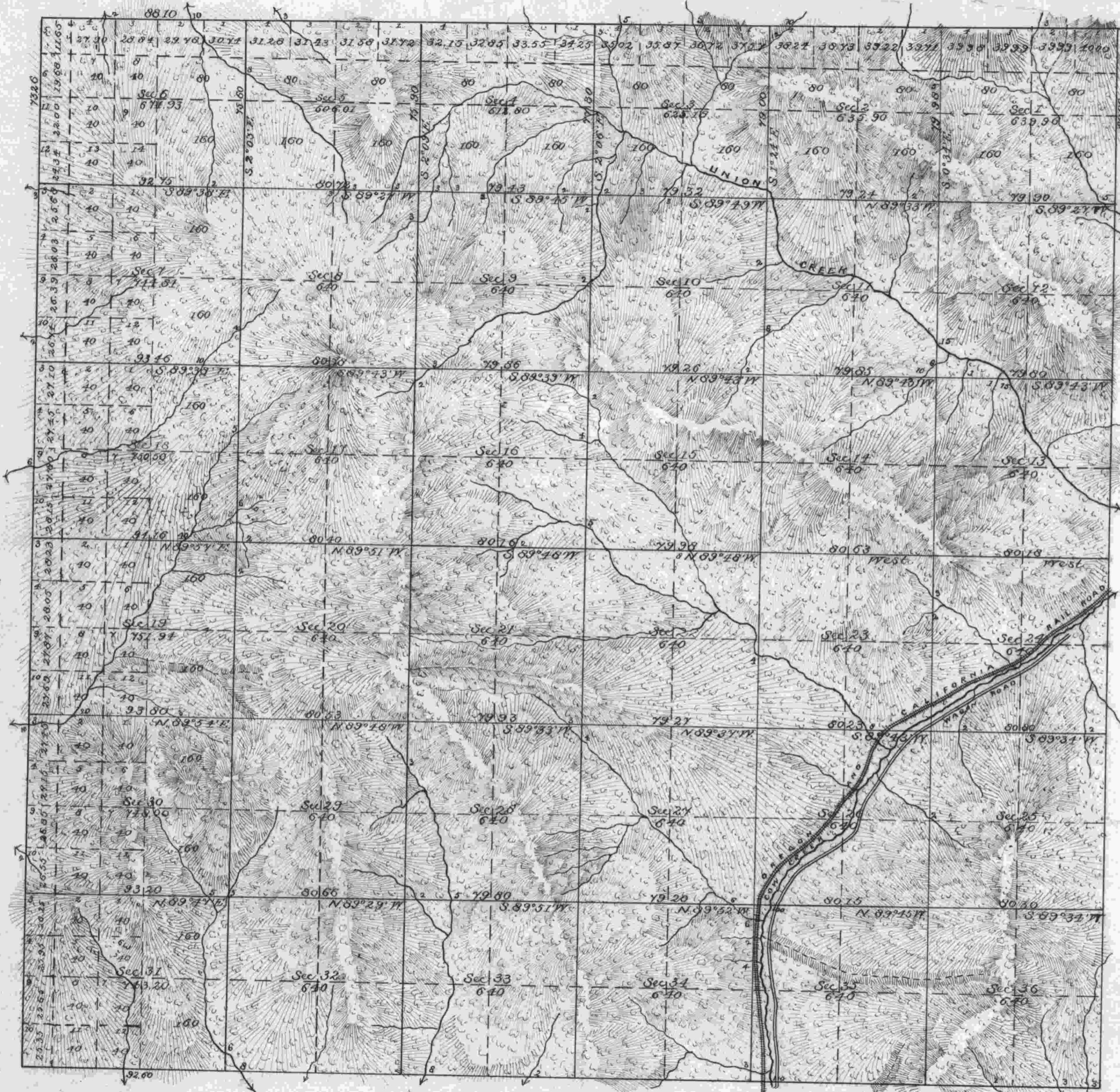

ACCEPTED BY THE HON. COMMISSIONER G. L. O. October 20, 1883

Total number of Acres 23533.26

| SURVEYS DESIGNATED. | BY WHOM SURVEYED. | NO. | DATE OF CONTRACT. | AMOUNT OF SURVEYS. |         |        | WHEN SURVEYED.          | MEAN DECLINATION. |
|---------------------|-------------------|-----|-------------------|--------------------|---------|--------|-------------------------|-------------------|
|                     |                   |     |                   | Miles.             | Chains. | Links. |                         |                   |
| Township Lines      | William H. Byars  | 156 | July 28, 1882     |                    |         |        |                         |                   |
| Subdivisions        | do do do          | do  | do do do          | 60                 | 55      | 53     | Feb. 5 to Apr. 15, 1883 | 19° 30' E.        |

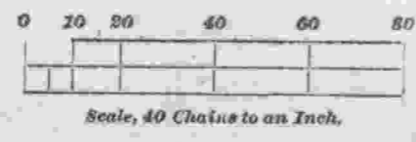

The above map of the Subdivisions of Township No. 31 South of Range No. 8 West of the Willamette Meridian, Oregon, is strictly conformable to the Field Notes of the survey thereof on file in this office, which have been examined and approved.  
 U. S. Surveyor-General's Office,  
 Portland, Oregon,  
 July 28, 1883 James C. Tolman  
Surveyor-General of Oregon