

TOWNSHIP 31 SOUTH, RANGE 7 WEST, OF THE WILLAMETTE MERIDIAN, OREGON.
 DEPENDENT RESURVEY AND REMONUMENTATION

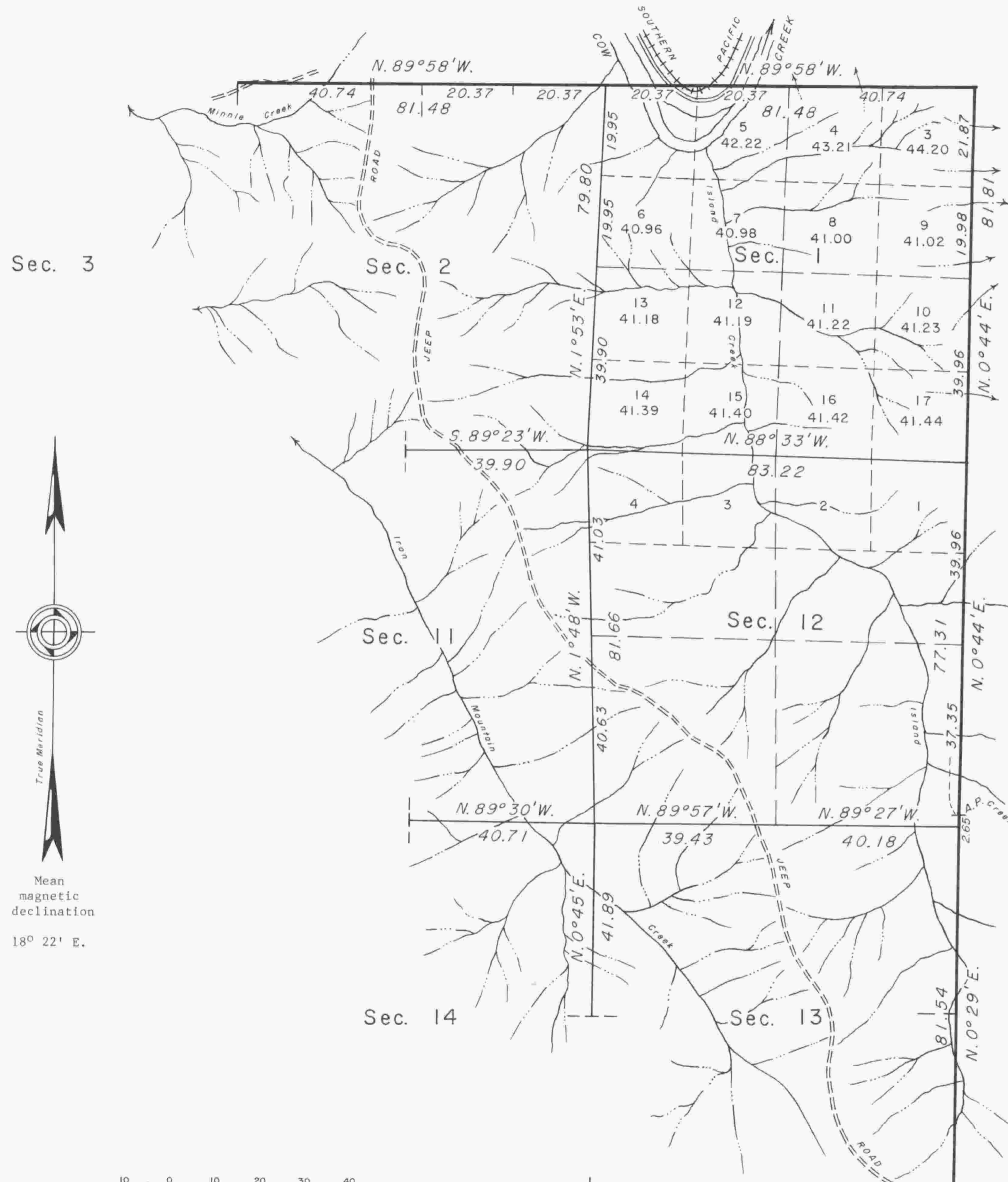

Sec. 3

True Meridian
 Mean magnetic declination
 18° 22' E.

10 5 0 10 20 30 40
 Chains
 Area resurveyed: 1305.66 Acres

Timber in this area consists of fir, hemlock, pine, alder, oak, and cedar.

This plat represents a retracement and reestablishment of a portion of the north and east boundaries, a portion of the subdivisional lines, and the remonumentation of a certain original corner point, T. 31 S., R. 7 W., Willamette Meridian, Oregon, designed to restore the corners in their true original locations according to the best available evidence.

Excepting as new or modified vacant subdivisions are shown hereon, the lottings and areas are as shown on the plats approved January 8, 1873 and October 5, 1882.

The corner of Tps. 30 and 31 S., Rs. 6 and 7 W., was established by Addison R. Flint in 1855. The east boundary was surveyed by Wells Lake and George W. Hyde in 1855. The east 5 miles of the north boundary and a portion of the subdivisional lines were surveyed by William H. Byars in 1872. The east boundary was resurveyed, and the west boundary, the north boundary of section 6, and a portion of the subdivisional lines were surveyed by William H. Byars in 1882. The corner of Tps. 30 and 31 S., Rs. 6 and 7 W. was remonumented by John M. Jelley in 1965.

The resurvey and remonumentation were executed by James E. Jelley, Cadastral Surveyor, from April 2 to September 19, 1969, under Special Instructions dated May 3, 1957 and August 15, 1968, which provide for the surveys included under Group Nos. 350 and 680, Oregon.

◇ Remonumentation under Group No. 350 in 1969.

UNITED STATES DEPARTMENT OF THE INTERIOR
 BUREAU OF LAND MANAGEMENT
 Washington, D.C. March 2, 1972

This plat is strictly conformable to the approved field notes, and the survey, having been correctly executed in accordance with the requirements of law and the regulations of this Bureau, is hereby accepted.

For the Director

Clark L. Lamm

Chief, Division of Cadastral Survey