

TOWNSHIP 31 SOUTH, RANGE 7 WEST, OF THE WILLAMETTE MERIDIAN, OREGON.

DEPENDENT RESURVEY AND SUBDIVISION

This plat represents a retracement and reestablishment of a portion of the south boundary and a portion of the subdivisional lines, designed to restore the corners in their true original locations according to the best available evidence, and, the subdivision of sections 27 and 35. The lottings and areas are as shown on the plat approved October 5, 1882.

These surveys executed by Donald R. Beck, October 4, 1963, to June 17, 1964, under Special Instructions, dated September 25, 1963, and March 19, 1964, for Group No. 531, Oregon.

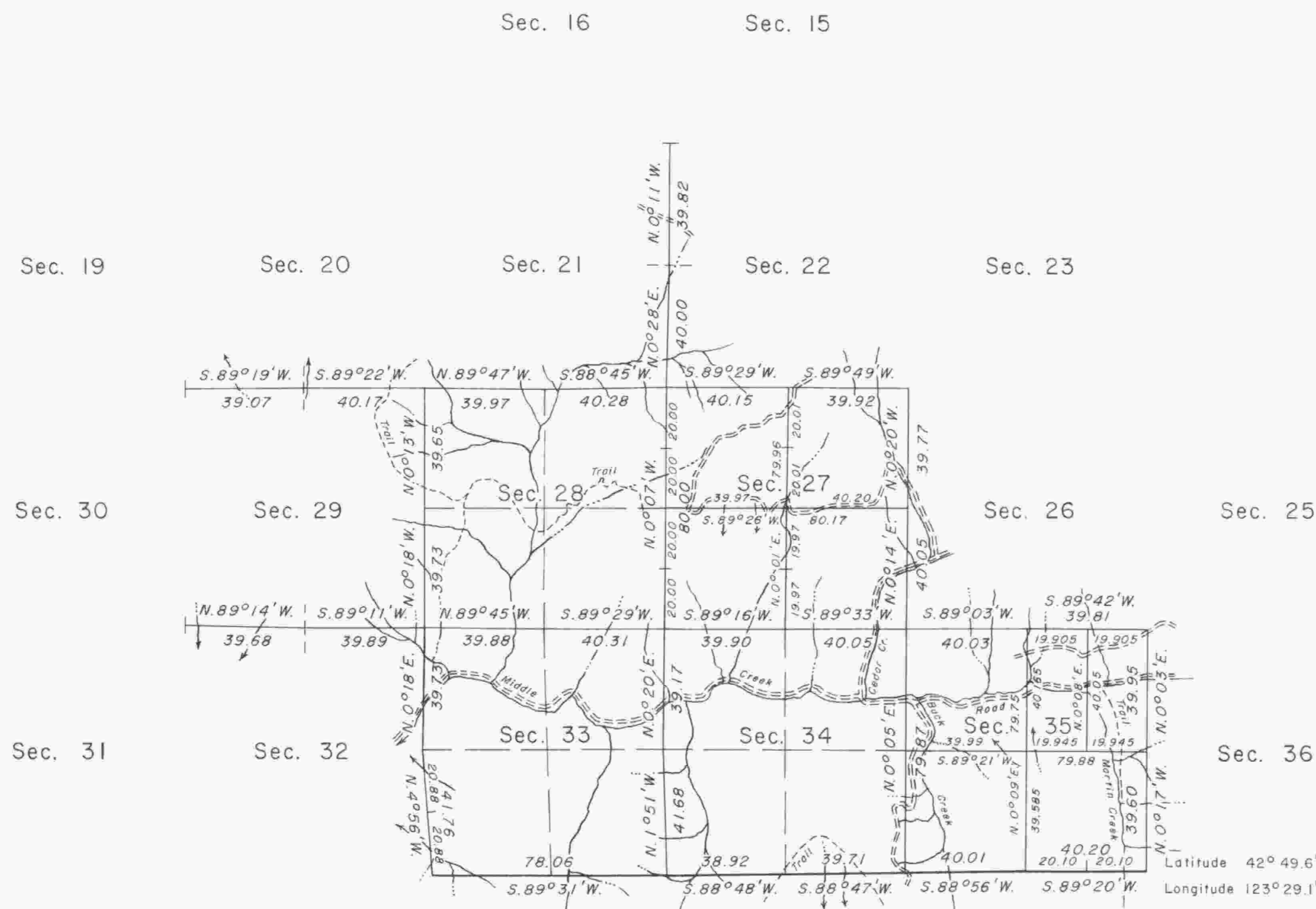
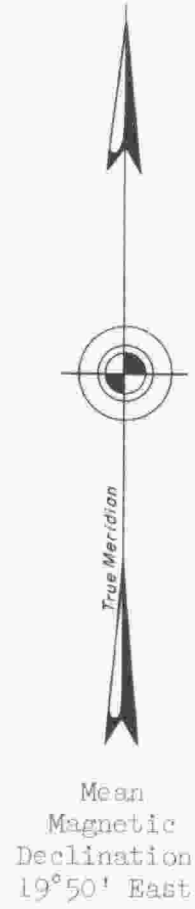

UNITED STATES DEPARTMENT OF THE INTERIOR
BUREAU OF LAND MANAGEMENT
Washington, D. C. August 25, 1965

This plat is strictly conformable to the approved field notes, and the survey, having been correctly executed in accordance with the requirements of law and the regulations of this Bureau, is hereby accepted.

For the Director

Clark I. Sumner

Acting Chief, Division of Engineering

Timber in this area consists of Douglas fir, pine, cedar, hemlock, madrone, maple, chinquapin, oak, alder, yew, and dogwood.



Area resurveyed: 3,200.00 Acres

Latitude 42° 49.6' N.
Longitude 123° 29.1' W.