

Township No. 31 South Range No. 7 West of the Willamette Meridian, Oregon.

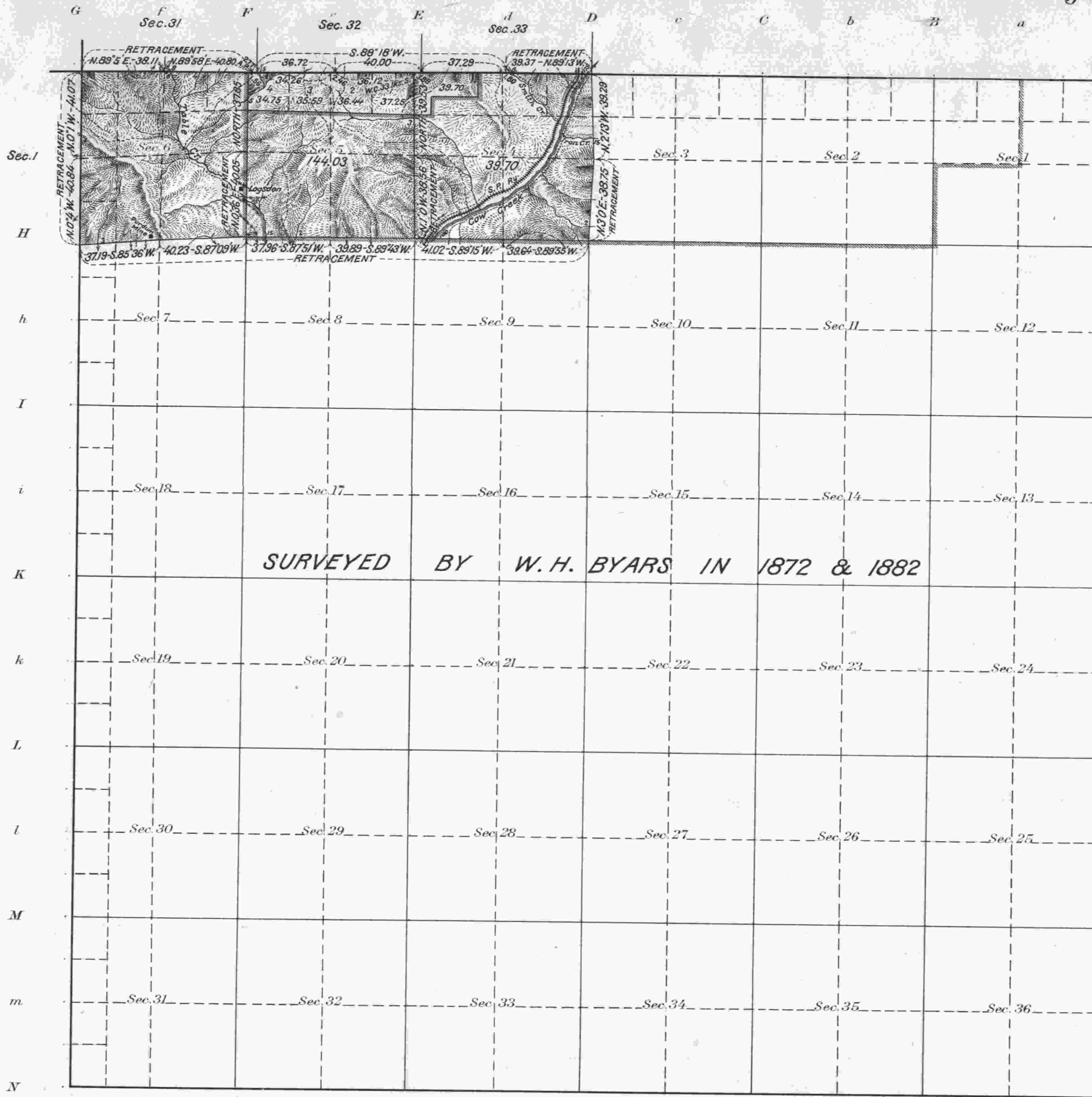

SURVEYED BY W. H. BYARS IN 1872 & 1882

Areas in Acres	
Public Land	183.73
Indian Reservation	
Indian Allotments	
Mineral Claims	
Water Surface	
<b>Total Area</b>	<b>183.73</b>

Scale 40 Chains to an inch  
 Mean Magnetic Declination 20° 45' E.  
 Latitude 42° 53' N. } Near center Sec. 9.  
 Longitude 123° 32' W.

Surveys Designated	By Whom Surveyed	Group			Amount of Surveys		When Surveyed	
		No.	Date of Instructions		Mls.	chs.	lks.	Begun
Retract & Portion W. By.	Gerald A. Sorrels.	36	March 1, 1917.	1	01	91	April 10, 1918.	
Retract & Sur. Portion Subdivs	" "	"	" "	5	63	96	March 13, 1918.	April 8, 1918.
Portion N. By.	" "	"	" "				April 1, 1918.	April 18, 1918.
Township Exteriors	W. H. Byars.		under Contract	No.	448	ms.	1882.	

The above map of Township No. 31 South Range No. 7 West of the Willamette Meridian Oregon is strictly conformable to the field notes of the survey thereof on file in this office, which have been examined and approved

U. S. Surveyor General's Office.  
 Portland, Oregon, January 20, 1919.

*Edward S. Worthy*  
 Surveyor General of Oregon.