

TOWNSHIP 31 SOUTH, RANGE 6 WEST, OF THE WILLAMETTE MERIDIAN, OREGON

DEPENDENT RESURVEY

Sec. 6

Sec. 5

Latitude 42° 53' 54.8" N.
Longitude 123° 26' 43.7" W.

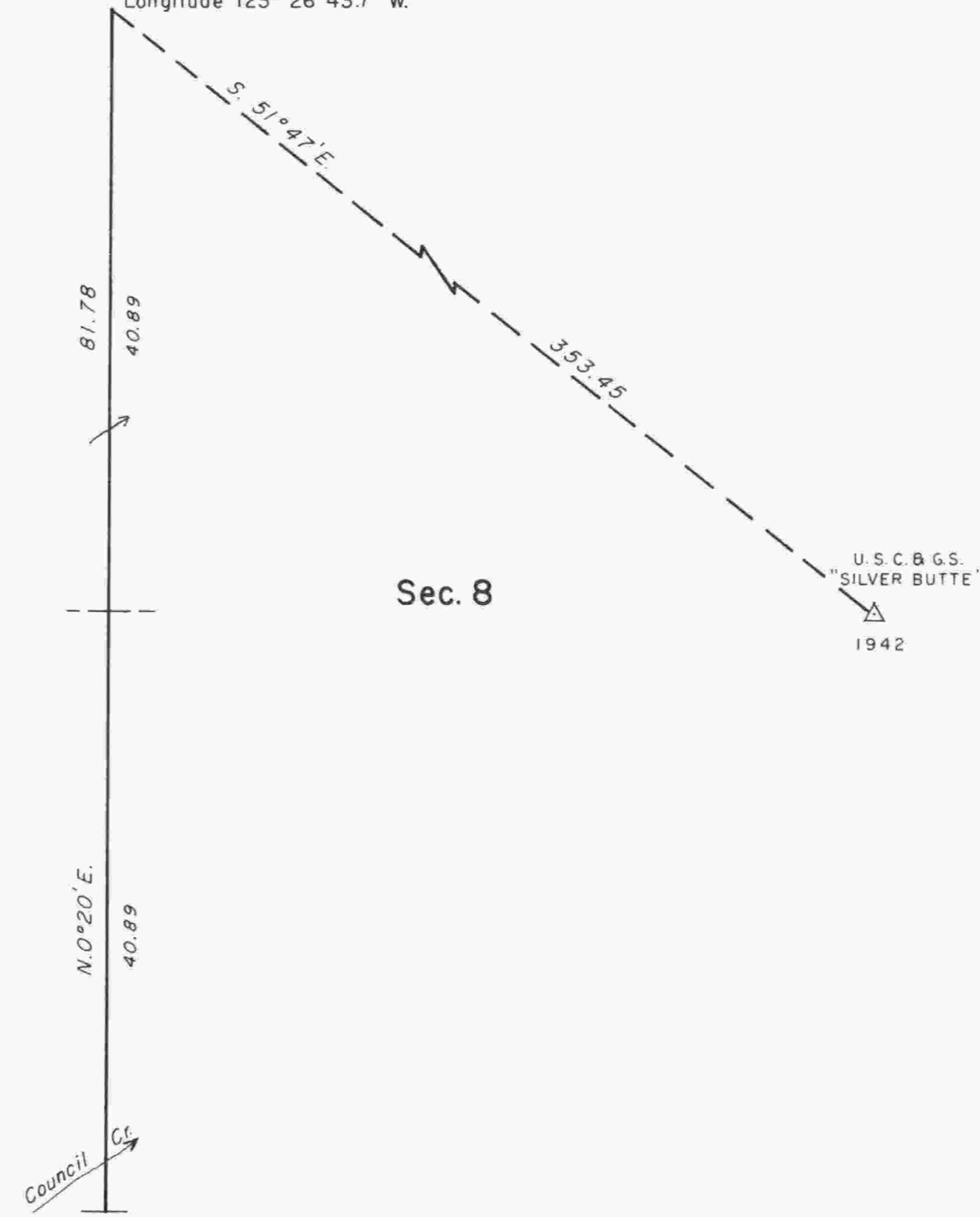

The history of surveys is contained in the field notes.

This plat represents a dependent resurvey of a portion of the subdivisional lines, T. 31 S., R. 6 W., Willamette Meridian, Oregon, designed to restore the corners in their true original locations according to the best available evidence.

The survey was executed by Wayne L. Rogers, Cadastral Surveyor, beginning October 17, 1985, and completed March 14, 1986, pursuant to Special Instructions dated September 6, 1985, under Group Number 1293, Oregon.

Timber in this area consists of fir, yew, pine, cedar, hemlock, madrone, oak, maple, alder, chinquapin, and dogwood.



Mean magnetic declination

18 1/2° EAST

UNITED STATES DEPARTMENT OF THE INTERIOR
BUREAU OF LAND MANAGEMENT
Portland, Oregon June 3, 1988

This plat is strictly conformable to the approved field notes, and the survey, having been correctly executed in accordance with the requirements of law and the regulations of this Bureau, is hereby accepted.

For the Director

Wayne M. Gardner
Chief Cadastral Surveyor of Oregon

Sec. 18

Sec. 17

