

TOWNSHIP 30 SOUTH, RANGE 7 WEST, OF THE WILLAMETTE MERIDIAN, OREGON.

DEPENDENT RESURVEY AND SUBDIVISION OF SECTION 27

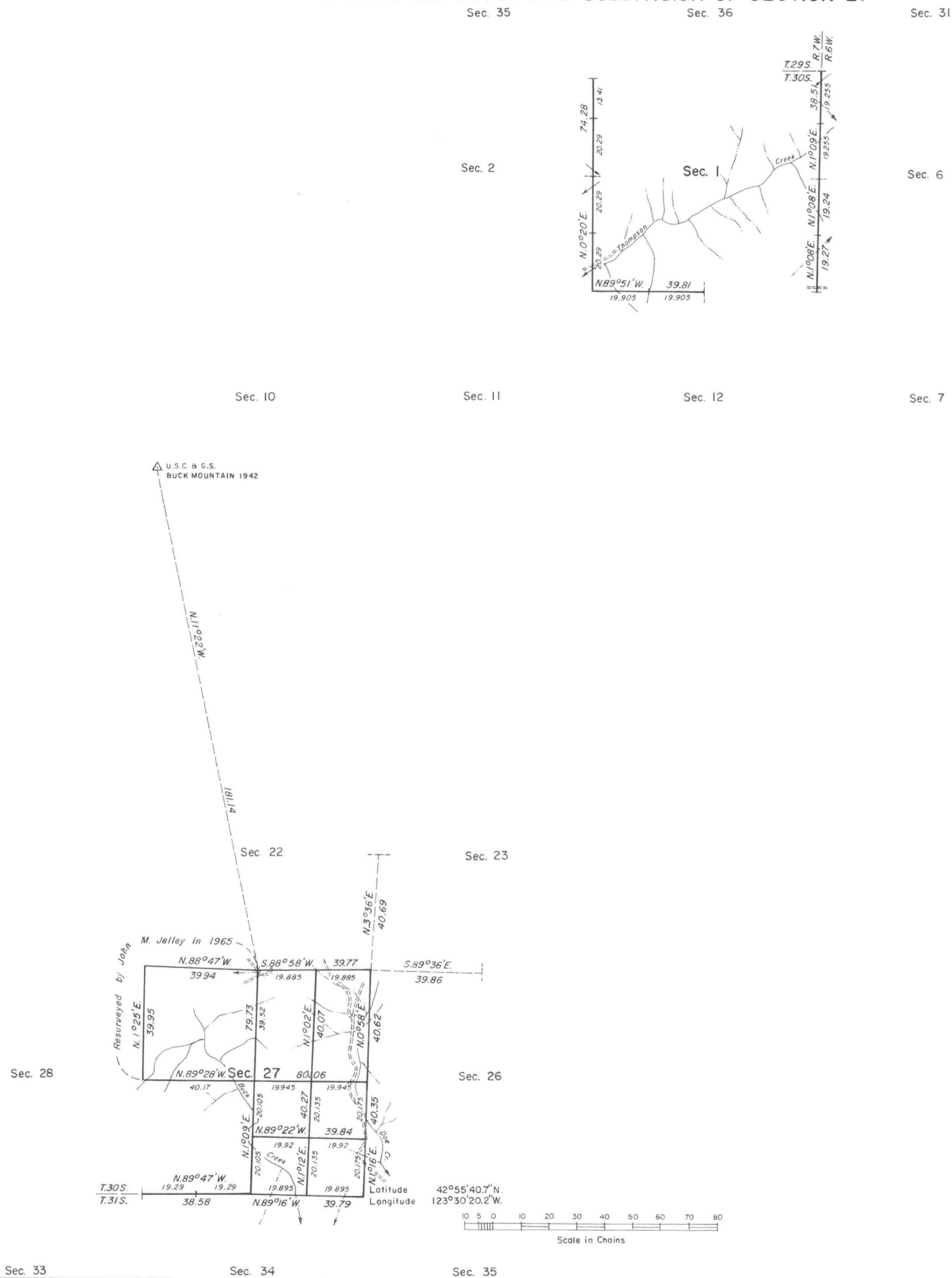
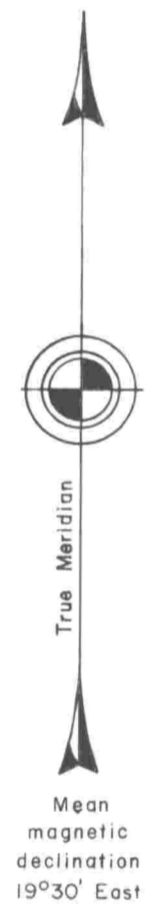

A history of surveys is contained in the field notes.

This plat represents a dependent resurvey of a portion of the east boundary and a portion of the subdivisional lines, T. 30 S., R. 7 W., Willamette Meridian, Oregon, designed to restore the corners in their true original locations according to the best available evidence, and the subdivision of section 27.

The lottings and areas are as shown on the plat approved October 1, 1872.

The survey was executed by James E. Jelley, Cadastral Surveyor, beginning August 11, 1980 and completed March 4, 1982, pursuant to Special Instructions dated January 4, 1980, and Supplemental Special Instructions dated October 17, 1980, for Group No. 1007, Oregon.

Timber in this area consists of fir, hemlock, cedar, maple, oak, madrone, alder, chinquapin, and myrtle.

UNITED STATES DEPARTMENT OF THE INTERIOR
BUREAU OF LAND MANAGEMENT
Portland, Oregon April 7, 1983

This plat is strictly conformable to the approved field notes, and the survey, having been correctly executed in accordance with the requirements of law and the regulations of this Bureau, is hereby accepted.

For the Director

William W. Glenn
Chief Cadastral Surveyor of Oregon