

RSW R7W

283-38-164

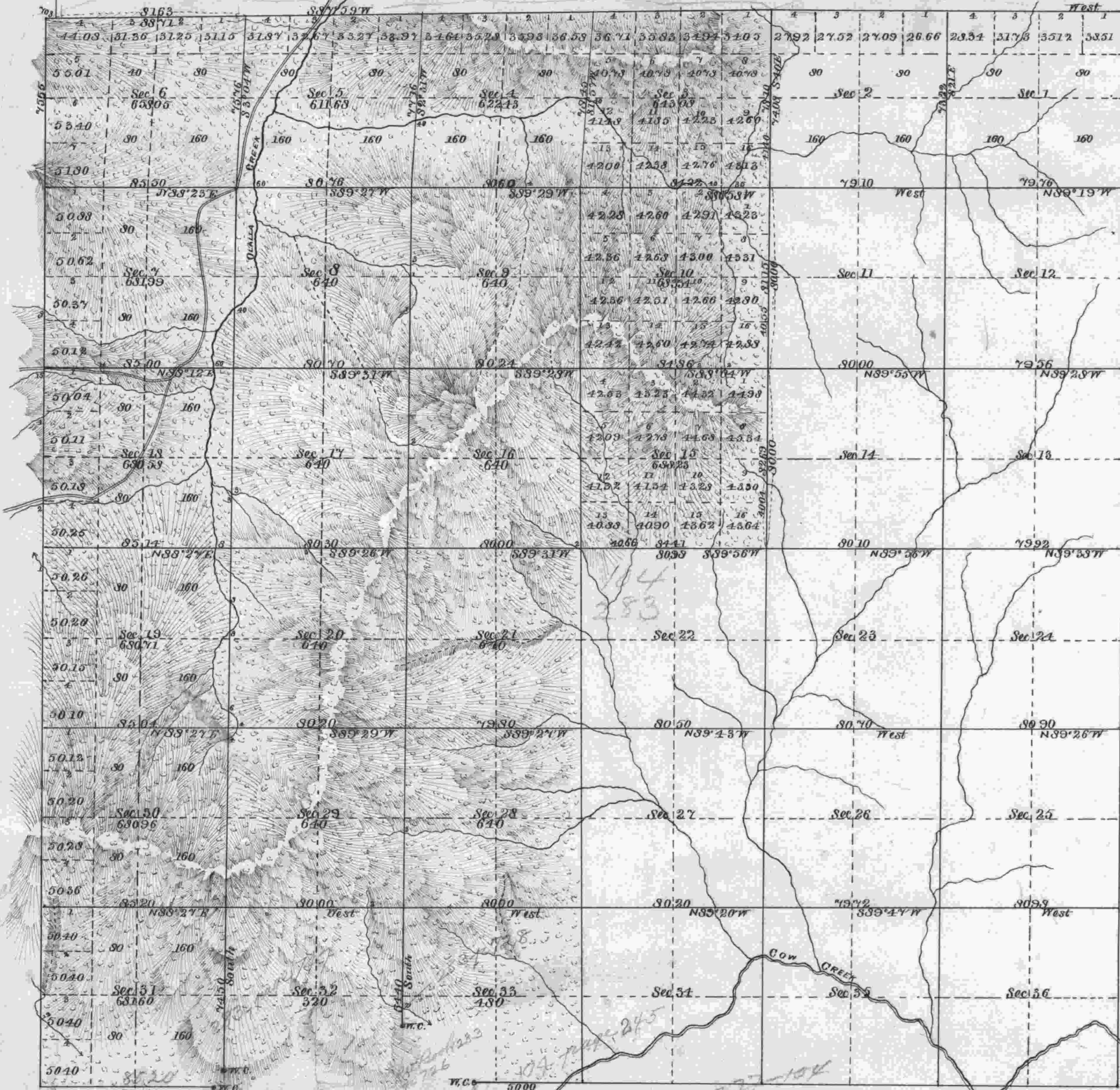

*As indicated  
in field notes*

October 20, 1883  
46  
283

ACCEPTED BY THE HON. COMMISSIONER G. L. O.

*Field notes  
of 56, by Byars  
1882*

Area of Former Survey 8,922.89 Acres - of New Survey 13,232.65 Acres Total number of Acres 22,155.53

SURVEYS DESIGNATED.	BY WHOM SURVEYED.	NO.	DATE OF CONTRACT.	AMOUNT OF SURVEYS.			WHEN SURVEYED.	MEAN DECLINATION.
				Miles.	Chains.	Links.		
Township Lines								
Subdivisions	William H. Byars	456	July 28 1882	31	72	83	Oct 2 to 18 1883	19° 45' E
Resurvey N. E. of Secs 34, 35 & 36	do do do	do	do do do	4	01	63		

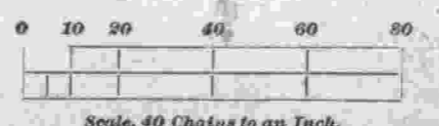

The above map of the Subdivisions of Township No. 30 South of Range No. 7 West of the Willamette Meridian, Oregon, is strictly conformable to the Field Notes of the survey thereof on file in this office, which have been examined and approved.

U. S. Surveyor-General's Office,  
Portland, Oregon,  
July 28, 1883. *James C. Tolman*  
Surveyor-General of Oregon.