

Township 30 South, Range 6 West, Will. Mer. Or.

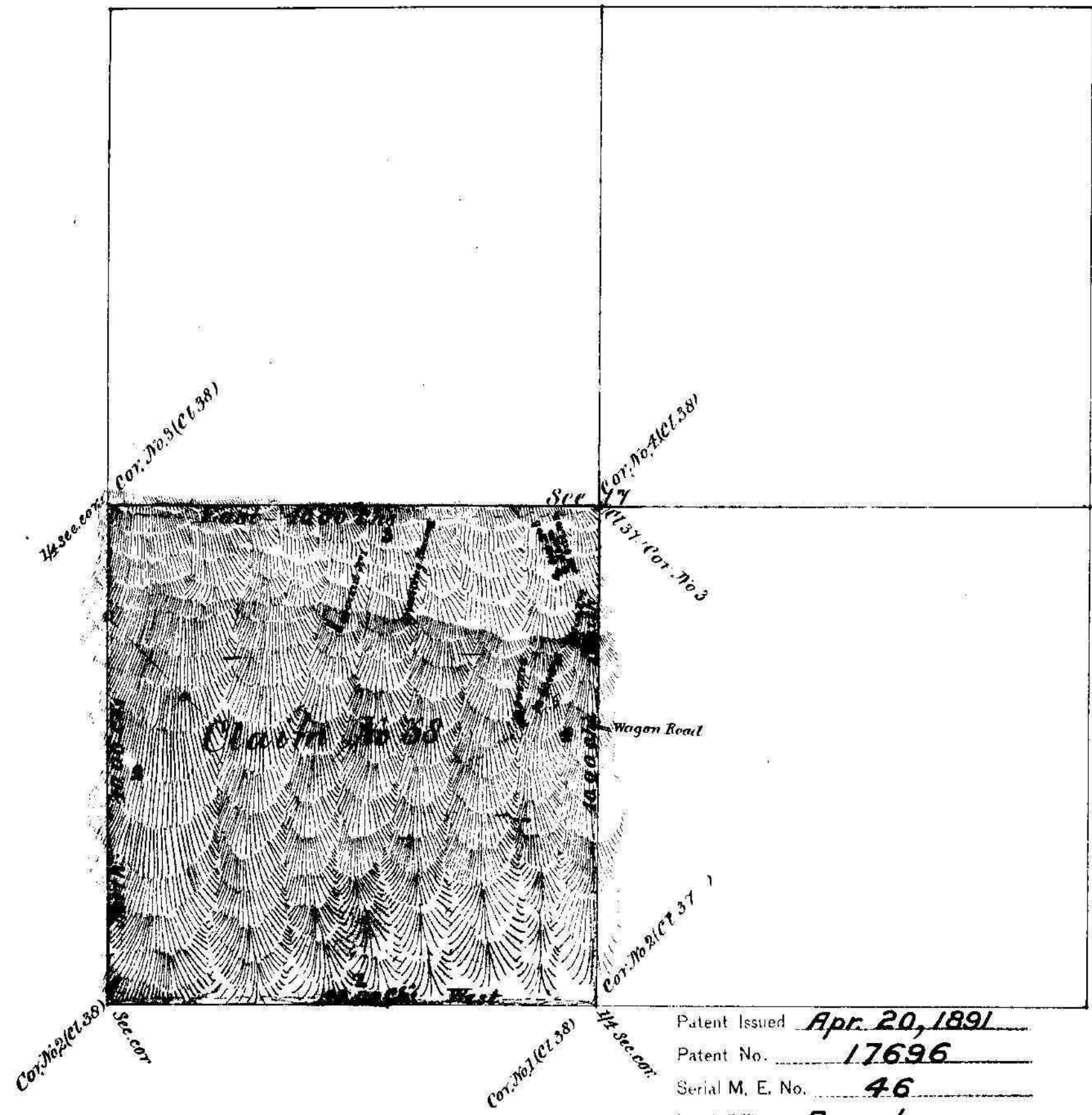

Patent Issued Apr. 20, 1891  
 Patent No. 17696  
 Serial M. E. No. 46  
 Land Office Roseburg  
 Mining Sheet No. 4

Survey No. 1

# PLAT

THE CLAIM OF  
*Edson Adams and H. S. Brown*  
 known as the  
*Oakland Placer, Nickel and Chrome Mine*

*Excelsior* Mining District,

*Douglas* County,  
OREGON.

Containing an area of 160.00 Acres.

Scale of 660 feet to the inch.

Variation, 19° 30' East.

SURVEYED BY

*W. F. Briggs.*  
 U. S. Deputy Mineral Surveyor,

November 17 1886

The original Field Notes of the survey of the Claim of  
*Edson Adams and Harry S. Brown* trustee

known as the *Oakland Placer Nickel and Chrome*  
*Mine* from which this plat has been made,  
 have been examined and approved, and are on file in this  
 office; and I hereby certify that they furnish such an  
 accurate description of said Mining Claim as will, if in-  
 corporated into a patent, serve fully to identify the prem-  
 ises; and that such reference is made therein to natural  
 objects and permanent monuments as will perpetuate  
 and fix the locus thereof. I further certify that the value  
 of the labor and improvements placed thereon by the ap-  
 plicant, or his grantors, is not less than Five Hundred  
 Dollars; and that said improvements consist of *Cuts, Shaft*  
*trunnel and house*.

as appears by the report of the Deputy Surveyor and the  
 testimony of two disinterested witnesses. And I further  
 certify that this is a correct Plat of said Mining Claim,  
 made in conformity with said original Field Notes of  
 the survey thereof.

U. S. Surveyor-General's Office,  
 Portland, Oregon,

December 10 1886

*Douglas W. Taylor.*  
 U. S. Surveyor-General for Oregon.