

Township No 30 South Range No 5 West Willamette Mer.

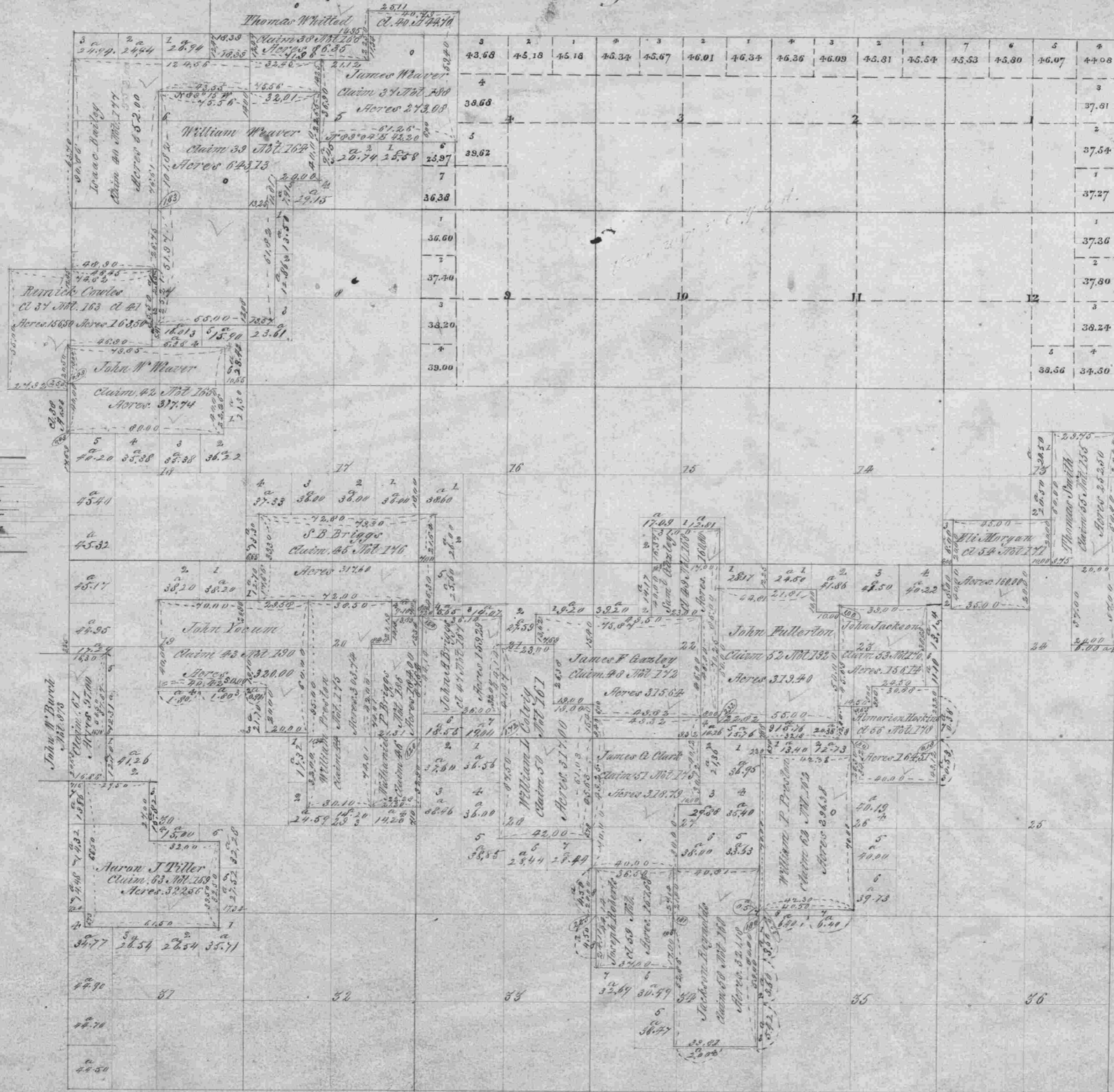

The above Map of Sections 1, 2, 3, 4, 9, 10, 11 and 12, of Township No 30 South, Range No 5 West of the Willamette Meridian, Oregon, is strictly conformable to the field notes of the survey thereof, by Oscar F. Thiel, U.S. and Sur under his Contract No 653, dated May 21, 1896, and also to the field notes of the survey by Bonman and Barlett of James Weaver's Claim No 37, under their Contract No 64, dated September 20, 1855, which have been examined approved, and filed in this office
 U.S. Surveyor General's Office
 Portland, Oregon, Nov 6 1897

Roberta Habershaw
 U.S. Sur Gen for Oregon

The above Map of the survey of claims in Township No 30 South, Range No 5 West Willamette Meridian, Oregon, is strictly conformable to the field notes of the surveys thereof, on file in this office, which have been examined and approved.
 Surveyor General's Office
 Eugene City, March 5th 1862

M. J. Prussia
 Sur Gen. of Oregon