

TOWNSHIP 30 SOUTH, RANGE 3 WEST, OF THE WILLAMETTE MERIDIAN, OREGON.

DEPENDENT RESURVEY

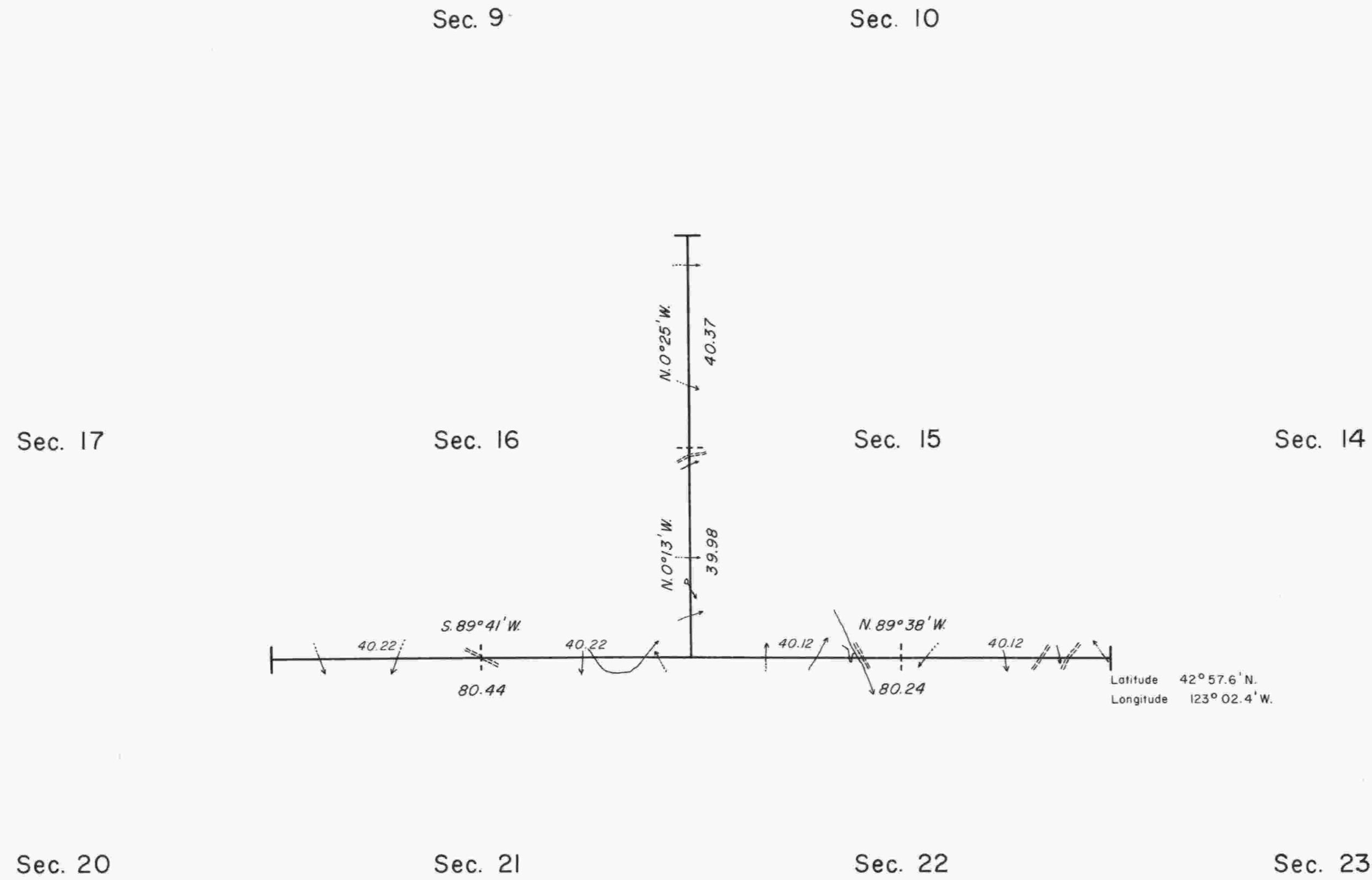
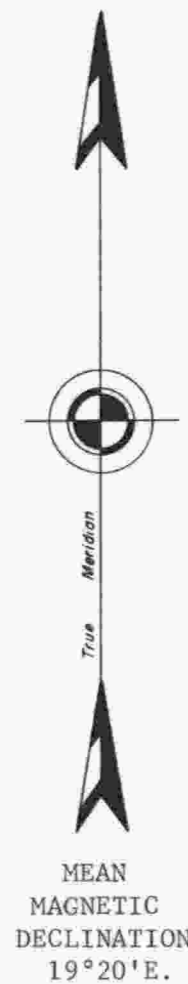

This plat represents a dependent resurvey of a portion of the subdivisional lines, T. 30 S., R. 3 W., Willamette Meridian, Oregon, designed to restore the corners in their true original location according to the best available evidence.

A portion of the subdivisional lines of the township was surveyed by Dennis Hathorn, in 1857.

The survey of the subdivisional lines was completed and a portion of the subdivisional lines was resurveyed or retraced by William M. Bushey, in 1893.

Lottings and areas are as shown on the plat approved June 29, 1895.

The resurvey was executed by Stephen D. Albright and Jack W. Bowder, Cadastral Surveyors from June 22, 1972 to July 10, 1972, under Special Instructions dated June 5, 1972, which provide for the surveys included under Group No. 776, Oregon.

UNITED STATES DEPARTMENT OF THE INTERIOR
 BUREAU OF LAND MANAGEMENT
 Washington, D.C. January 13, 1976

This plat is strictly conformable to the approved field notes, and the survey, having been correctly executed in accordance with the requirements of law and the regulations of this Bureau, is hereby accepted.

For the Director

Bernard W. Foster
 Chief, Division of Cadastral Survey

Timber in this area consists of fir, madrone, cedar, and oak.