

Township No. 30 South, Range No. 1 West, Willamette Meridian, Oregon.

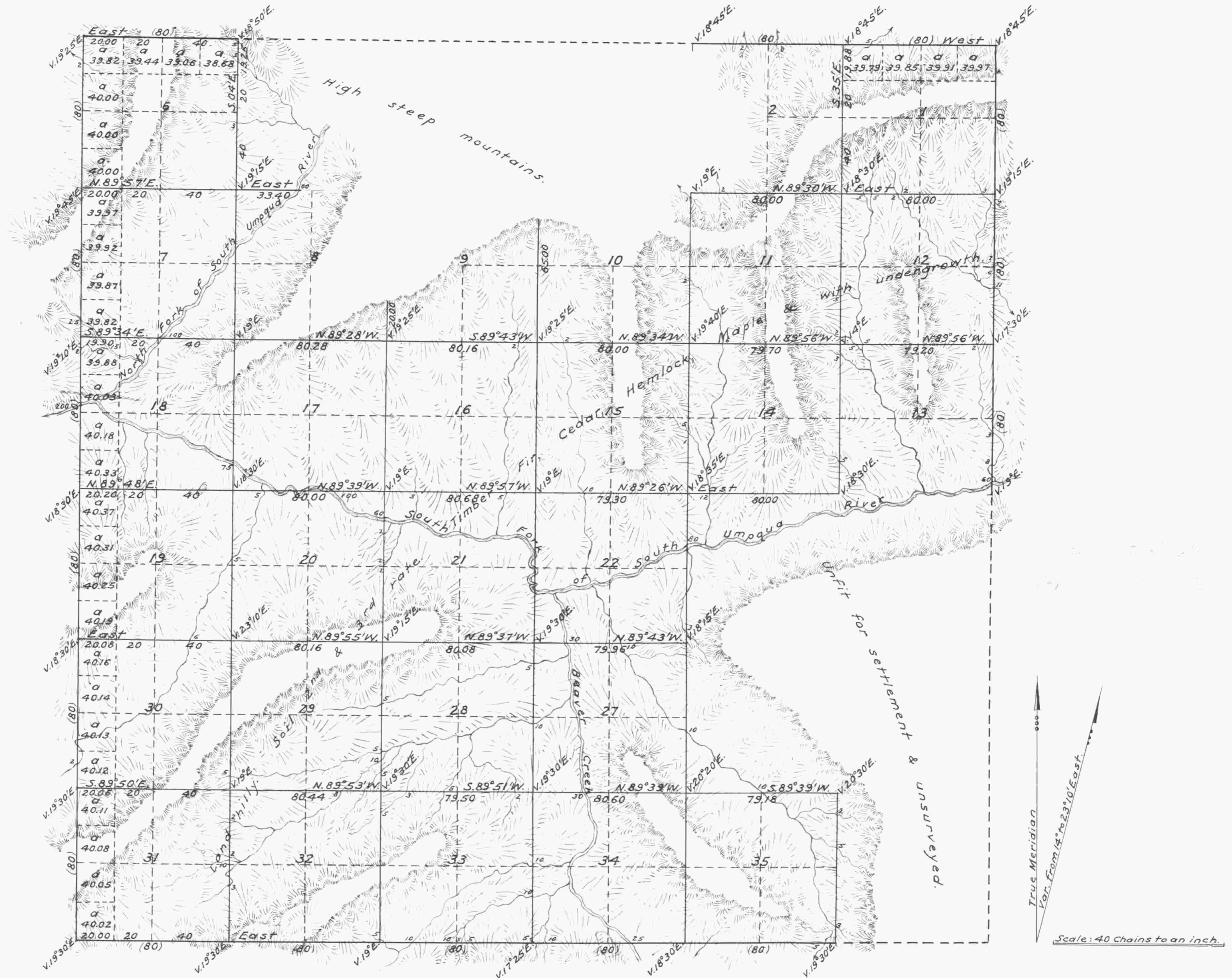

Surveys designated	By whom surveyed	Contract		Amt. of Surveys			When Surveyed
		No.	Date	Miles	chains	links	
Township Lines	Dennis Hathorn	73	June 8 <sup>th</sup> , 1857	11	00	00	February 20 <sup>th</sup> , 1858
Subdivisions	Dennis Hathorn	73	June 8 <sup>th</sup> , 1857	47	37	01	February 20 <sup>th</sup> , 1858
Total number of Acres		16,158.45					

The above Map of Fractional Township No. 30 South, of Range No. 1 West, of the Willamette Meridian, Territory of Oregon, is strictly conformable to the field notes of the survey thereof on file in this office which have been examined and approved.  
 Surveyor General's Office,  
 Salem, February 20<sup>th</sup>, 1858. (signed) John S. Zieber,  
 Sur. Gen. of Oregon.

Public Survey Office,  
 Portland, Oregon,  
 September 9, 1935.  
 I certify this to be a correct  
 copy of the original plat on file in  
 this office.  
 Joseph A. Gawong,  
 Office Cadastral Engineer.