

TOWNSHIP No. 30 SOUTH, RANGE No. 1 EAST, OF THE WILLAMETTE MERIDIAN, OREGON.

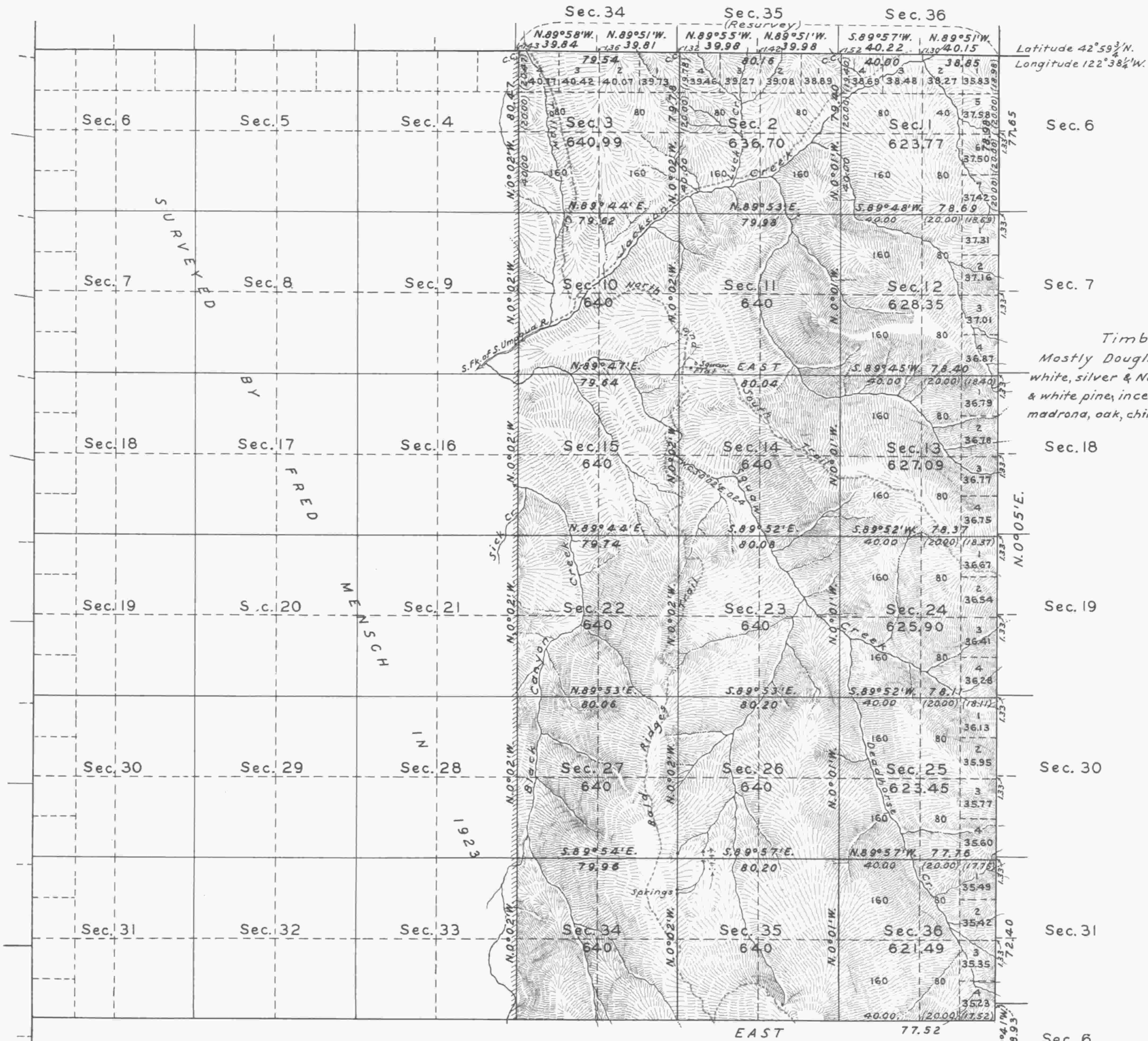

Scale: 40 Chains to an Inch.

Mean Magnetic Declination 21°15'E. Area Surveyed 11,427.74 Acres

| LINES DESIGNATED | BY WHOM SURVEYED | GROUP | | MILEAGE | | WHEN SURVEYED | |
|------------------|----------------------|-------|---------------|---------|-------|----------------|---------------|
| | | No. | DATE | MLS. | CHS. | BEGUN | COMPLETED |
| Exterior | Norman D. Price | | | 2 | 79.98 | | |
| Subdivisional | Leonard Carter | 175 | Nov. 21, 1935 | 26 | 70.03 | April 29, 1937 | Aug. 27, 1937 |
| Miscellaneous | George F. Dawson Jr. | | | | 6.92 | | |

Office of the Supervisor of Surveys,
Denver, Colorado, Oct. 31, 1938.
The above plat of Township No. 30 South, Range No. 1 East,
of the Willamette Meridian, Oregon, is strictly conformable
to the field notes of the survey thereof which have been
examined and approved.

Wm. J. Schenck
Supervisor of Surveys.

Sec. 6
UNITED STATES
DEPARTMENT OF THE INTERIOR
GENERAL LAND OFFICE
Washington, D.C., Mar. 17, 1939.
The survey represented by this plat
having been correctly executed in accordance
with the requirements of law and the regulations
of this office, is hereby accepted.

Arthur W. Funder
Assistant Commissioner.

112
1939