

Township No 29 South Range No 9 West of the Willamette Meridian Oregon.

1277

G f F e E d D c C b B a A

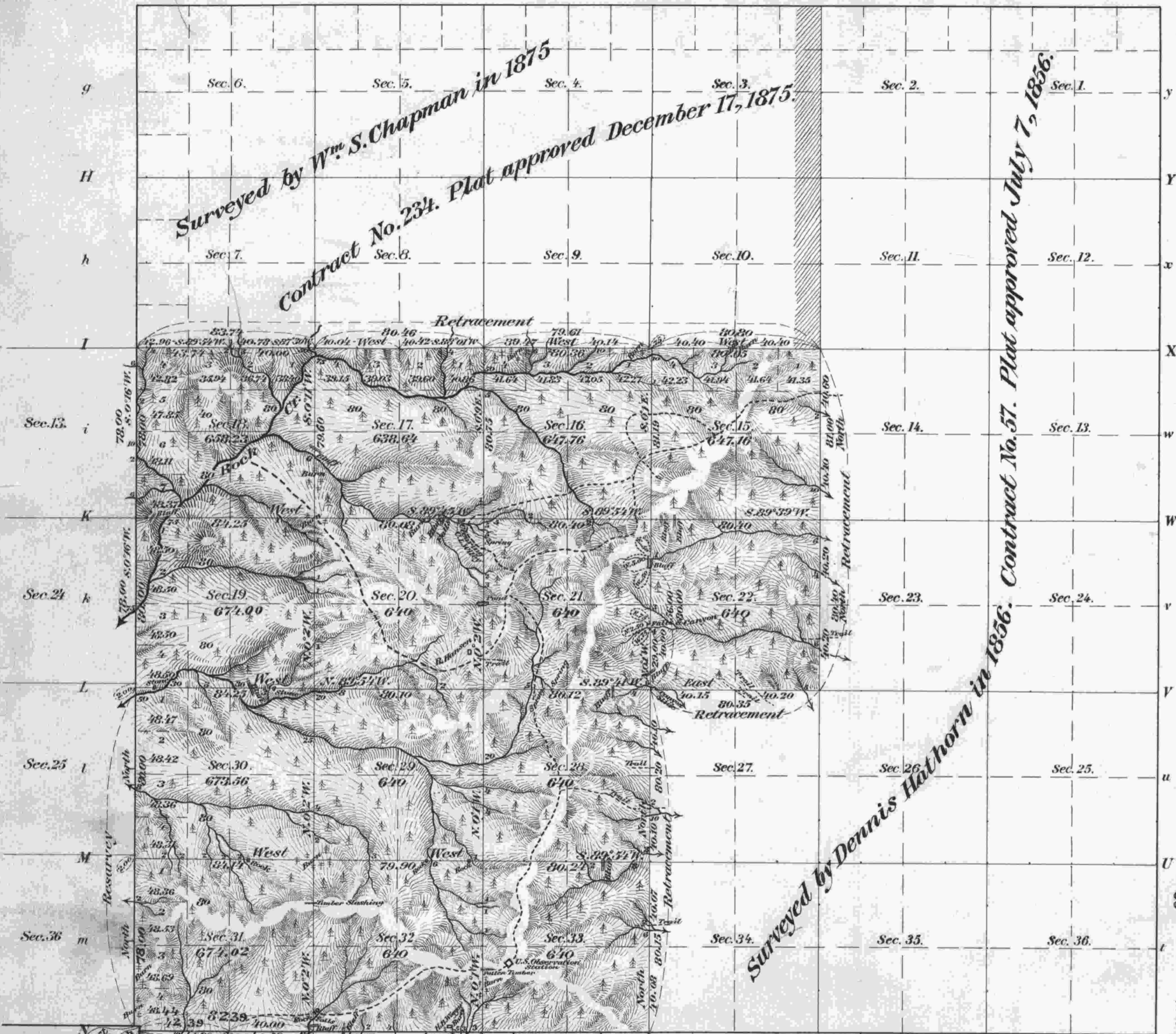

ACCEPTED BY THE HON. COMMISSIONER G. L. O. December 6, 1909

Meanders of								
Posts	Courses	Ch. ² Lk. ²	Posts	Courses	Ch. ² Lk. ²	Posts	Courses	Ch. ² Lk. ²
Deposited by the Oregon & California Railroad Company								
For Field Work			For Office Work		\$416.00	For Field Examination		80.00
					\$586.00			
Cost of Field Work			Cost of Office Work			Cost of Field Examination		
Amount Refunded								

Area of former surveys 17053.71 Acres. Area of New Surveys 8093.37 Acres. Total number of Acres 25147.08.

J.W.T.	R. 10 W	R. 9 W	Sec. 6	Sec. 5	Sec. 4	No. of Contract
	Surveys Designated		By Whom Surveyed	Date of Contract	Amount of Surveys M. Ch. ² Lk. ²	When Surveyed
	Township lines W. Bdy. of Secs. 18 & 19 Subdivisions		Wm. M. Porter.	March 8, 1907.	20 15 42	June 3 to 24, 1907.
	Connections		" " "	" " "	04 75	768
	Retracement of S. Bdy. of Secs. 30, 32 & 33 and Resurvey of the W. Bdy. of Secs. 30 & 31		" " "	" " "	5 06 35	Special Instructions dated June 5 th 1907, in connection with Cont. No. 768.
	Retracements of Subdivisions W. Bdy. of Secs. 30 & 31.		Wm. P. Wright.	July 12, 1880.	9 06 71	June 26 to 30, 1907.
	S. Bdy. of Secs. 3, 5 & 6 and W. Bdy. of Secs. 6 & 7		Wm. S. Chapman.	June 24, 1875.		1880.
	South and West end part of North Bdy.		Dennis Hathorn.	April 12, 1855.		1875.
						1890.
						57

The above Map of Township No 29 South of Range No 9 West of the Willamette Meridian Oregon is strictly conformable to the field notes of the survey thereof on file in this Office, which have been examined and approved.

Surveyor General's Office,
Portland, Oregon, March 19, 1909.

Geo. A. Vestgate
Sur. Gen. for Oregon

The above Map of Township No 29 South Range No 9 West of the Willamette Meridian Oregon, has been amended to conform to the Supplemental field notes of the Survey thereof on file in this Office, which have been examined and approved done by order of Hon. Commissioner's Letter E dated April 29, 1909.

Sur. Gen. (Office)
Portland, Oregon
October 3, 1909

Geo. A. Vestgate
Sur. Gen. for Oregon

Latitude 43° 03' N.
Longitude 123° 56' W.
Near Cor. of Secs. 19, 24, 25 & 30 on W. Bdy. of Tp.

