

TOWNSHIP No. 29 SOUTH, RANGE No. 5 WEST, OF THE WILLAMETTE MERIDIAN, OREGON.

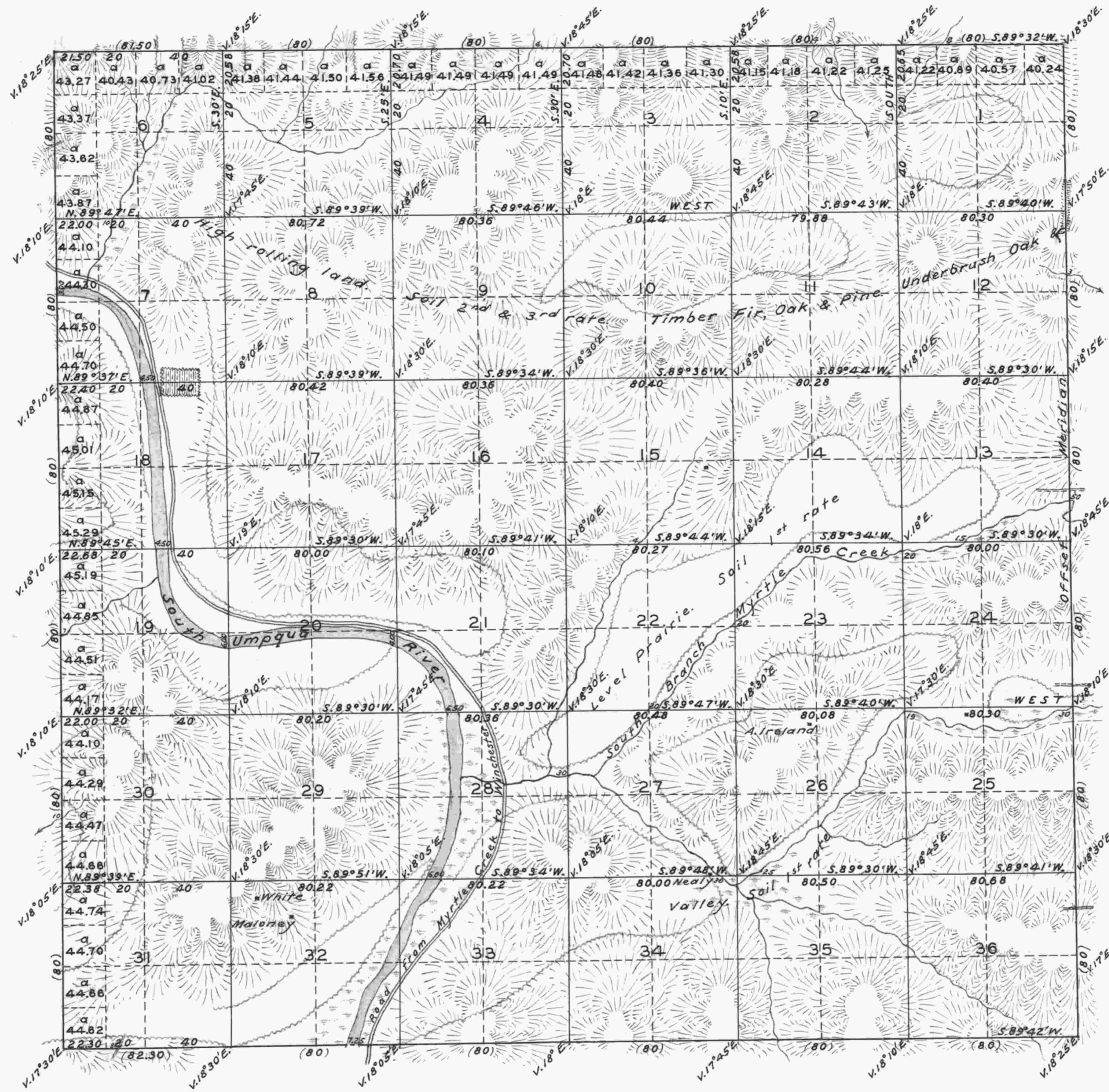

True Meridian  
Var. from 17° to 19° East

Scale: 40 chains to an inch

Surveys designated	By whom surveyed	Contract		Amt. of Surveys			When surveyed	When charged in the Sur. Gen's. Accounts
		No.	Date	Miles	chains	links		
Township Lines	Nathaniel Ford	44	May 30 <sup>th</sup> 1854	12	02	30	March 9 <sup>th</sup> 1855	1 <sup>st</sup> Qr. 1855.
Subdivisions	Nathaniel Ford	44	May 30 <sup>th</sup> 1854	60	22	20	March 9 <sup>th</sup> 1855	1 <sup>st</sup> Qr. 1855.
Total number of Acres		23,174.31						

The above Map of Township No. 29 South, of Range No. 5 West, of the Willamette Meridian, Territory of Oregon, is strictly conformable to the field notes of the survey thereof on file in this office which have been examined and approved.  
Surveyor General's Office,  
Salem, March 9<sup>th</sup> 1855. (signed) C.K. Gardner.  
Surv. Gen. of Oregon.

Public Survey Office,  
Portland, Oregon,  
October 9, 1946.

I certify this to be a correct copy of the original plat on file in this office.

Joseph A. Sanouy  
Regional Cadastral Engineer.

866 Copy