

TOWNSHIP N^o 29 SOUTH, RANGE N^o 4 EAST, OF THE WILLAMETTE MERIDIAN, OREGON.

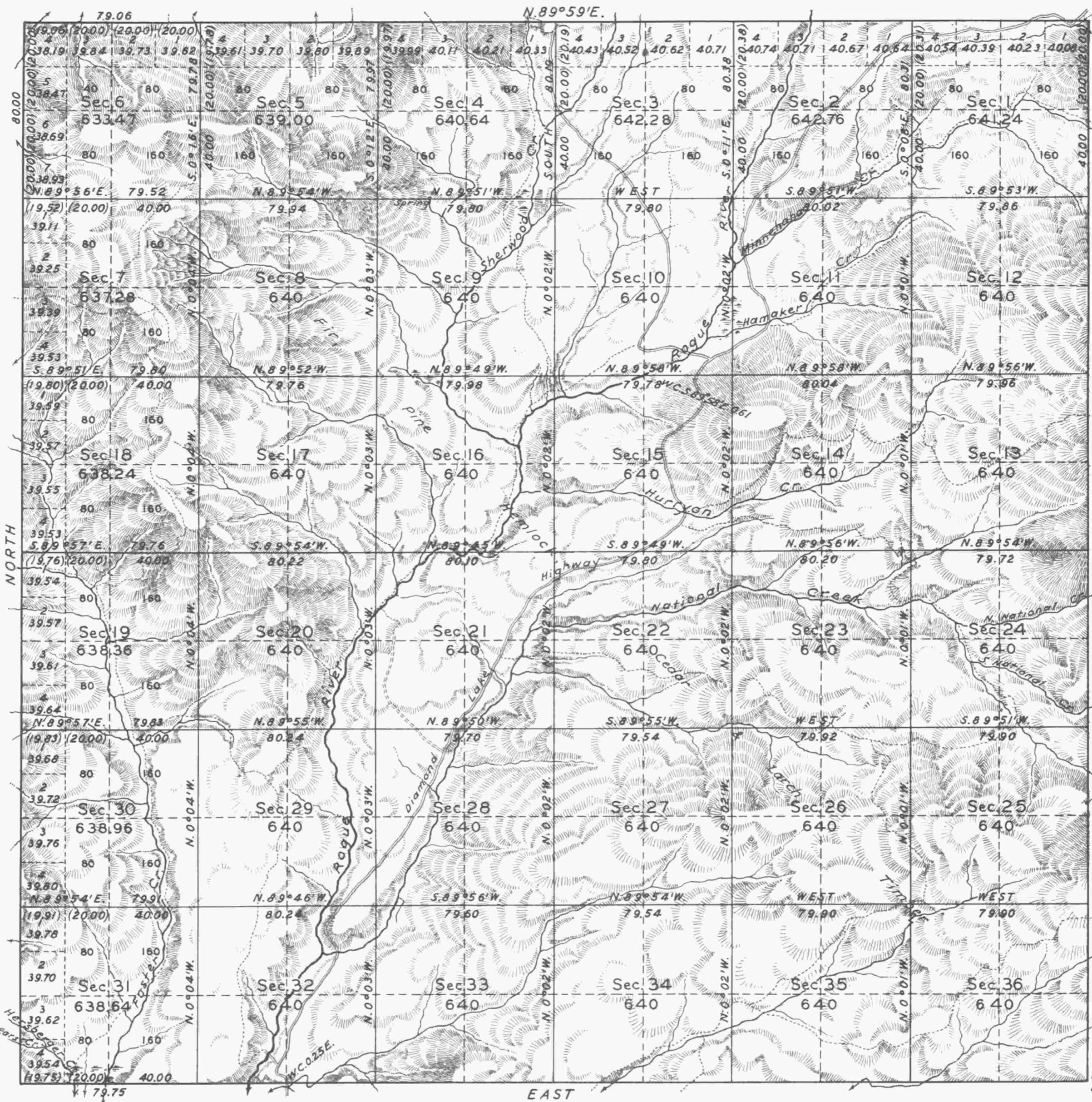

Mean Magnetic Declination 21°30'E. Scale: 40 Chains to an Inch. Area Surveyed 23,030.87 Acres.

LINES DESIGNATED	BY WHOM SURVEYED	GROUP N ^o	DATE	MILEAGE MLS. CHS.	WHEN SURVEYED BEGUN	WHEN SURVEYED COMPLETED
Exterior				11 79.06	July 8, 1930	Oct. 2, 1930
Subdivisional	Herbert N. Raymond	138	March 22, 1930	59 76.91	June 26, "	" " "
Miscellaneous						

Office of U.S. Supervisor of Surveys,
Denver, Colorado, October 6, 1931.
The above plat of Township N^o 29 South, Range N^o 4 East,
of the Willamette Meridian, Oregon, is strictly conformable
to the field notes of the survey thereof which have
been examined and approved.

William A. Johnson
U.S. Supervisor of Surveys.

DEPARTMENT OF THE INTERIOR
GENERAL LAND OFFICE
Washington, D.C., March 17, 1932
The survey represented by this plat
having been correctly executed in accordance
with the requirements of law and the regulations
of this office, is hereby accepted.

W. H. Stull
Assistant Commissioner.