

TOWNSHIP NO 29 SOUTH, RANGE NO 3 EAST OF THE WILLAMETTE MERIDIAN, OREGON.

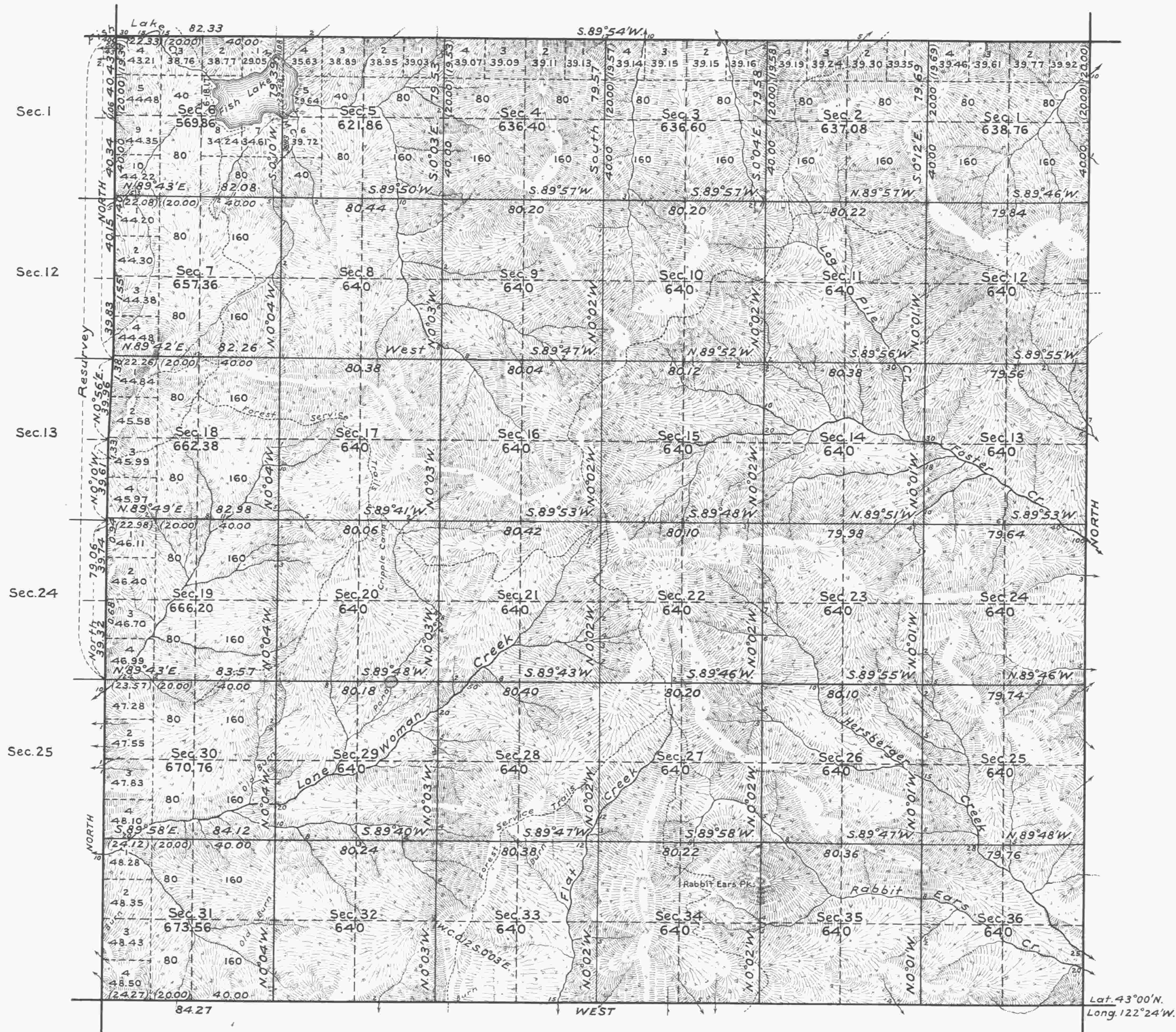

Mean Magnetic Declination, 20° E. Scale 40 Chains to an Inch. Area Surveyed, 23,070.82 Acres.

LINES DESIGNATED	BY WHOM SURVEYED	GROUP NO	DATE	MILEAGE		WHEN SURVEYED	
				MLS	CHS	BEGUN	COMPLETED
Exterior	Herbert N. Raymond U.S.C.E.	64	Dec. 27, 1920	22	5.98	June 13, 1927	Oct. 14, 1927
Subdivisional				60	15.93	" 18, "	" 6, "
Meander				1	64.72	Sept. 21, "	Sept. 25, "
Miscellaneous							

Office of U.S. Supervisor of Surveys
 Denver, Colorado, March 23, 1928.
 The above plat of Township No. 29 South, Range No. 3 East of the Willamette Meridian, Oregon, is strictly conformable to the field notes of the survey thereof which have been examined and approved.

Samuel Johnson
 U.S. Supervisor of Surveys

DEPARTMENT OF THE INTERIOR
 GENERAL LAND OFFICE
 Washington, D.C., April 17, 1928.
 The survey represented by this plat having been correctly executed in accordance with the requirements of law and the regulations of this office, is hereby accepted.

Blair Howell
 Assistant Commissioner

44
 10