

Township N^o 29 South Range N^o 1 East of the Willamette Meridian, Oregon.

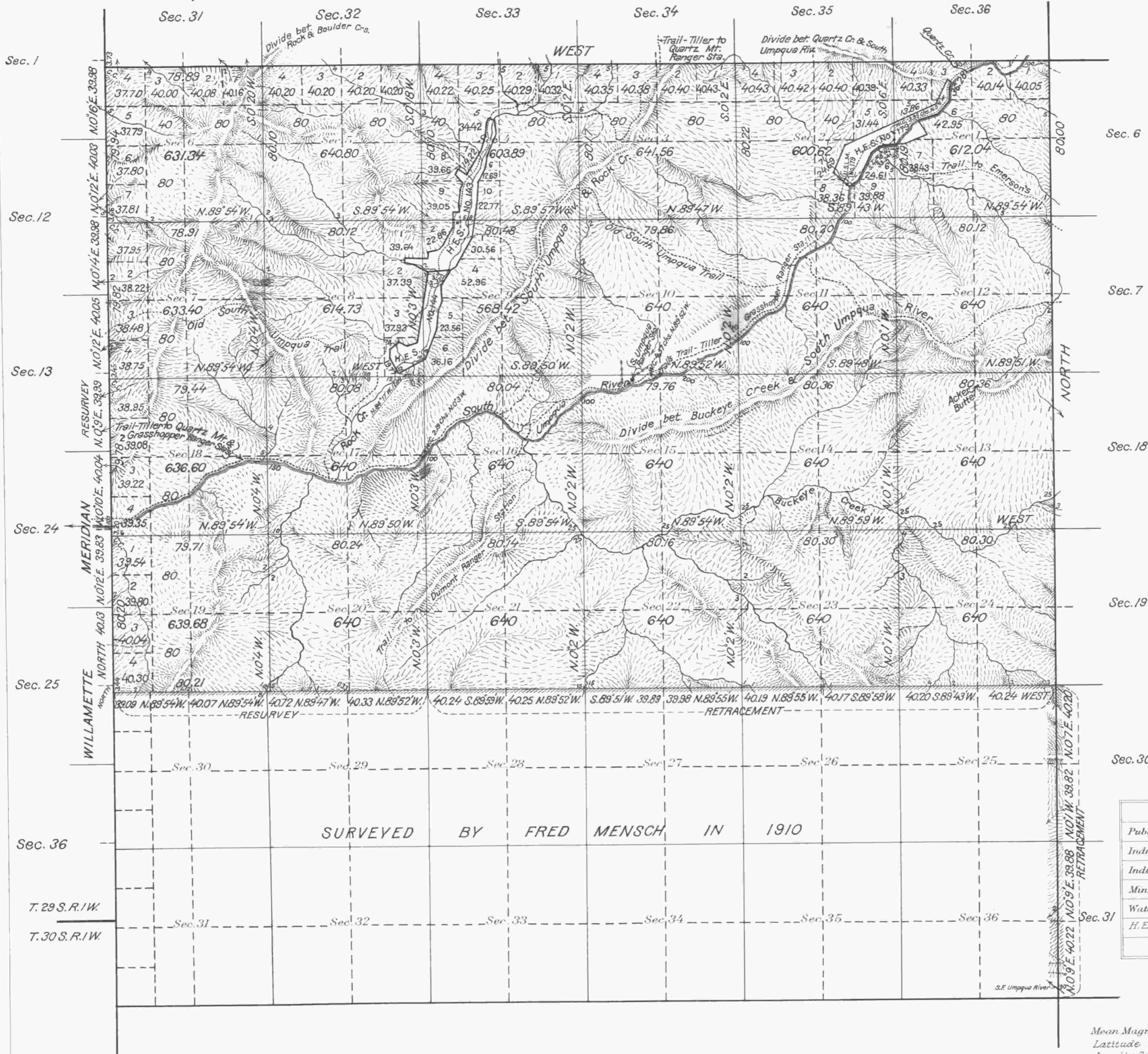

Areas in Acres	
Public Land	15143.08
Indian Reservation	
Indian Allotments	
Mineral Claims	
Water Surface	
H. E. Surveys	203.78
Total Area	15346.86

Scale 40 Chains to an inch

Mean Magnetic Declination 20° 40' E.
Latitude 43° 04' N. } 15 chs. W of 1/2 Sec. Cor. of Secs. 10 & 15.
Longitude 122° 41' W

Surveys Designated	By Whom Surveyed	Group		Amount of Surveys		When Surveyed	
		No.	Date	Mts.	chs.	Begun	Completed
Resur. portion W. Bay, or Will. Mer.	Fred Mensch	62	Dec. 21, 1920.	3	79 74	Nov. 3, 1921.	Nov. 25, 1921.
Sur. N. & E. & Subs	"	"	"	48	0 25	Sep. 23, "	" 24 "
Retract. & Resur. "	"	"	"	8	01 49	" " "	" 2 "
Connections	"	"	"	0	79 87	Oct. 14 "	" 24 "
W. Bay, or Will. Mer	"	under Contract	No.	797	in	1910	

The above map of Township No. 29 South Range No. 1 East of the Willamette Meridian Oregon is strictly conformable to the field notes of the survey thereof on file in this office, which have been examined and approved.

U. S. Surveyor General's Office.
Portland, Oregon September 14, 1922.

Wesley M. Cairness
Surveyor General of Oregon.