

# TOWNSHIP 28 SOUTH, RANGE 4 WEST, OF THE WILLAMETTE MERIDIAN, OREGON

## SUBDIVISION OF SECTION 18

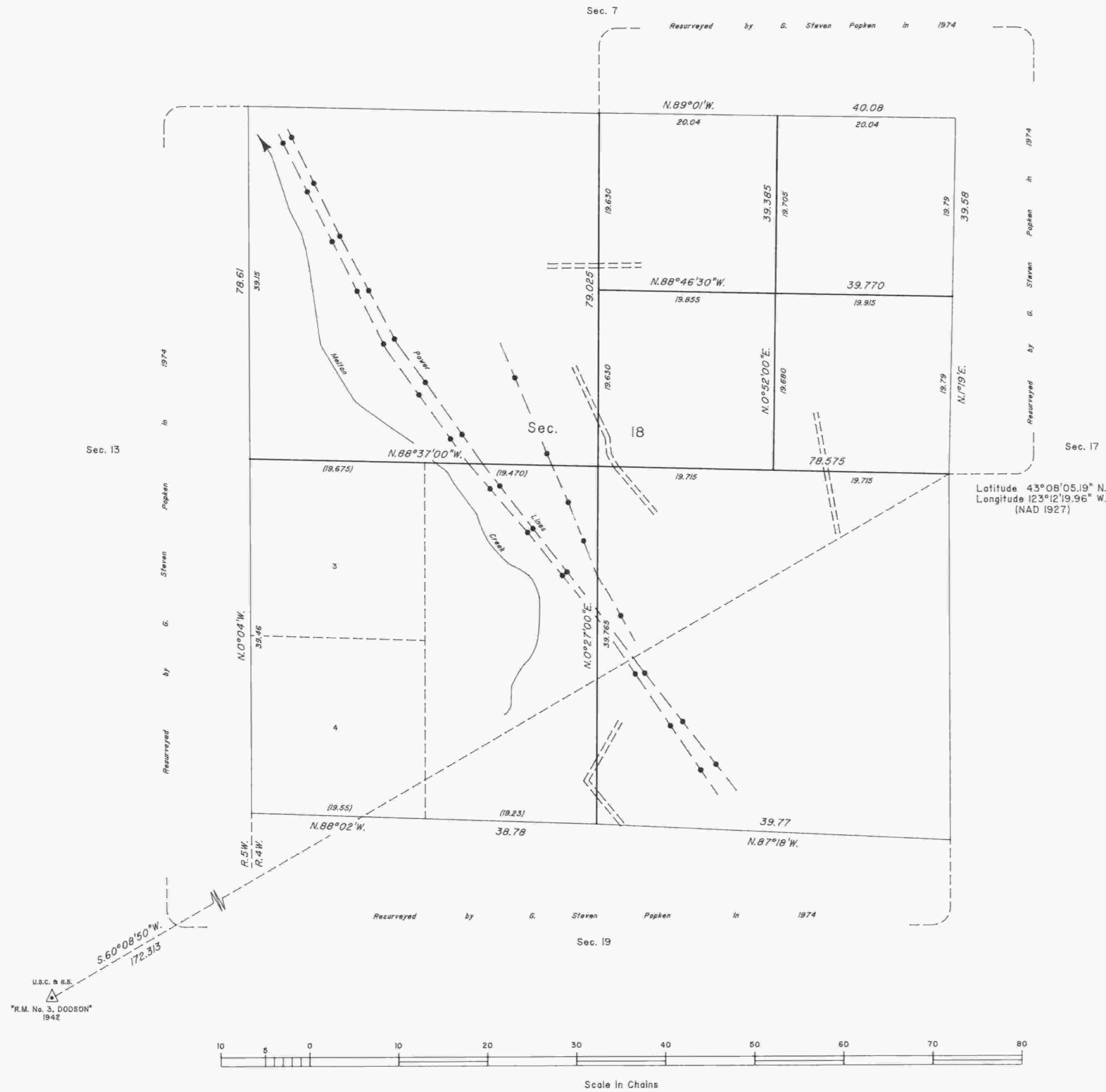
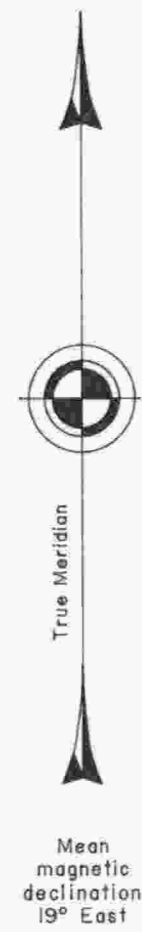

A history of surveys is contained in the field notes.

This plat represents the subdivision of section 18, T. 28 S., R. 4 W., Willamette Meridian, Oregon.

The lottings and areas are as shown on the plat approved August 11, 1881.

The survey was executed by Dale T. Bedell, Cadastral Surveyor, and Gerry L. Moore, Surveying Technician, beginning May 2, 1989, and completed May 30, 1989, pursuant to Special Instructions dated February 28, 1989, under Group Number 1479, Oregon.

Timber in this area consists of fir, hemlock, cedar, yew, oak and madrone.

UNITED STATES DEPARTMENT OF THE INTERIOR  
BUREAU OF LAND MANAGEMENT

Portland, Oregon                      September 18, 1992

This plat is strictly conformable to the approved field notes, and the survey, having been correctly executed in accordance with the requirements of law and the regulations of this Bureau, is hereby accepted.

For the Director

*Wayne M. Gardner*  
Chief Cadastral Surveyor of Oregon