

Township No. 28 South Range No. 3 West Willamette Meridian, Oregon.

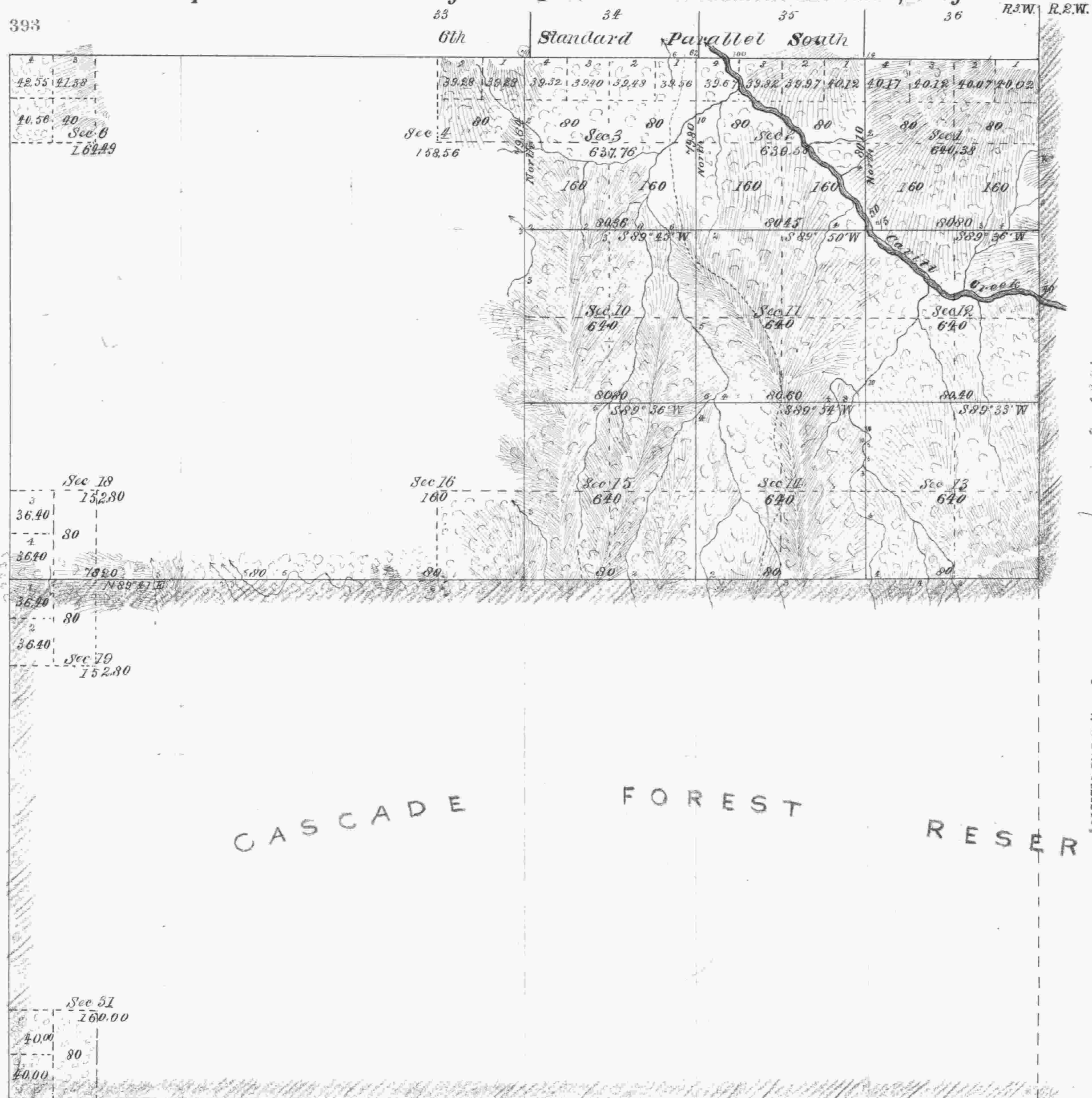

ACCEPTED BY THE HON. COMMISSIONER G. L. O. Jany 3. 1882

Total number of Acres 6,706.37

SURVEYS DESIGNATED.	BY WHOM SURVEYED.	NO.	DATE OF CONTRACT.	AMOUNT OF SURVEYS.			WHEN SURVEYED.	MEAN DECLINATION.
				Miles.	Chains.	Links.		
Township Lines	Samuel Flint	439	May 3 1882	3	00	00	Aug 30 to 31 1882	18° 45' E
Subdivisions	do do do	do	do do do	21	01	15	Sept 12 to Oct 28 1882	
Corrections	do do do	do	do do do		2	46		

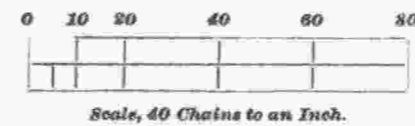

The above map of *Subdivisions* of Township No. 28 South of Range No. 3 West of the Willamette Meridian, Oregon, is strictly conformable to the Field Notes of the survey thereof on file in this office, which have been examined and approved.
 U. S. Surveyor-General's Office,
 Portland, Oregon,
 Dec. 7, 1882. James C. Tolman