

TOWNSHIP N^o 28 SOUTH, RANGE N^o 2 EAST OF THE WILLAMETTE MERIDIAN, OREGON.

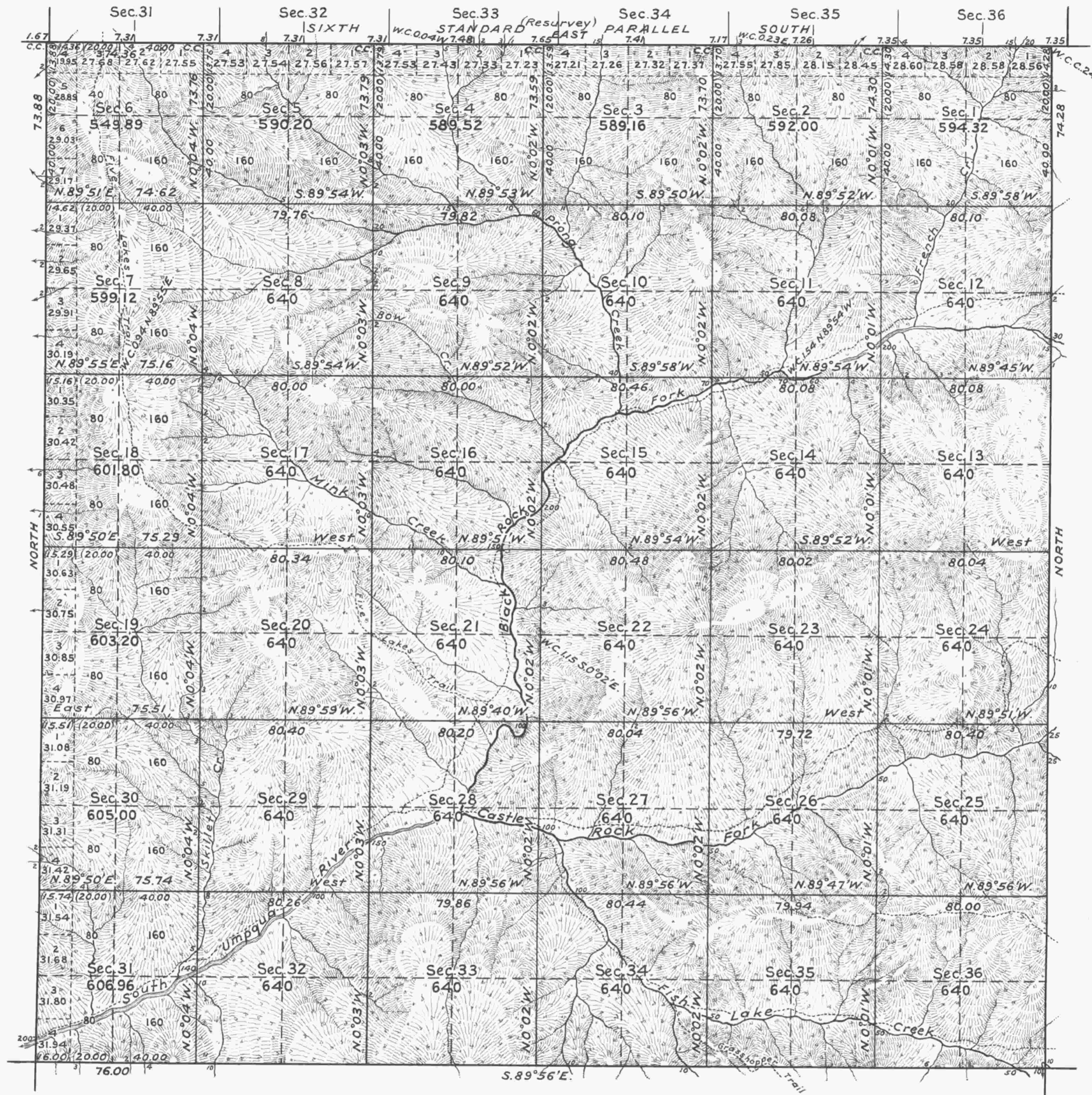

Lat. 43°05'N. } Near $\frac{1}{4}$ Cor. of Secs. 27 & 34, T.28 S., R.2 E.
 Long. 122°33'W.

Mean Magnetic Declination, 20 $\frac{1}{2}$ ' E. Scale: 40 Chains to an Inch. Area Surveyed, 22,521.17 Acres

LINES DESIGNATED	BY WHOM SURVEYED	No	GROUP DATE	MILEAGE		WHEN SURVEYED	
				MLS	CHS	BEGUN	COMPLETED
Exterior	Lincoln E. Wilkes	62	Dec. 21, 1920	17	68.16	Sept. 7, 1926	Aug. 12, 1927
Subdivisional				59	28.18	" 9, "	" 13, "
Meander							
Miscellaneous				45.81		July 6, 1927	" 10, "

Office of U.S. Supervisor of Surveys
 Denver, Colorado, Nov. 13, 1928.
 The above plot of Township No. 28 South, Range No. 2 East of the Willamette Meridian, Oregon, is strictly conformable to the field notes of the survey thereof which have been examined and approved.

Lincoln E. Wilkes
 U.S. Supervisor of Surveys.

DEPARTMENT OF THE INTERIOR
 GENERAL LAND OFFICE
 Washington, D.C., February 19, 1929
 The survey represented by this plat having been correctly executed in accordance with the requirements of law and the regulations of this office, is hereby accepted.

Wm. C. Howell
 Assistant Commissioner.

G.R.V. 1920