

TOWNSHIP NO 28 SOUTH, RANGE NO 1 EAST OF THE WILLAMETTE MERIDIAN, OREGON.

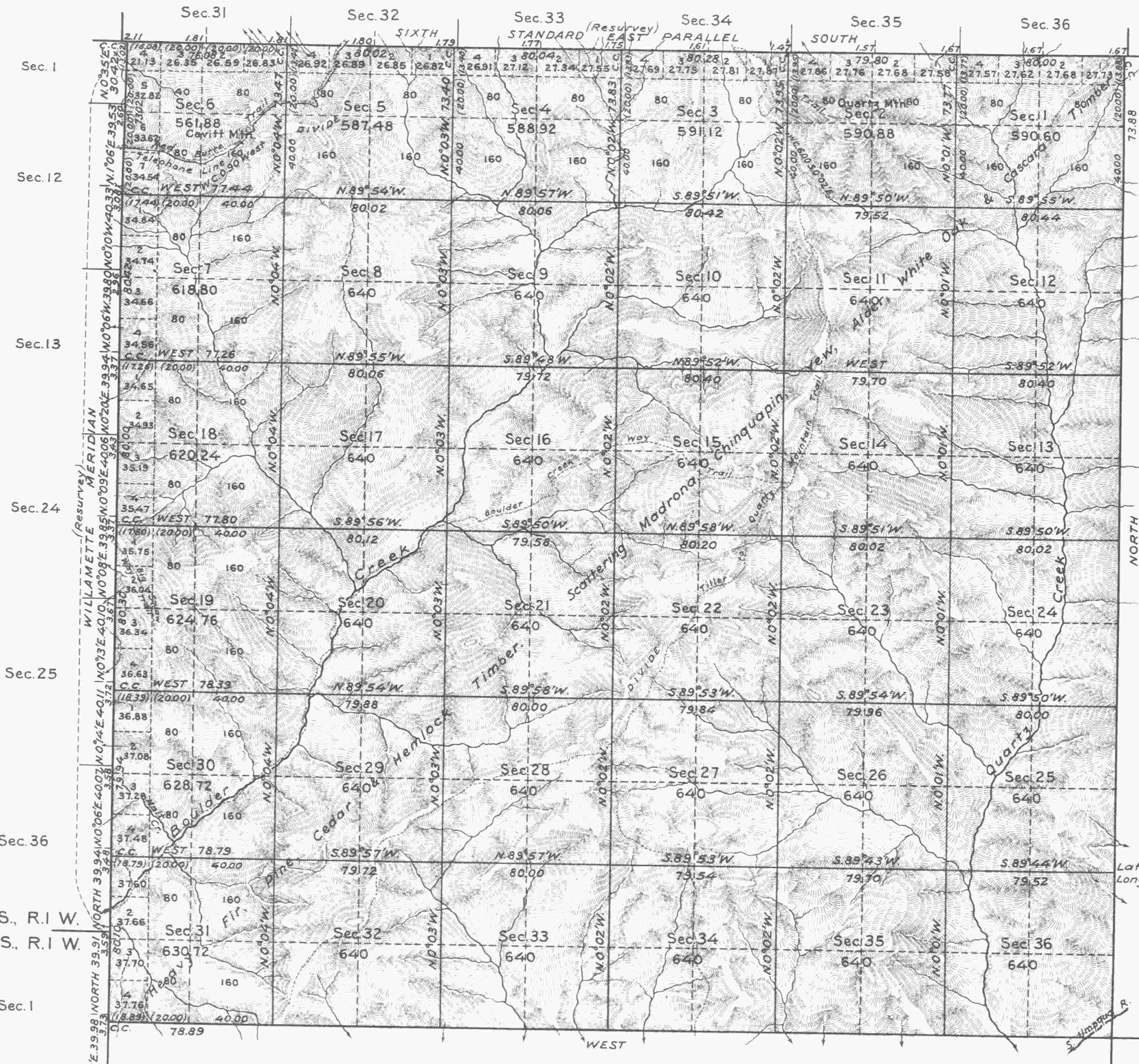

Note
Most of this township is covered with a dense growth of vine maple, madrona, rhododendron, chinquapin, manzanita, hazel, poison oak and snow brush.

Lat. 43° 06' N.
Long. 122° 39' W.

Mean Magnetic Declination, 21 1/2° E. Scale 40 Chains to an Inch. Area Surveyed, 22,634.12 Acres.

LINES DESIGNATED BY WHOM SURVEYED		GROUP NO	DATE	MILEAGE MLS CHS	WHEN SURVEYED BEGUN COMPLETED	
Exterior				11 30.15	July 29, 1927	Oct. 9, 1928
Subdivisional	Lincoln E. Wilkes			59 36.94	June 2, "	" 6, "
Meander	Otto L. Draper	62	Dec. 21, 1920			
Miscellaneous	Norman D. Price			24.42	Aug. 29, "	" 9, "

Office of U.S. Supervisor of Surveys
Denver, Colorado, Dec. 10, 1928.
The above plat of Township No 28 South, Range No. 1 East of the Willamette Meridian, Oregon, is strictly conformable to the field notes of the survey thereof which have been examined and approved.

Samuel Johnson
U.S. Supervisor of Surveys

DEPARTMENT OF THE INTERIOR
GENERAL LAND OFFICE

Washington, D. C., December 20, 1928.
The survey represented by this plat having been correctly executed in accordance with the requirements of law and the regulations of this office, is hereby accepted.

Wm. C. Howell
Assistant Commissioner

644
30