

TOWNSHIP 27 SOUTH, RANGE 5 EAST, OF THE WILLAMETTE MERIDIAN, OREGON

AMENDED PROTRACTION DIAGRAM FILE 17, UNIT 35

UNSURVEYED

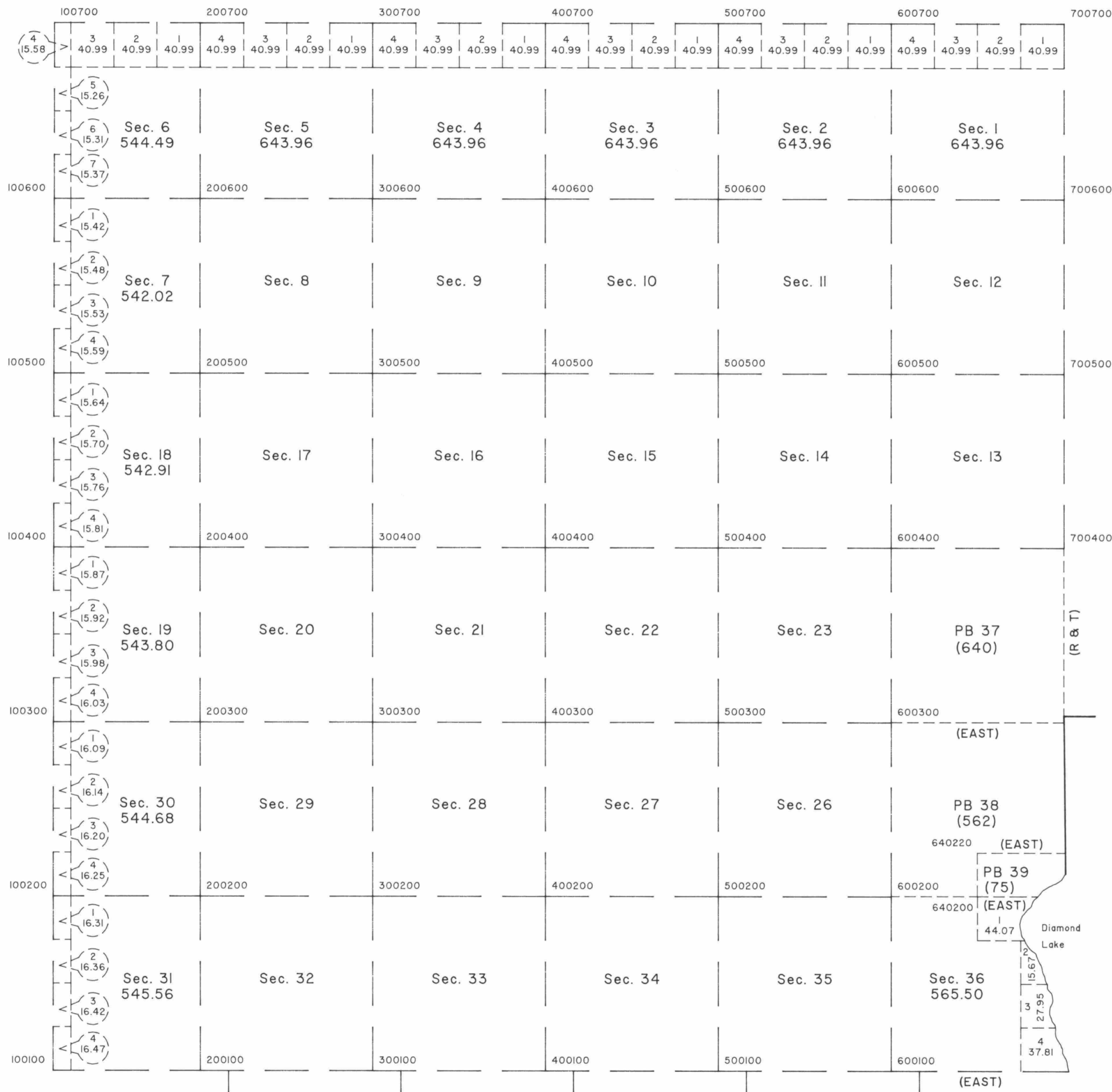

————— Surveyed Lines
 - - - - - Protracted Lines
 ———— Reliable Protracted Lines
 R & T Random and True

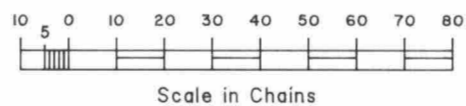

This amended protraction diagram was prepared for the express purpose of describing unsurveyed public land. It does not constitute an official survey but establishes the plan for extending the rectangular survey system over these unsurveyed lands and may be used for leasing and administrative purposes only.

The actual area of protracted blocks (PB) shown on this diagram may vary due to the reliability of the survey information used to determine the positions of existing surveyed boundaries. A protracted block cannot be subdivided without an official survey. Unless otherwise shown, each unsurveyed section designated Sec. on the diagram contains 640 acres. The sections and lots on this diagram depict how the area may be surveyed; but until that time they will continue to be unsurveyed lands. Data shown in parentheses () is proposed information for the plan of survey and is subject to change.

This amended protraction diagram officially supersedes the existing protraction for this area, except where existing rights or administrative actions based upon the existing protraction are not adequately protected.

Latitudes and longitudes were computed to portray standard protracted sections using an elevation of 4000 feet for this township.

Point ID	NAD 1983 Latitude	Longitude
100100	43° 10' 09.3819"	122° 16' 57.1416"
100200	43° 11' 01.5218"	122° 16' 57.1416"
100300	43° 11' 53.6615"	122° 16' 57.1416"
100400	43° 12' 45.8012"	122° 16' 57.1416"
100500	43° 13' 37.9406"	122° 16' 57.1416"
100600	43° 14' 30.0800"	122° 16' 57.1416"
100700	43° 15' 22.5432"	122° 16' 57.1416"
200100	43° 10' 09.3819"	122° 15' 56.3688"
200200	43° 11' 01.5218"	122° 15' 56.4529"
200300	43° 11' 53.6615"	122° 15' 56.5372"
200400	43° 12' 45.8012"	122° 15' 56.6215"
200500	43° 13' 37.9406"	122° 15' 56.7059"
200600	43° 14' 30.0800"	122° 15' 56.7903"
200700	43° 15' 22.5432"	122° 15' 56.8753"
300100	43° 10' 09.3819"	122° 14' 45.1345"
300200	43° 11' 01.5218"	122° 14' 45.2018"
300300	43° 11' 53.6615"	122° 14' 45.2692"
300400	43° 12' 45.8012"	122° 14' 45.3367"
300500	43° 13' 37.9406"	122° 14' 45.4042"
300600	43° 14' 30.0800"	122° 14' 45.4717"
300700	43° 15' 22.5432"	122° 14' 45.5397"
400100	43° 10' 09.3819"	122° 13' 33.9002"
400200	43° 11' 01.5218"	122° 13' 33.9507"
400300	43° 11' 53.6615"	122° 13' 34.0013"
400400	43° 12' 45.8012"	122° 13' 34.0519"
400500	43° 13' 37.9406"	122° 13' 34.1025"
400600	43° 14' 30.0800"	122° 13' 34.1531"
400700	43° 15' 22.5432"	122° 13' 34.2042"
500100	43° 10' 09.3819"	122° 12' 22.6659"
500200	43° 11' 01.5218"	122° 12' 22.6996"
500300	43° 11' 53.6615"	122° 12' 22.7333"
500400	43° 12' 45.8012"	122° 12' 22.7670"
500500	43° 13' 37.9406"	122° 12' 22.8008"
500600	43° 14' 30.0800"	122° 12' 22.8345"
500700	43° 15' 22.5432"	122° 12' 22.8686"
600100	43° 10' 09.3819"	122° 11' 11.4316"
600200	43° 11' 01.5218"	122° 11' 11.4485"
600300	43° 11' 53.6615"	122° 11' 11.4653"
600400	43° 12' 45.8012"	122° 11' 11.4822"
600500	43° 13' 37.9406"	122° 11' 11.4991"
600600	43° 14' 30.0800"	122° 11' 11.5160"
600700	43° 15' 22.5432"	122° 11' 11.5330"
640200	43° 11' 01.5218"	122° 10' 35.8229"
640220	43° 11' 14.5567"	122° 10' 35.8250"
700400	43° 12' 45.8012"	122° 10' 00.1974"
700500	43° 13' 37.9406"	122° 10' 00.1974"
700600	43° 14' 30.0800"	122° 10' 00.1974"
700700	43° 15' 22.5432"	122° 10' 00.1974"

UNITED STATES DEPARTMENT OF THE BUREAU OF LAND MANAGEMENT

Portland, Oregon November 15, 1996

This diagram represents the official protraction of the rectangular system of surveys and is hereby accepted.

For the Director
Wayne M. Gardner
 Chief Cadastral Surveyor of Oregon