

Township N^o 27 South Range N^o 5 West Willamette Meridian.

677

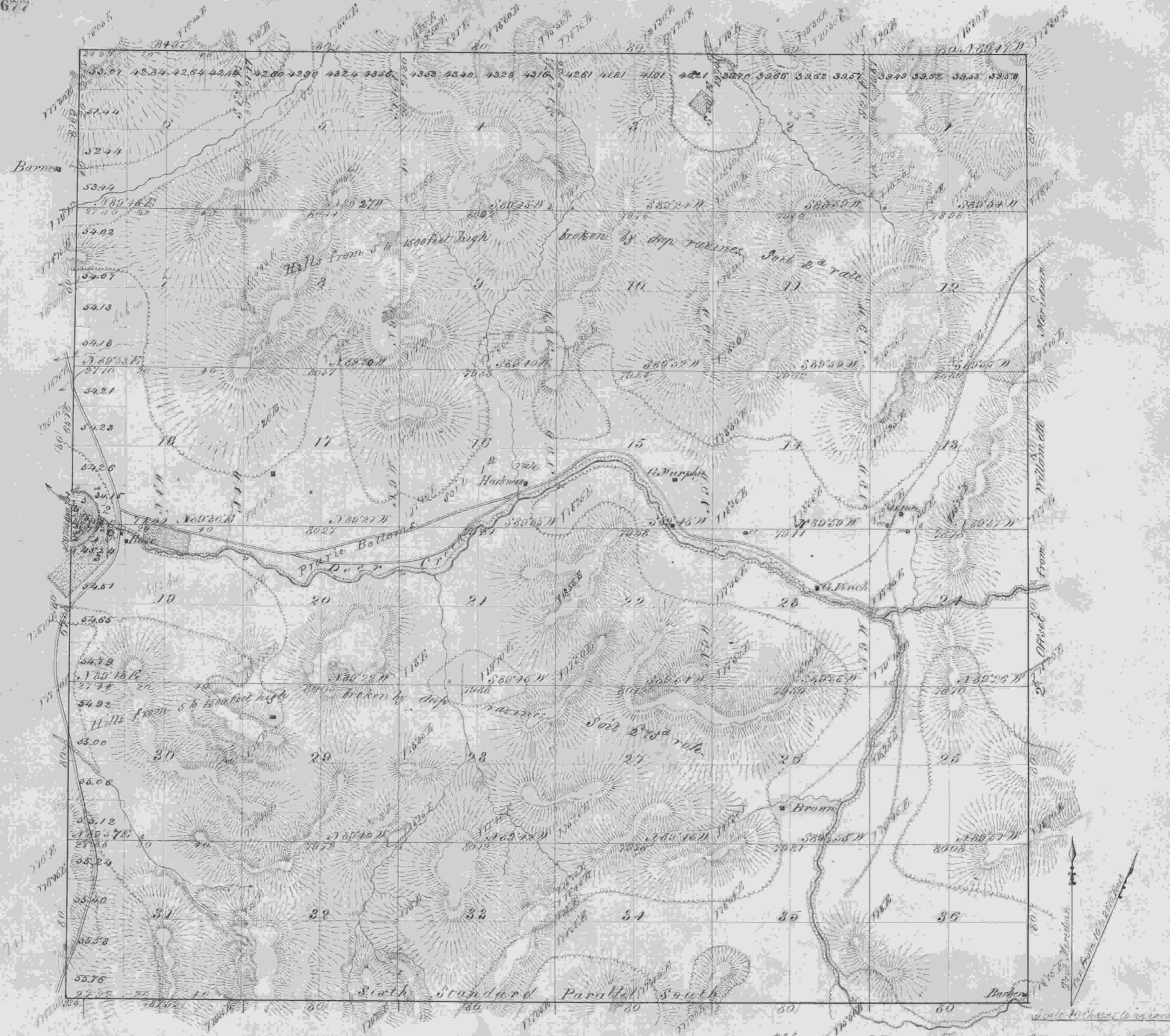

Surveys designated	By whom surveyed	Contract		Amount of survey		When charged into Sur. Gen. Account
		Date	Miles	Chains	Links	
Township lines	Elder & Gile	31 April 7 th 1853	6	01	59	September 1853 3 ^d Quarter 1853
Subdivisions	Elder & Gile	31 April 7 th 1853	60	33	43	September 1853 3 ^d Quarter 1853
Re-surveying 6 th Parallel	"	"	6	07	92	"
Meanders	"	"		72	16	"

The above Map of Township N^o 27 South of Range N^o 5 West of the Willamette Meridian, Territory of Oregon, is strictly conformable to the field notes of the Survey thereof on file, in this office which have been examined and approved.

Surveyor General's Office
 Carson City, Sept. 4th 1853

M. B. Weston
 Sur. Gen.