

TOWNSHIP N^o 27 SOUTH, RANGE N^o 3 EAST, OF THE WILLAMETTE MERIDIAN, OREGON.

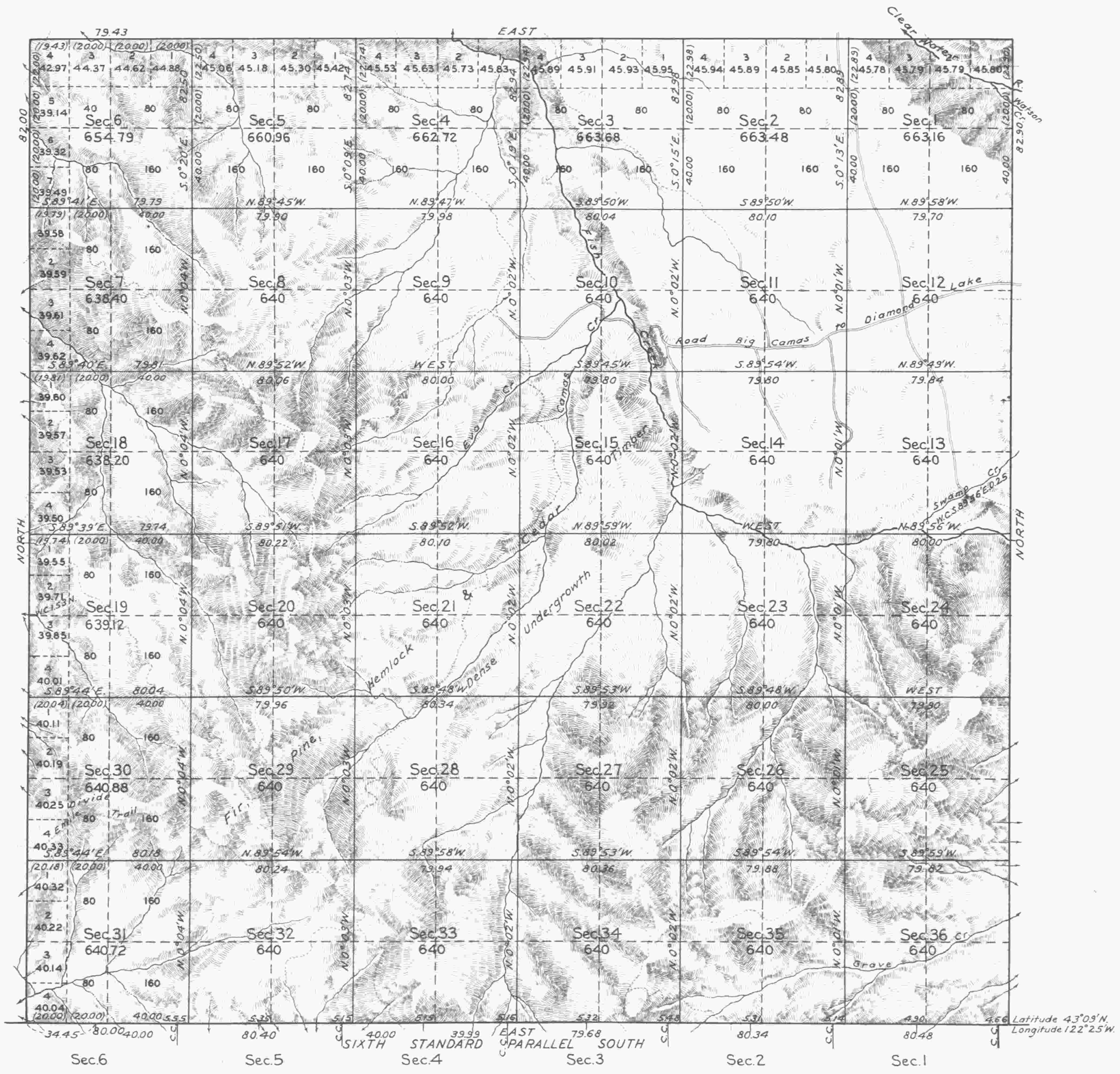

Mean Magnetic Declination 20°30'E. Scale: 40 Chains to an Inch. Area Surveyed 23,166.11 Acres.

LINES DESIGNATED	BY WHOM SURVEYED	GROUP N ^o	DATE	MILEAGE MLS. CHS.	WHEN SURVEYED BEGUN	WHEN SURVEYED COMPLETED
Exterior	Herbert N. Raymond	64	Dec. 27, 1920	12 2.33	Aug. 16, 1929	July 30, 1930
Subdivisional				60 13.33	" 18, "	Aug 7, "

Office of U.S. Supervisor of Surveys,
 Denver, Colorado, June 29, 1931
 The above plat of Township N° 27 South, Range N° 3 East, of the Willamette Meridian, Oregon, is strictly conformable to the field notes of the survey thereof which have been examined and approved.

Wm. P. Johnson
 U.S. Supervisor of Surveys.

DEPARTMENT OF THE INTERIOR
 GENERAL LAND OFFICE
 Washington, D.C., Sept. 19, 1931
 The survey represented by this plat having been correctly executed in accordance with the requirements of law and the regulations of this office, is hereby accepted.

J. K. Gandy
 Acting Assistant Commissioner.

RM
 10