

TOWNSHIP 27 SOUTH, RANGE 1 WEST, OF THE WILLAMETTE MERIDIAN, OREGON.

CORRECTIVE DEPENDENT RESURVEY

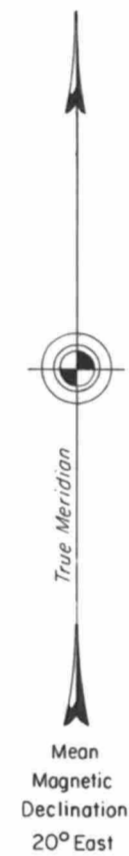

Sec. 13

Sec. 18

Sec. 17

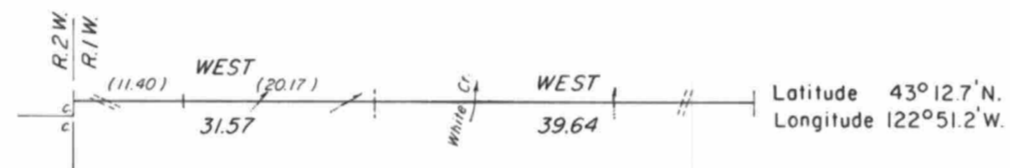

Sec. 24

Sec. 19

Sec. 20

A history of surveys is contained in the field notes.

This plat represents a corrective dependent resurvey of a portion of the subdivisional lines designed to restore the corners in their true original locations according to the best available evidence, T. 27 S., R. 1 W., Willamette Meridian, Oregon.

The west boundary of the township was surveyed by Samuel C. Flint, in 1882.

The west boundary was retraced or resurveyed and the subdivisional lines were surveyed by Homer D. Angell, in 1902.

A portion of the west boundary was retraced by Morris Wygant under the supervision of Zachariah M. Derrick, in 1911.

A portion of the subdivisional lines, including the line between sections 18 and 19, was resurveyed by Jasper M. Sams and Donevan C. Harris, in 1971. The notes were approved and the plat accepted December 29, 1972. Subsequent to this acceptance, the position of the 1/4 section corner of sections 18 and 19, monumented by Sams and Harris, was protested. An investigation disclosed evidence of the original corner position, the recovery of which affects the bearing and distance of the line between sections 18 and 19.

Corrective resurvey executed by Wayne L. Rogers, June 19, 1980, pursuant to Special Instructions dated June 23, 1971, and Supplemental Special Instructions dated May 29, 1980, for Group No. 747, Oregon.

UNITED STATES DEPARTMENT OF THE INTERIOR  
BUREAU OF LAND MANAGEMENT  
Denver, Colorado      October 30, 1981

This plat is strictly conformable to the approved field notes, and the survey, having been correctly executed in accordance with the requirements of law and the regulations of this Bureau, is hereby accepted.

For the Director

*Gary T. Oviatt*

Acting Chief, Cadastral Survey  
Examination and Approval Staff

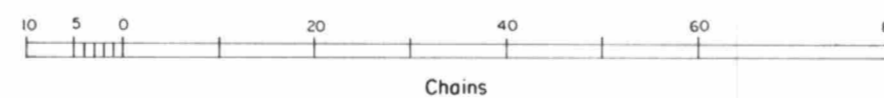

Timber in this area consists of fir, hemlock, cedar, pine, madrone, maple, dogwood, and oak.