

TOWNSHIP 26 SOUTH, RANGE 8 WEST, OF THE WILLAMETTE MERIDIAN, OREGON.

DEPENDENT RESURVEY

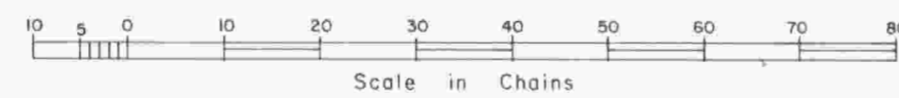
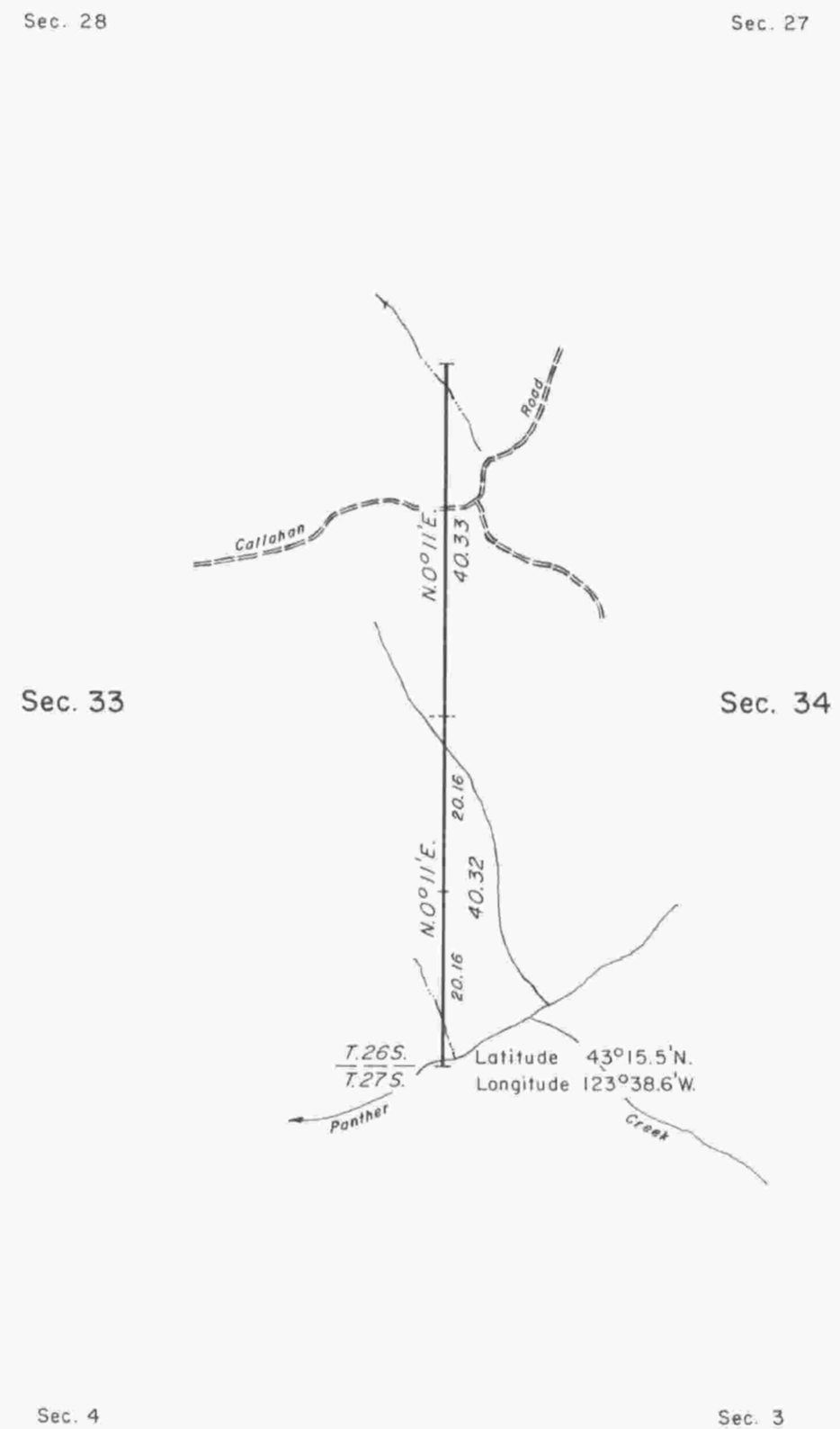

A history of surveys is contained in the field notes.

This plat represents a dependent resurvey of a portion of the subdivisional lines, T. 26 S., R. 8 W., Willamette Meridian, Oregon, designed to restore the corners in their true original locations according to the best available evidence.

The resurvey is based on the plats approved September 10, 1897 and October 29, 1898.

The survey was executed by John P. Farnsworth, Cadastral Surveyor, beginning June 25, 1981 and completed July 20, 1981, pursuant to Special Instructions dated May 12, 1981, for Group No. 1065, Oregon.

Timber in this area consists of fir, cedar, and hemlock, with lesser stands of alder, maple, madrone, tan oak, and yew.

UNITED STATES DEPARTMENT OF THE INTERIOR  
BUREAU OF LAND MANAGEMENT  
Portland, Oregon November 16, 1983

This plat is strictly conformable to the approved field notes, and the survey, having been correctly executed in accordance with the requirements of law and the regulations of this Bureau, is hereby accepted.

For the Director

*William W. Glenn*

Chief Cadastral Surveyor of Oregon