

Township No. 26 South Range No. 7 West Willamette Meridian, Oregon.

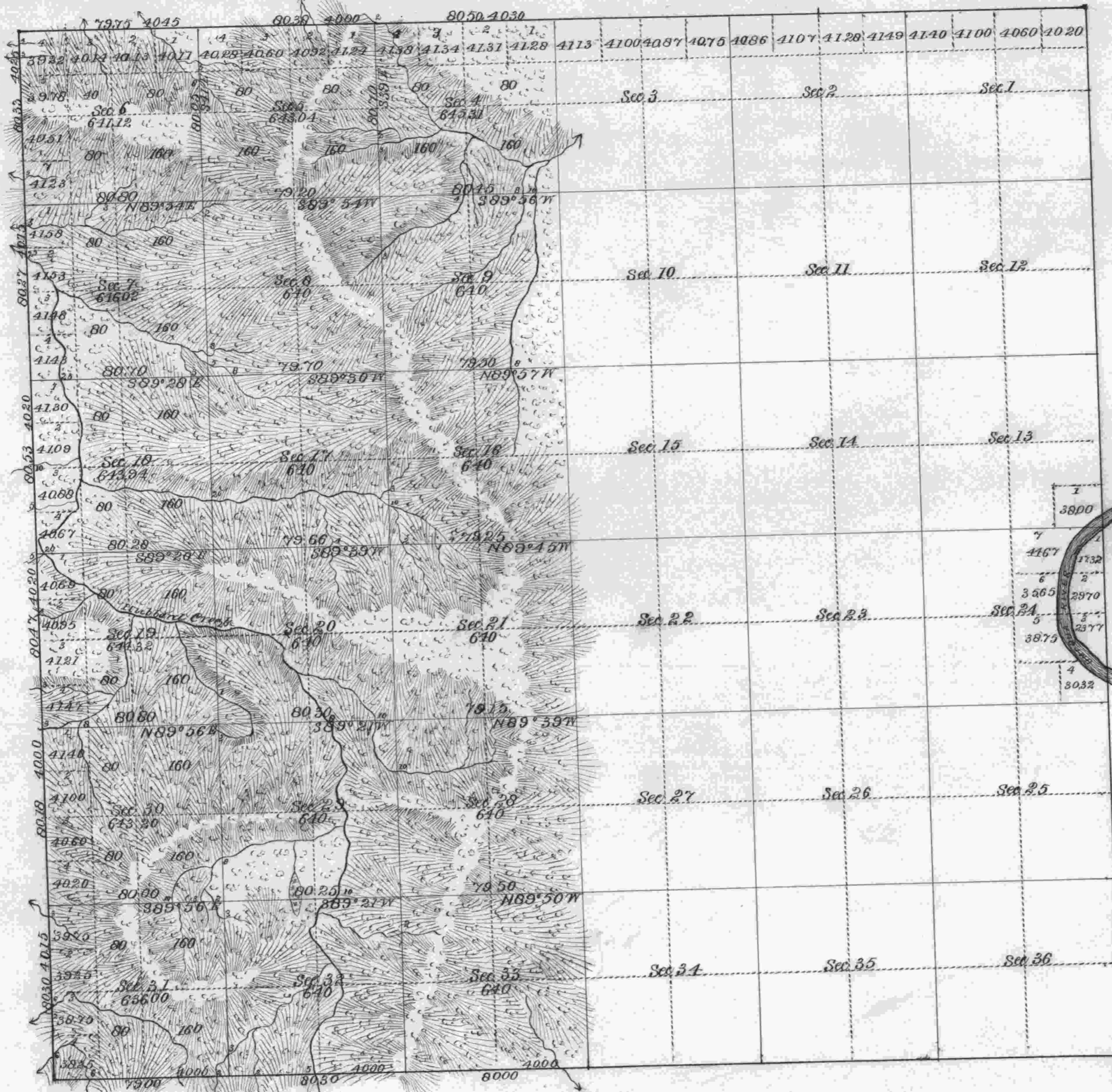

1	3800
2	4167
3	1732
4	3265
5	2970
6	3879
7	2377
8	3032

Area of New Survey 11,222.95 Acres, Area of Former Survey 11,789.83 Total number of Acres 23,012.28

SURVEYS DESIGNATED.	BY WHOM SURVEYED.	NO.	DATE OF CONTRACT.	AMOUNT OF SURVEYS.			WHEN SURVEYED.	MEAN DECLINATION.
				Miles.	Chains.	Links.		
Township Lines	Dennis Hathorn	57	April 12 1853				July 1856	19° 15' E.
Subdivisions	J. Rand S.C. Flint	392	May 26 1881	27	00	29	July 18 to Aug 2 1881	
Retracings	do do do do	do	do do do	12	02	02		

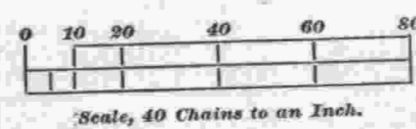

The above Map of the Subdivisions of Township No. 26 South of Range No. 7 West of the Willamette Meridian, Oregon, is strictly conformable to the Field Notes of the survey thereof on file in this Office, which have been examined and approved.

U. S. Surveyor-General's Office,  
Portland, Oregon,

Jan 14, 1882. James C. Tolman  
Surveyor-General of Oregon.