

Township N° 26 & 27 South, Range N° 6 West of the Willamette Meridian, Oregon.

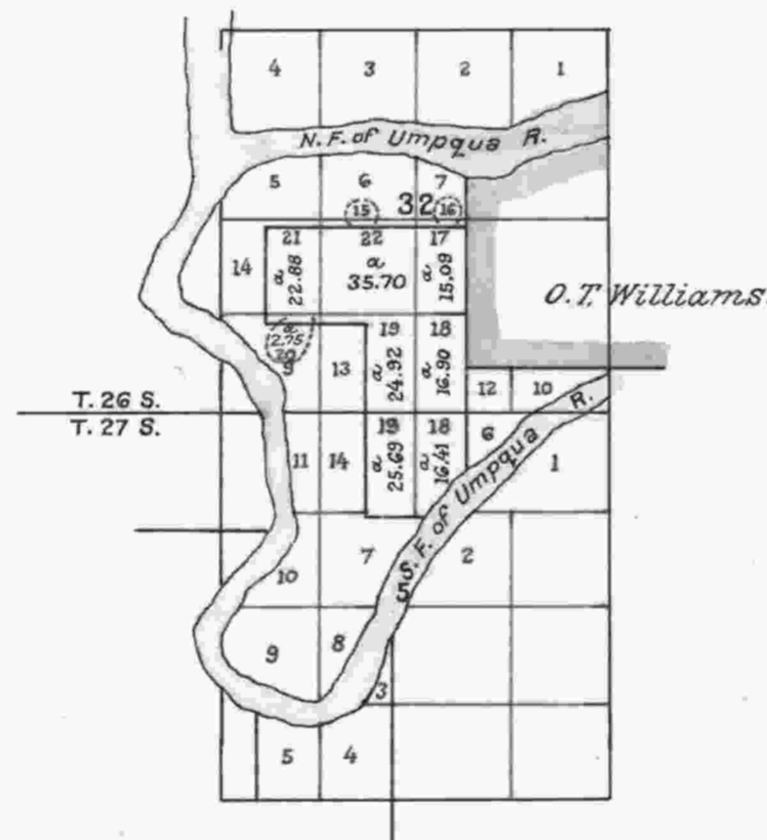

The above Map or Special plat showing the lottings and acreage consequent upon the cancellation of the donation land claim of R.A. Williams Cl. No. 56 in T. 26 S. R. 6 W. and Cl. No. 38 in T. 27 S., R. 6 W. Will. Mer. Or. is correct.

*U.S. Surveyor General's Office.
Portland, Oregon May 4th, 1878.*

*Ben Simpson
Sur. Gen. of Oregon.*

I certify this to be a correct copy of the original Plat on file in this Office.

*U.S. Surveyor General's Office
Portland, Oregon September 20, 1913.*

*Edward Seworth
Surveyor General of Oregon.*