

Township No 26 South Range No 5 West Willamette Mer.

675

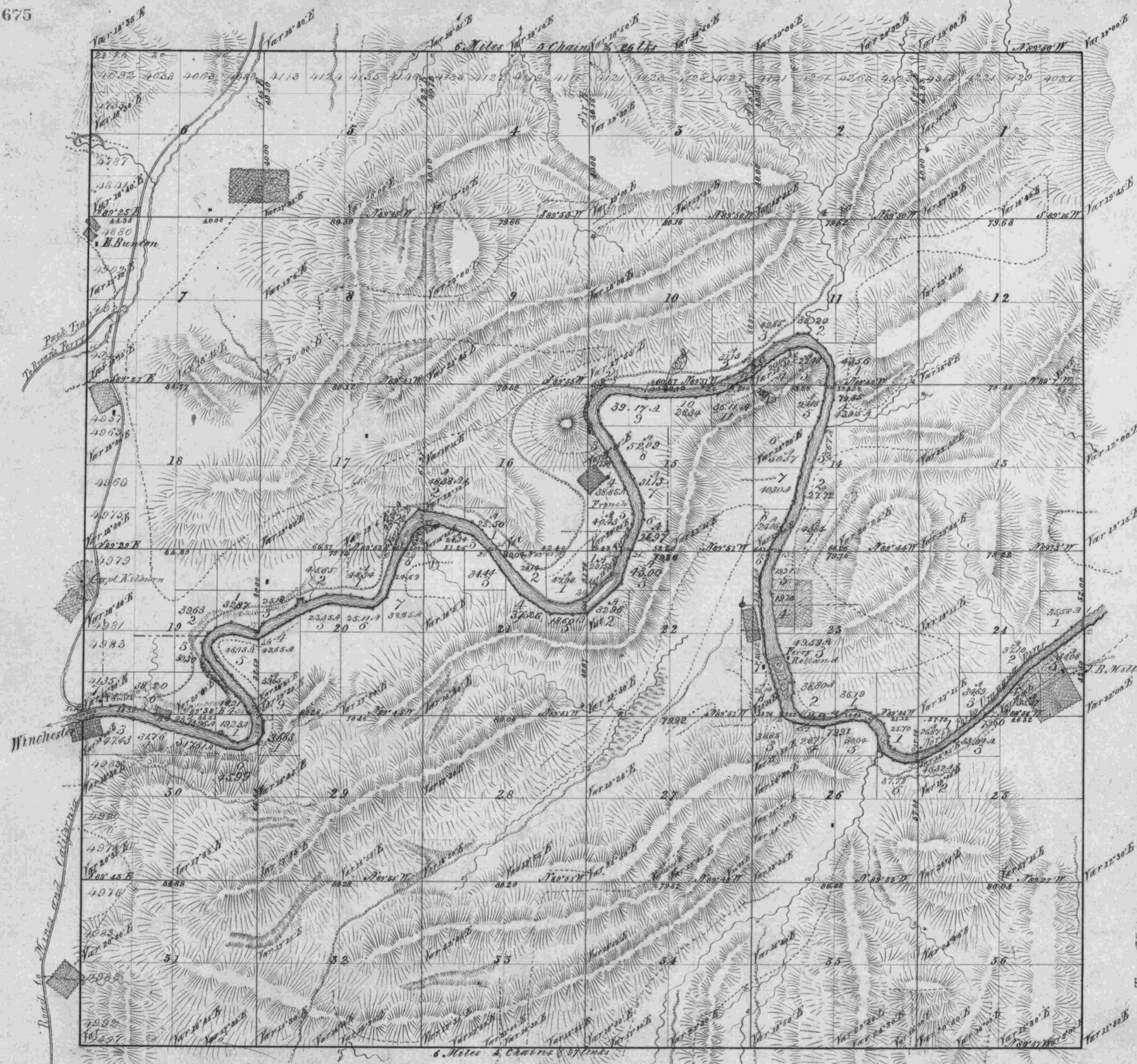

Surveys designated	By whom surveyed	Contract No	Date	Amount of Surveys Miles Chains Links	When surveyed	When charged into Sur' Genl's accounts
Township lines	Elder & Gile	51	April 7 th 1853	1.2 04 97	September 1 st 1853	3 rd Quarter 1853
Subdivisions	Elder & Gile	51	April 7 th 1853	5.9 33 48	September 2 nd 1853	3 rd Quarter 1853
Meanders				2.4 30 69		

The above Map of Township No 26 South of Range No 5 West of the Willamette Meridian Territory of Oregon is strictly conformable to the field notes of the survey thereof on file in this Office which have been examined & approved
 Surveyor General's Office
 Oregon City, Sept. 14th 1853
M. J. Preston
 Sur. Genl.