

TOWNSHIP N° 26 SOUTH, RANGE N° 3 EAST, OF THE WILLAMETTE MERIDIAN, OREGON.

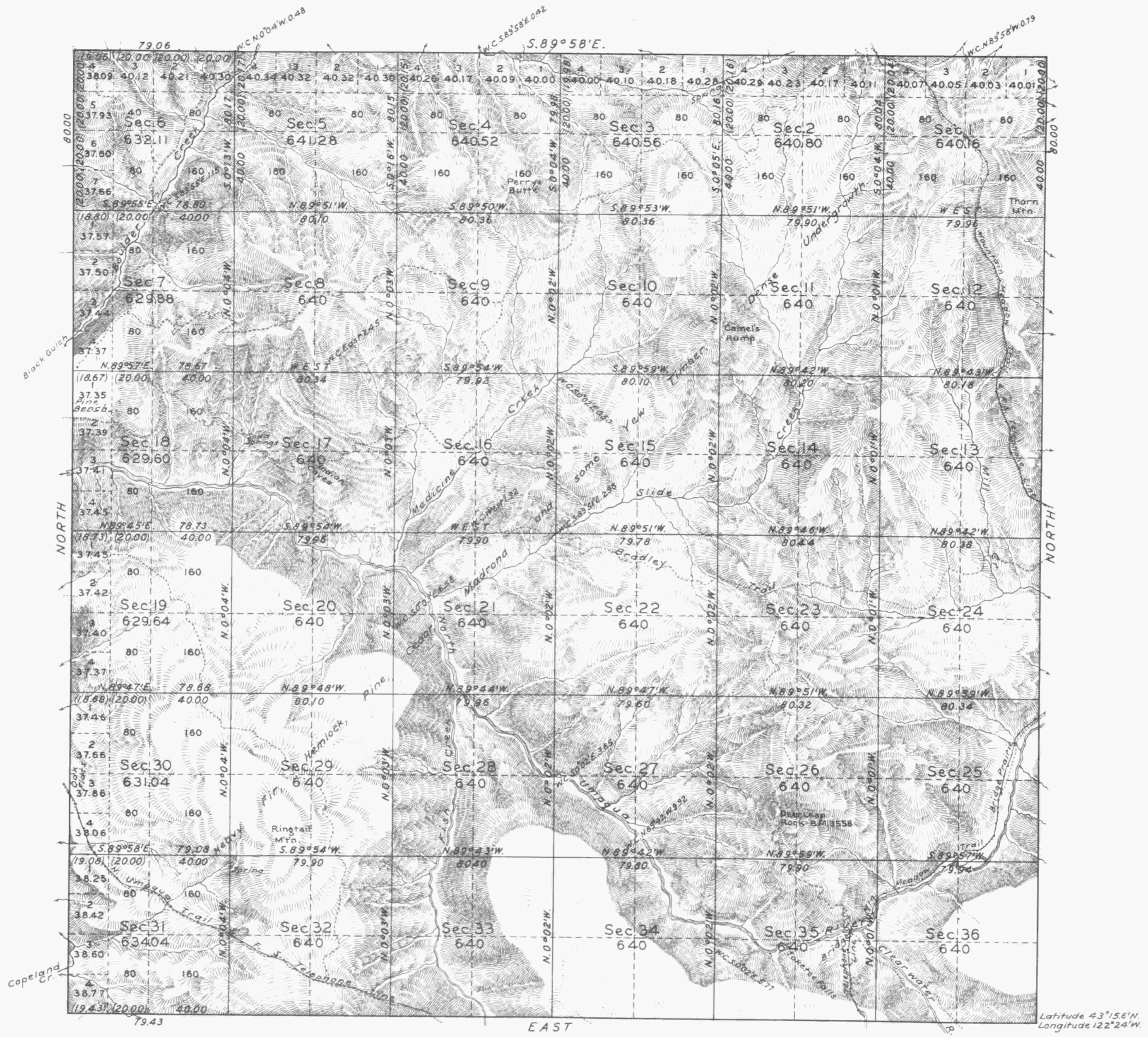

Mean Magnetic Declination $21\frac{1}{2}^{\circ}$ E. Scale: 40 Chains to an Inch Area Surveyed 22,989.63 Acres.

LINES DESIGNATED	BY WHOM SURVEYED	GROUP		MILEAGE		WHEN SURVEYED	
		N°	DATE	MLS.	CHS.	BEGUN	COMPLETED
Exterior	Otto L. Draper	64	Dec. 27, 1920	11	79.06	Aug. 16, 1930	June 11, 1931
Subdivisional				59	76.60	" " "	" " "
Miscellaneous					3.46		

Office of U.S. Supervisor of Surveys,
 Denver, Colorado, Jan. 31, 1933.
 The above plat of Township N° 26 South, Range N° 3 East,
 of the Willamette Meridian, Oregon, is strictly conformable
 to the field notes of the survey thereof which have been
 examined and approved.

Orville Johnson
 U.S. Supervisor of Surveys

DEPARTMENT OF THE INTERIOR
 GENERAL LAND OFFICE
 Washington, D.C., August 12, 1933.
 The survey represented by this plat
 having been correctly executed in accordance
 with the requirements of law and the regulations
 of this office, is hereby accepted.

Antoinette Hunt
 Assistant Commissioner

1933
 70