

Survey accepted March 28, 1919  
G.L.O.

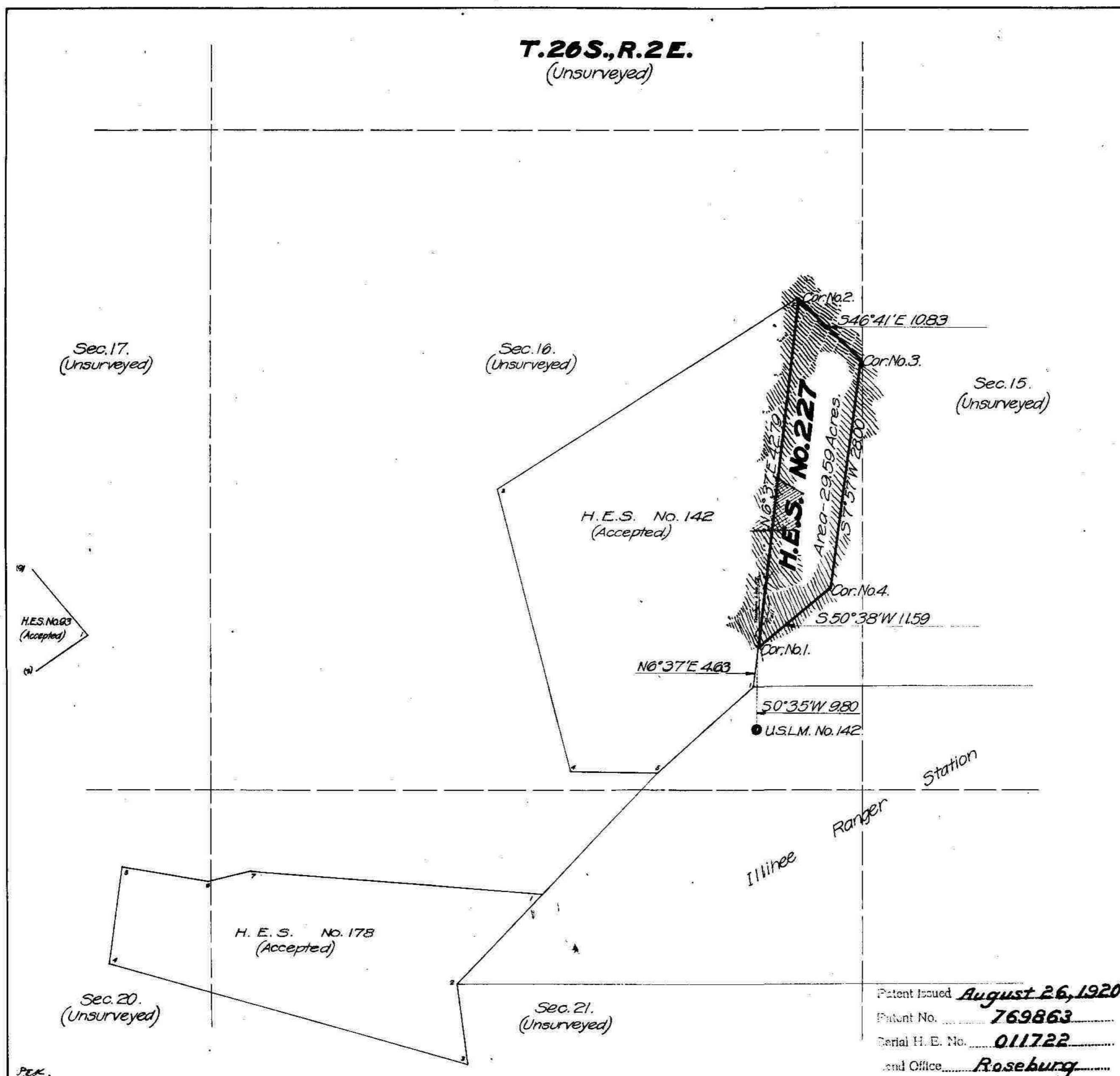

Plat of  
**HOMESTEAD  
ENTRY SURVEY**  
No. **227**  
in the  
**UMPQUA**  
**NATIONAL FOREST**  
in approximate  
Section 16, unsurveyed, T.26S., R.2E.  
of the  
**WILLAMETTE MERIDIAN**  
**OREGON**

This plat of Homestead Entry Survey No. 227 State of OREGON is strictly conformable to the field notes thereof on file in this office, which have been examined and approved.

U.S. Surveyor General's Office  
Portland, Oregon.  
Sept. 30, 1918

*Edward J. Worth*  
U.S. Surveyor General

Patent issued **August 26, 1920**  
Patent No. **769863**  
Serial H. E. No. **011722**  
and Office **Roseburg**

SCALE 10 chains to 1 inch

Surveys Designated	By whom Surveyed	Inst., Cont. Group		When Surveyed		Date of Approval
		No.	Date	Began	Completed	
H.E. Survey No. 227	Geo. W. Root	227	Mar. 14, 1917	Oct. 17, 1917	Oct. 18, 1917	Sept. 30, 1918
	Surveyor-Forest Service					
H.E. Survey No. 178	Frederick W. Rose, Sur. for Ser.	178	Dec. 17, 1915	Aug. 22, 1916	Aug. 24, 1916	May 12, 1917
H.E. Survey No. 93	Frank D. Maxwell.	93	July 7, 1913	July 13, 1914	July 15, 1914	June 30, 1915
	Forest Service Surveyor					
H.E. Survey No. 142	Frank D. Maxwell.	142	Apr. 27, 1914	July 10, 1914	July 11, 1914	June 30, 1915

Areas in Acres	
H.E. Survey No. 227	Conflicts
In Section	
In Section	
In Section	
In Section	
Total	29.59

Act of June 11, 1906	Act of March 7, 1917
List No. 6-3013	Dated June 3, 1918
Latitude 43° 18' N	Observations at
Longitude 122° 34' W	Corner No. 1
Mean Mag. Decl. 19° 30' E	