

*Wignier*

# Corrective Surveys in Township No. 26 South Range No. 1 West of the Willamette Meridian Oregon.

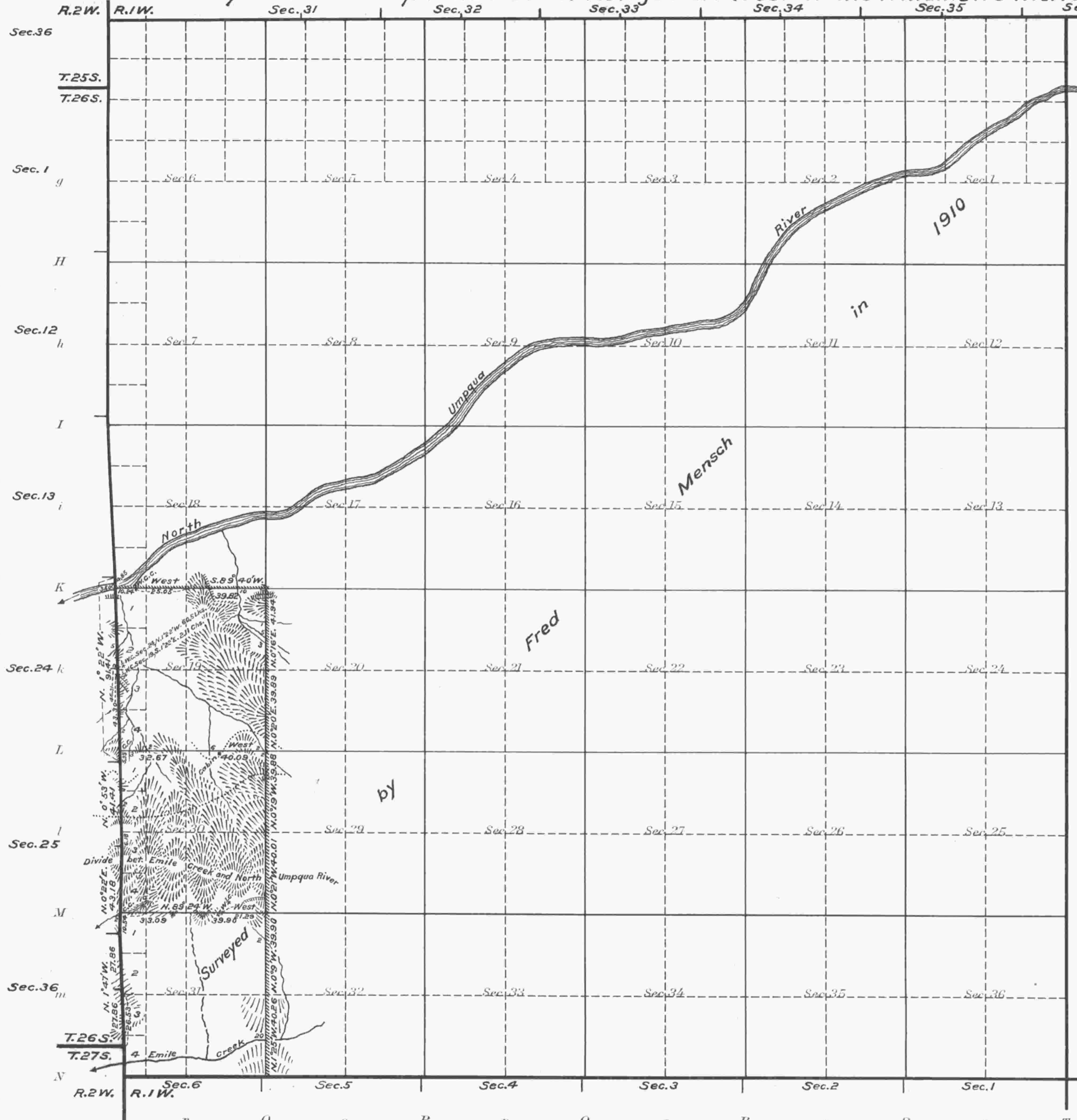

Accepted Jan. 22, 1919  
G. L. O.

**Memorandum:**  
 W The corrective survey represented by this plat was made for the purpose of properly closing the lines between secs. 18-19, 19-30 and 30-31 on E. bdy. of T. 26S., R. 2W., which is now the reconstructed McQuinn line originally established in 1883.  
 v Titles and areas based upon the original plat approved Nov. 11, 1911 remain undisturbed for position and description.

Areas in Acres	
Public Land	
Indian Reservation	
Indian Allotments	
Mineral Claims	
Water Surface	
<b>Total Area</b>	

Scale 40 Chains to an inch

At Cor. of Sec's 31-32 on S. bdy. of Tp. }  
 Mean Magnetic Declination 21° E  
 Latitude 43° 16' N.  
 Longitude 122° 51' W.

Surveys Designated	By Whom Surveyed	Group No.	Date of Instructions	Amount of Surveys			When Surveyed	
				Mls.	chs.	ks.	Began	Completed
Corrective Surveys W. Bdy.	Fred Mensch	16	May 25, 1916	2	71	72	Oct. 7, 1916	Nov. 1, 1916
" " Subdivisions	" "	" "	" " " "	5	62	74	Oct. 24, 1916	Oct. 28, 1916
E. Bdy. Sec's. 24, 25 & 36 T. 26 S. R. 2W Surveyed by John A. McQuinn under Contract 466 in 1883								

The above map of Township No. 26 South Range No. 1 West of the Willamette Meridian Oregon is strictly conformable to the field notes of the survey thereof on file in this office, which have been examined and approved

U. S. Surveyor General's Office.  
 Portland, Oregon, June 21, 1917

*Edward Worth*  
 Surveyor General.