

TOWNSHIP N° 25½ SOUTH, RANGE N° 2 EAST, OF THE WILLAMETTE MERIDIAN, OREGON.

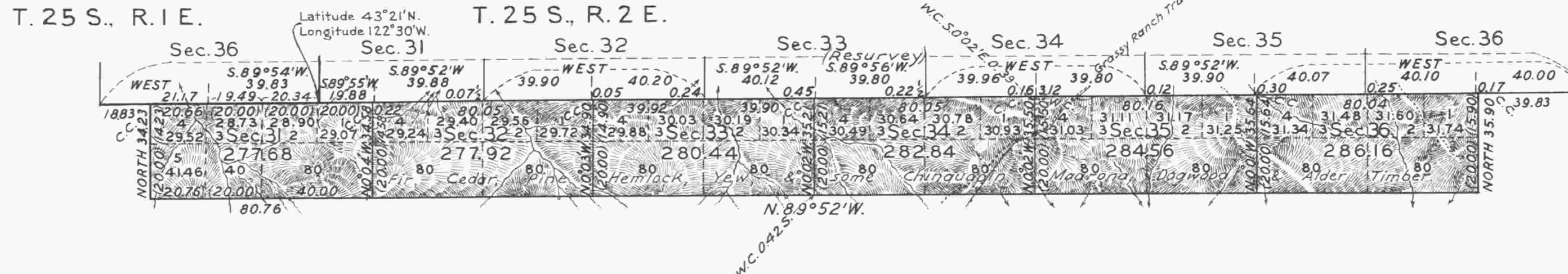

Scale: 40 Chains to an Inch. Area 1689.60 Acres.

LINES DESIGNATED	BY WHOM SURVEYED	GROUP		MILEAGE		WHEN SURVEYED	
		N°	DATE	MLS.	CHS.	BEGUN	COMPLETED
Exterior	Otto L. Draper	74	March 12, 1921	6	55.34	June 11, 1930	Aug 14, 1930
Subdivisional				2	15.83	July 2, "	" 7, "
Miscellaneous					1.35	June 11, "	" " "

Office of U.S. Supervisor of Surveys,
 Denver, Colorado, Sept. 8, 1931.
 The above plot of Township N° 25½ South, Range N° 2 East,
 of the Willamette Meridian, Oregon, is strictly
 conformable to the field notes of the survey thereof
 which have been examined and approved.

Wm. M. Johnson
 U. S. Supervisor of Surveys.

DEPARTMENT OF THE INTERIOR
 GENERAL LAND OFFICE
 Washington, D.C., February 8, 1932
 The survey represented by this plat
 having been correctly executed in accordance
 with the requirements of law and the regulations
 of this office, is hereby accepted.

Thos. C. Havell
 Assistant Commissioner.

P.M.H.
 6
 70