

TOWNSHIP NO 25 SOUTH, RANGE NO 1 EAST OF THE WILLAMETTE MERIDIAN, OREGON.

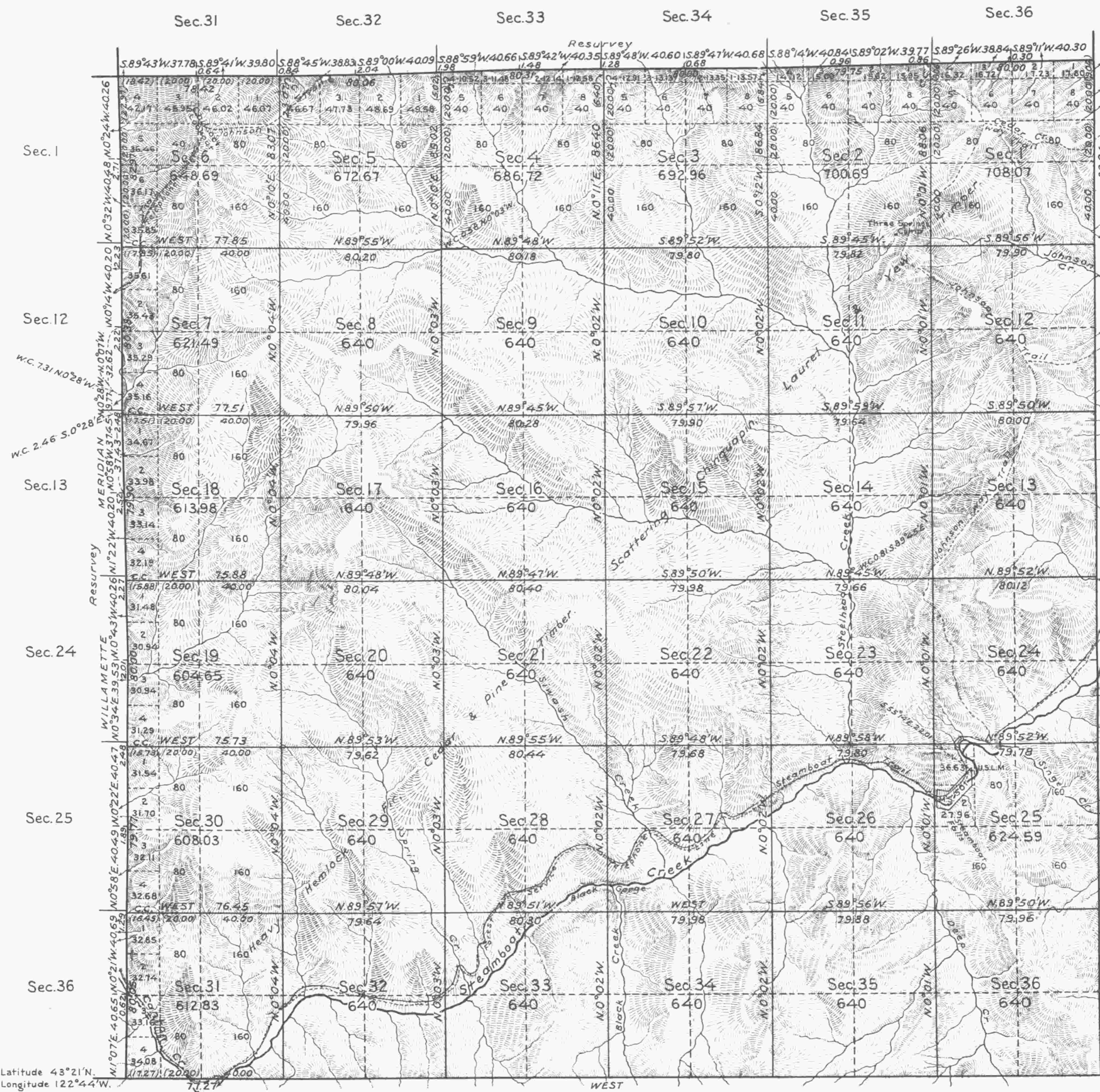

Note
 The surface is covered with a dense growth of vine maple, rhododendron, huckleberry, hazel, chinquapin, arrow-wood, manzanita, alder, willow, salal, and Oregon grape.

MINERAL CLAIM.
 Survey No. 501 OLIVE PLACER.

Mean Magnetic Declination, 20°00'E. Scale 40 Chains to an Inch. Area Surveyed, 23,155.37 Acres.

LINES DESIGNATED	BY WHOM SURVEYED	GROUP NO	DATE	MILEAGE		WHEN SURVEYED	
				MLS	CHS	BEGUN	COMPLETED
Exterior				24	7.92	May 23, 1927	June 29, 1928
Subdivisional	Joseph A. Ganong	74	March 12, 1921	60	11.77	June 18, "	" 28, "
Meander	John G. Collins						
Miscellaneous				56.80	" 21, "	" 27, "	

Office of U.S. Supervisor of Surveys
 Denver, Colorado, April 1, 1929.
 The above plat of Township No. 25 South, Range No. 1 East of the Willamette Meridian, Oregon, is strictly conformable to the field notes of the survey thereof which have been examined and approved.

Samuel D. Dinnon
 U.S. Supervisor of Surveys.

DEPARTMENT OF THE INTERIOR
 GENERAL LAND OFFICE
 Washington, D. C., July 12, 1929.
 The survey represented by this plat having been correctly executed in accordance with the requirements of law and the regulations of this office, is hereby accepted.

Wm. C. Howell
 Assistant Commissioner.