

Township No. 21 South Range No. 9 West Willamette Meridian, Oregon.

1265

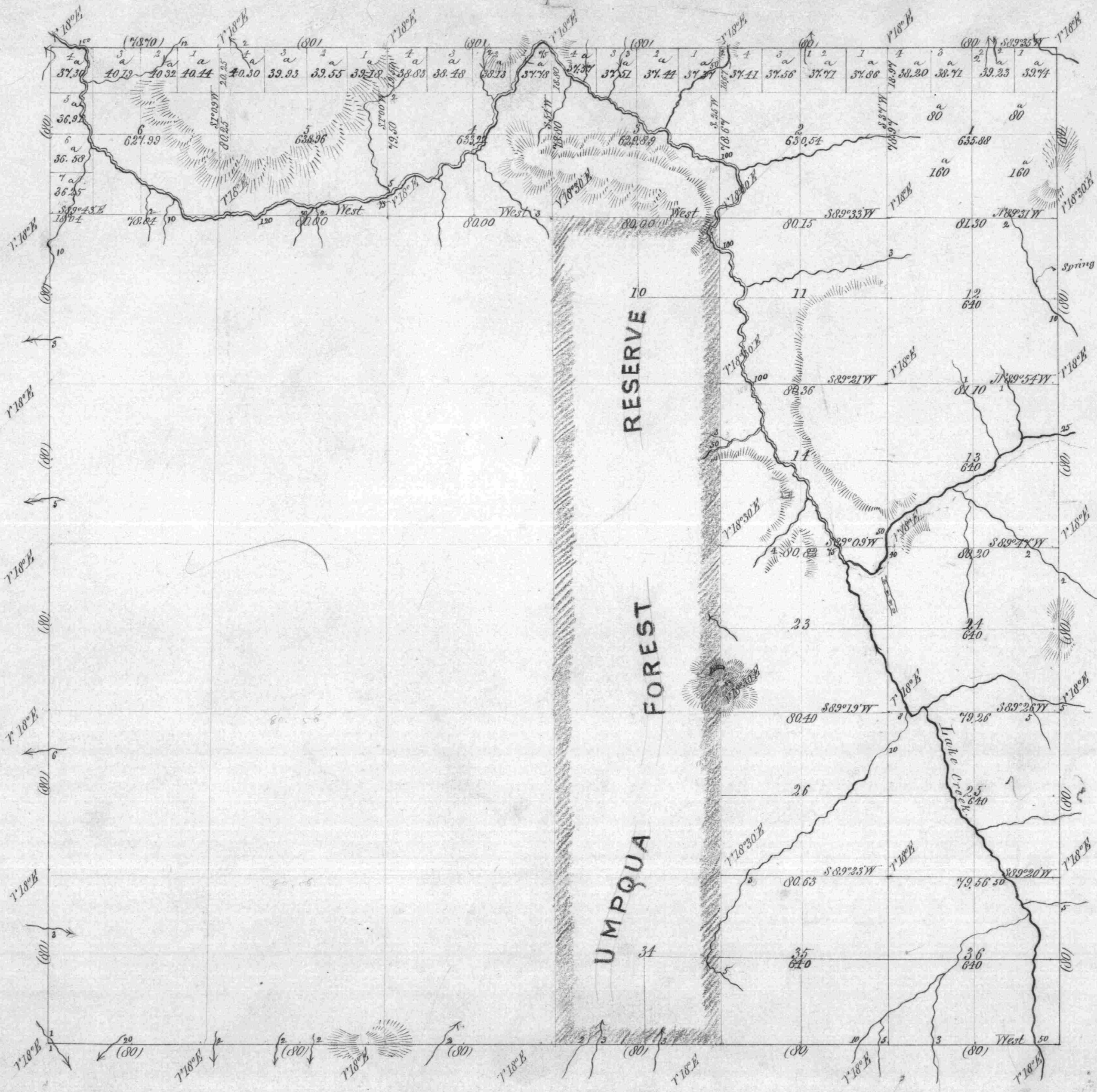

*General Description*  
 The lands along the Creek are 1<sup>st</sup> class covered, generally, with live Maple and other timber. These lands, when cleared, will be very valuable for Agricultural purposes. The hills are generally covered with Fir and its undergrowth.

Total Acres 10516.18

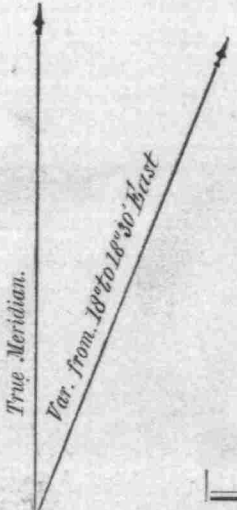

Scale 40 Chains to an inch.

Lines.	Contractor.	Contract.		Amount Surveyed.			Commenced.	Completed.
		No.	Date.	Miles.	Chains.	Links.		
Subdivisions	W <sup>m</sup> H. Byar's	222	Aug 7 1878	28	78	01	Sept 16 1878	May 9 1879
Exteriors	do. do. do	do.	do.					

The above Map of the subdivisional lines of Township No. 21 South Range No. 9 West Willamette Meridian, Oregon, is strictly conformable to the original field notes of the survey thereof on file in this office, which have been examined and approved.  
 U. S. Surveyor General's Office,  
 Portland, Oregon,  
 July 26 1879  
 James C. Tolman  
 Surveyor General of Oregon.