

TOWNSHIP NO 24 SOUTH, RANGE NO 2 EAST OF THE WILLAMETTE MERIDIAN, OREGON.

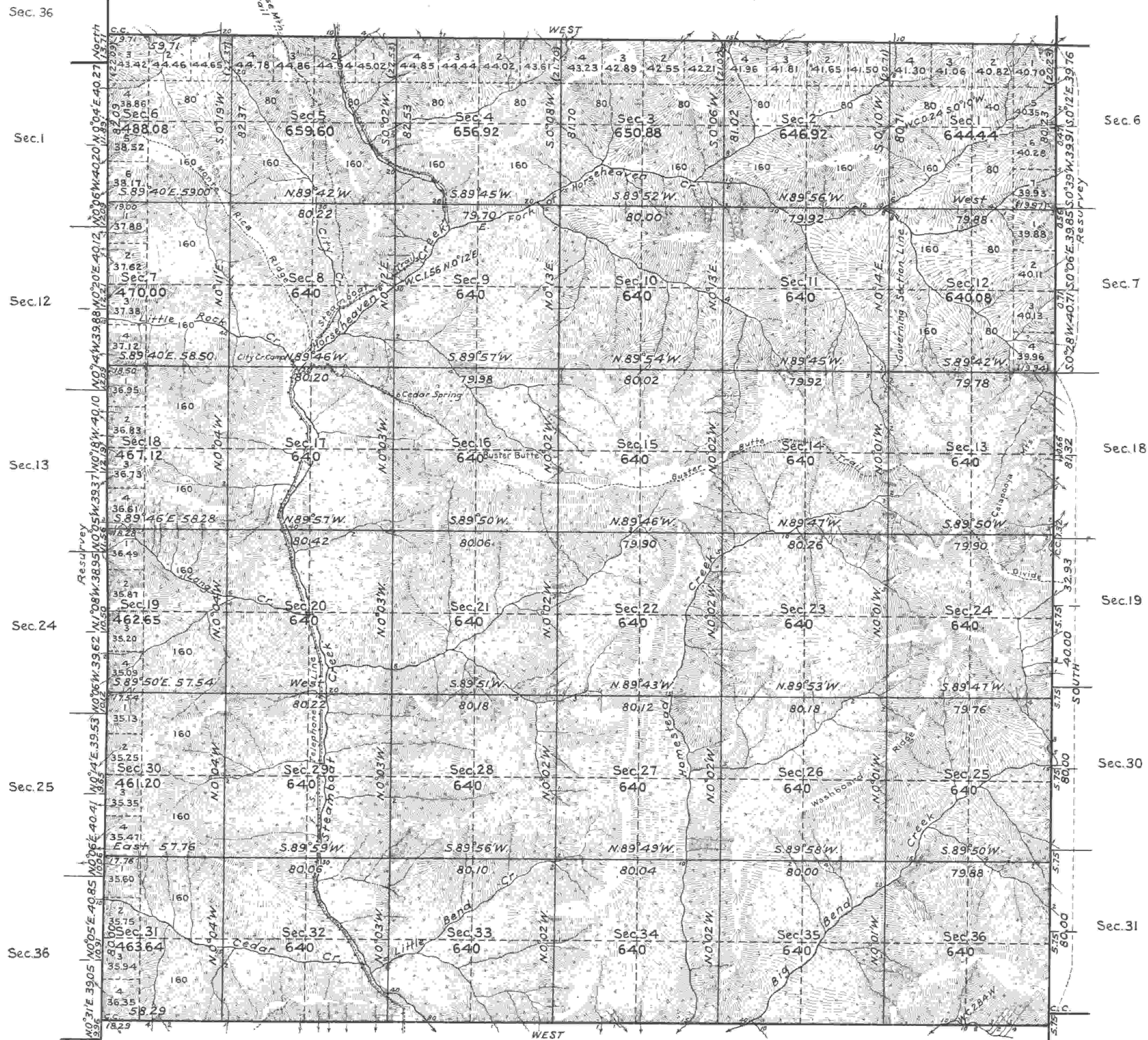

Lat. 43°25'N. Long. 122°36'W. At camp 20 chs SW. of 1/4 Sec. Cor. bet. Secs. 32 & 33, T. 24 S., R. 2 E.

Mean Magnetic Declination, 20°00'E. Scale 40 Chains to an Inch Area Surveyed, 22,071.53 Acres

LINES DESIGNATED BY WHOM SURVEYED	NO	GROUP DATE	MILEAGE		WHEN SURVEYED		
			MLS	CHS	BEGUN	COMPLETED	
Exterior	John G. Collins U.S.C.E.	73	March 12, 1921.	17	70.58	May 25, 1926	Sept. 24, 1926
Subdivisional				58	60.11	July 10, "	Aug 14, 1927
Meander							
Miscellaneous				9.96		Aug. 28, "	" 28, 1926

Office of U.S. Supervisor of Surveys
 Denver, Colorado, Dec. 6, 1927.
 The above plat of Township No. 24 South, Range No. 2 East of the Willamette Meridian, Oregon, is strictly conformable to the field notes of the survey thereof which have been examined and approved.

Samuel Johnson
 U.S. Supervisor of Surveys.

Sec. 6
 DEPARTMENT OF THE INTERIOR
 GENERAL LAND OFFICE

Washington, D.C., January 28, 1928.
 The survey represented by this plat having been correctly executed in accordance with the requirements of law and the regulations of this office, is hereby accepted

Oliver C. Howell
 Assistant Commissioner

2511
 30