

TOWNSHIP 24 SOUTH, RANGE 2 WEST, OF THE WILLAMETTE MERIDIAN, OREGON.  
DEPENDENT RESURVEY

This plat represents a retracement and reestablishment of a portion of the east boundary, T. 24 S., R. 2 W., Willamette Meridian, Oregon, designed to restore the corners in their true original locations according to the best available evidence.

The east boundary of the township was surveyed by John A. McQuinn in 1883.

In 1896, Winfield S. Chapman and Carl S. Nicklin retraced the east boundary of the township and surveyed the subdivisional lines of T. 24 S., R. 1 W., closing against the McQuinn line.

Levi E. Tallett dependently resurveyed the east boundary of section 36 in 1951.

The resurvey was executed by Lynn M. Roseberry, Cadastral Surveyor, May 16 to 24, 1967, under Special Instructions dated April 12, 1967, which provide for the surveys included under Group No. 634, Oregon.

Sec. 24

T. 24 S., R. 1 W.

Sec. 19

Sec. 25

Sec. 30

Sec. 36

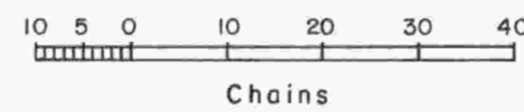
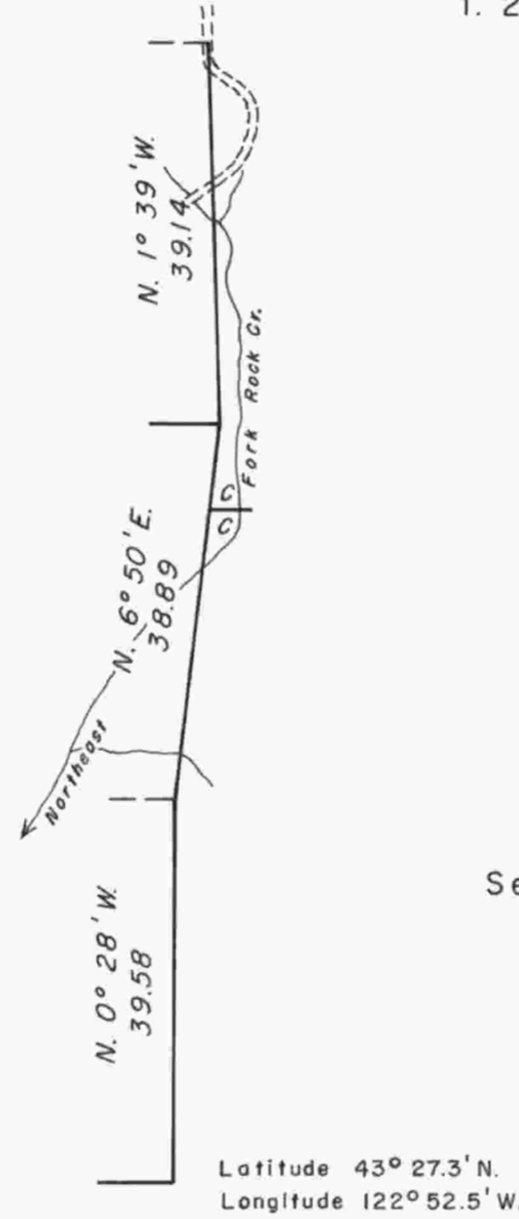
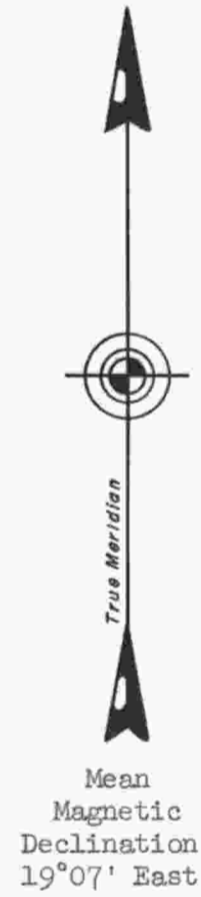

Timber in this area consists of Douglas fir, hemlock, cedar, yew, madrone, dogwood, and sugar pine.

UNITED STATES DEPARTMENT OF THE INTERIOR  
BUREAU OF LAND MANAGEMENT  
Washington, D. C. January 19, 1970

This plat is strictly conformable to the approved field notes, and the survey, having been correctly executed in accordance with the requirements of law and the regulations of this Bureau, is hereby accepted.

For the Director

*Lynn M. Roseberry*  
Acting Chief, Division of Cadastral Survey